

7. If the tractor is equipped with a foldable ROPS it may be temporarily folded down only when absolutely necessary for areas with height constraints. (There is no operator protection provided by the ROPS in the folded position. For operator safety the ROPS should be placed in the upright and locked position and the seat belt fastened for all other operations.)
8. Always use the seat belt if the tractor has a CAB or ROPS.
Do not use the seat belt if a foldable ROPS is down or there is no ROPS. Check the seat belt regularly and replace if frayed or damaged.

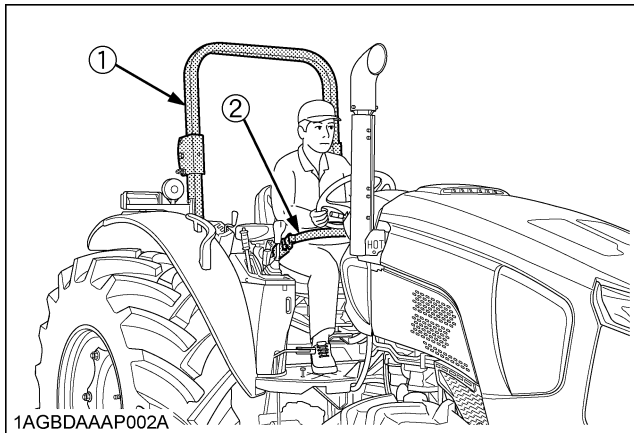

(1) ROPS
(2) Seat belt

2. OPERATING THE TRACTOR

Operator safety is a priority. Safe operation, specifically with respect to overturning hazards, entails understanding the equipment and environmental conditions at the time of use. Some prohibited uses which can affect overturning hazards include traveling and turning with implements and loads carried too high etc. This manual sets forth some of the obvious risks, but the list is not, and cannot be, exhaustive. It is the operator's responsibility to be alert for any equipment or environmental condition that could compromise safe operation.

◆ Starting

1. Always sit in the operator's seat when starting engine or operating levers or controls. Adjust seat per instructions in the operating the tractor section. Never start engine while standing on the ground.
2. Before starting the engine, make sure that all levers (including auxiliary control levers) are in their neutral positions, that the parking brake is engaged, and that both the clutch and the Power Take-Off (PTO) are disengaged or "OFF".
Fasten the seat belt if the tractor has a CAB, a fixed ROPS or a foldable ROPS in the upright and locked position.

3. Do not start engine by shorting across starter terminals or bypassing the safety start switch. Machine may start in gear and move if normal starting circuitry is bypassed.
4. Do not operate or idle engine in a non-ventilated area. Carbon monoxide gas is colorless, odorless, and deadly.
5. Check before each use that operator presence controls are functioning correctly. Test safety systems. (See "Checking Engine Start System" in "EVERY 50 HOURS" in "PERIODIC SERVICE" section.)
Do not operate unless they are functioning correctly.

◆ Working

1. Pull only from the drawbar. Never hitch to axle housing or any other point except drawbar; such arrangements will increase the risk of serious personal injury or death due to a tractor upset.

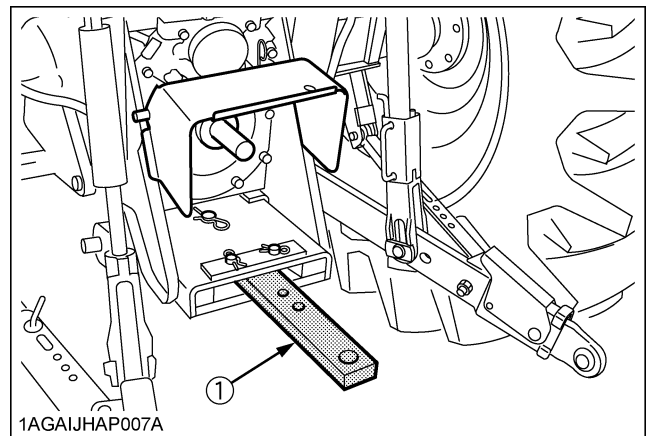

(1) Drawbar

2. For trailing PTO-driven implements, set the drawbar to the towing position.
3. Attach pulled or towed loads to the drawbar only.
4. Keep all shields and guards in place. Replace any that are missing or damaged.
5. Avoid sudden starts. To avoid upsets, slow down when turning, on uneven ground, and before stopping.
6. The tractor cannot turn with the differential locked and attempting to do so could be dangerous.
7. Do not operate near ditches, holes, embankments, or other ground surface features which may collapse under the tractor's weight. The risk of tractor upset is even higher when the ground is loose or wet. Tall grass can hide obstacles, walk the area first to be sure.
8. Watch where you are going at all times. Watch for and avoid obstacles. Be alert at row ends, near trees, and other obstructions.
9. When working in groups, always let the others know what you are going to do before you do it.
10. Never try to get on or off a moving tractor.
11. Always sit in the operator's seat when operating levers or controls.

7. DANGER, WARNING AND CAUTION LABELS

(1) Part No. TC660-4997-1

▲ WARNING

TO AVOID PERSONAL INJURY OR DEATH:

1. Read and understand the operator's manual before operation.
2. Before starting the engine, make sure that everyone is at a safe distance from the tractor and that the PTO is OFF.
3. Do not allow passengers on the tractor at any time.
4. Before allowing other people to use the tractor, have them read the operator's manual.
5. Check the tightness of all nuts and bolts regularly.
6. Keep all shields in place and stay away from all moving parts.
7. Lock the two brake pedals together before driving on the road.
8. Slow down for turns, or rough roads, or when applying individual brakes.
9. On public roads use SMV emblem and hazard lights, if required by local traffic and safety regulations.
10. Pull only from the drawbar.
11. Before dismounting, lower the implement to the ground, set the parking brake, stop the engine and remove the key.
12. Securely support tractor and implements before working underneath.

1AGAHAKAP046A

(3) Part No. 3F240-9857-1

▲ WARNING

To avoid free wheeling when shifting the shuttle lever while on a slope: Stop completely by using the brake and by depressing the clutch pedal. Start off after selecting shuttle direction by releasing the clutch pedal.

1AGAIBDAP039A

(2) Part No. 3A111-9848-2

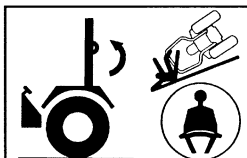
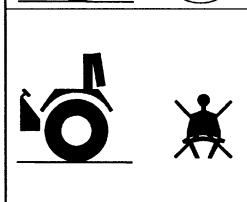
	<p>▲ WARNING</p> <p>TO AVOID INJURY OR DEATH FROM ROLL-OVER:</p> <ul style="list-style-type: none"> • Keep Roll-Over Protective Structures (ROPS) in the upright and locked position. • Fasten SEAT BELT before operating.
	<p>THERE IS NO OPERATOR PROTECTION WHEN THE ROPS IS IN THE FOLDED POSITION.</p> <ul style="list-style-type: none"> • Check the operating area and fold the ROPS only when absolutely necessary. • Do not wear SEAT BELT if ROPS is folded. • Raise and lock ROPS as soon as vertical clearance allows. • Read ROPS related instructions and warnings.

1AGAIDCAP066E

(4) Part No. 6C150-4743-1

▲ WARNING

BEFORE DISMOUNTING TRACTOR:

1. ALWAYS SET PARKING BRAKE.
2. PARK ON LEVEL GROUND WHENEVER POSSIBLE.
3. LOWER ALL IMPLEMENTS TO THE GROUND.
4. STOP THE ENGINE.

1AGAIBDAP040E

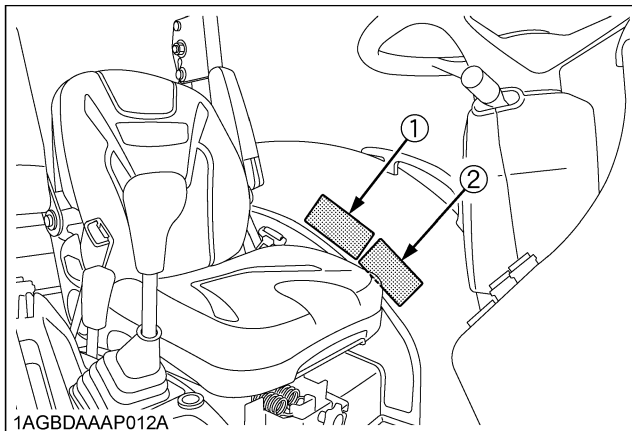

1AGBDAAAP012A

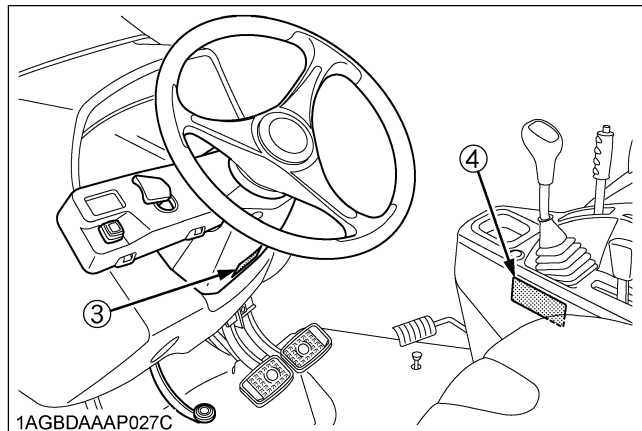

1AGBDAAAP027C

1AGBDAAAP017A

SPECIFICATIONS

SPECIFICATION TABLE

Model			M5-091		M5-111		
			2WD	4WD	2WD	4WD	
Engine	Model		V3800-TIEF4				
	Type		Direct Injection, Water-cooled 4 Cycle Diesel, Common Rail System, Turbocharger, Intercooler				
	Number of cylinders		4				
	Total displacement	cm³ (cu.in.)	3769 (230)				
	Bore and stroke	mm (in.)	100 x 120 (3.9 x 4.7)				
	Rated revolution	rpm	2400				
	Low idling revolution	rpm	800 to 850				
	Rated Engine HP (97/68/EC)	kW (HP)	69.0 (92.5)		78.8 (105.6)		
	Net power *1	kW (HP)	63.8 (85.5)		74.6 (100)		
	PTO power *1 (factory observed)	kW (HP)	56.7 (76)		66.4 (89)		
	Maximum torque	N-m (ft-lbs) / rpm	325 (240) / 1500		357 (263) / 1500		
	Battery capacity		12V, RC: 160 min, CCA 900A				
	Fuel tank capacity	L (U.S.gals.)	105 (27.7)				
	Engine oil capacity	L (U.S.qts.)	10.7 (11.3)				
	Coolant capacity	L (U.S.qts.)	10.0 (11)				
	DEF/AdBlue® capacity	L (U.S.gals.)	12.3 (3.2)				
Dimensions	Overall length		mm (in.)	3975 (156.5)	3960 (156)	3975 (156.5)	3960 (156)
	Overall width (minimum tread)		mm (in.)	1960 (77)	1990 (78)	1990 (78)	2010 (79)
	Overall height		mm (in.)	2510 (99) (ROPS)		2535 (100) (ROPS)	
	Wheel base		mm (in.)	2285 (90)	2250 (88.6)	2285 (90)	2250 (88.6)
	Tread	Front	mm (in.)	1440 to 2040 (56.7 to 80.3)	1580 (62.2)	1440 to 2040 (56.7 to 80.3)	1580 (62.2)
		Rear	mm (in.)	1520 to 1920 (59.8 to 75.6)			
	Minimum ground clearance		mm (in.)	425 (16.7) (Drawbar bracket)		450 (17.7) (Drawbar bracket)	
Weight			kg (lbs.)	2600 (5732)	2790 (6151)	2660 (5865)	2850 (6283)

■ Operating Procedure for Auto Regeneration Mode

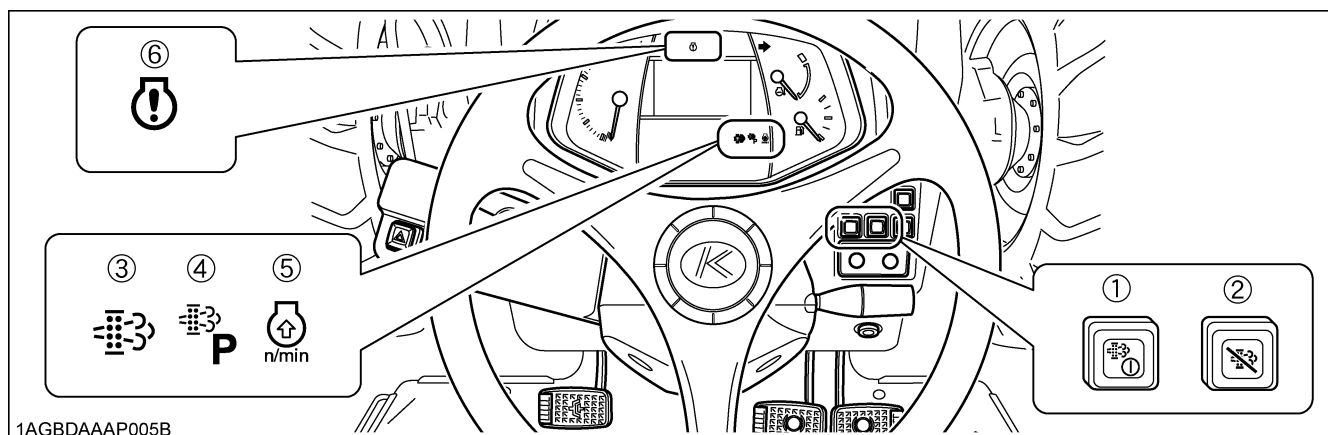

1AGBDAAAP005B

(1) Parked regeneration switch
(2) DPF INHIBIT switch

(3) Regeneration indicator
(4) Parked regeneration indicator

(5) Engine RPM increase indicator
(6) Engine warning indicator

◆ Regeneration Operating Procedure

1. Start the engine.
(Make sure that the DPF INHIBIT switch lamp  is "OFF".)

Switch lamp OFF: Auto Regeneration Mode activated.

Switch lamp ON: Regeneration Inhibit Mode activated.

NOTE :

- When the engine is started, the "Auto Regeneration" mode is automatically activated.
- "Regeneration Inhibit" mode is activated, when the DPF INHIBIT switch is pushed after the engine is started.

2. When the regeneration indicator  starts flashing:

A specific amount of PM has built up in the DPF.

Continue to operate the tractor, and the regeneration process will begin automatically, make sure the working place is in a safe area as DPF and exhaust temperature will rise.

3. When the engine rpm increase indicator  starts flashing:

Keep on working and increase the engine rpm until the indicator turns "OFF".

NOTE :

- Even if the Auto Regeneration Mode is selected, DPF regeneration may not begin because system requirements have not been satisfied.
- The engine rpm increase indicator is used as a guide to satisfy the regeneration conditions. If the engine load is too heavy, the engine rpm increase indicator may continue to flash, even though regeneration system conditions are satisfied and regeneration may begin automatically. (See the "Tips on Diesel Particulate Filter [DPF] Regeneration")

6. Insert the key into the key switch and turn it "ON".

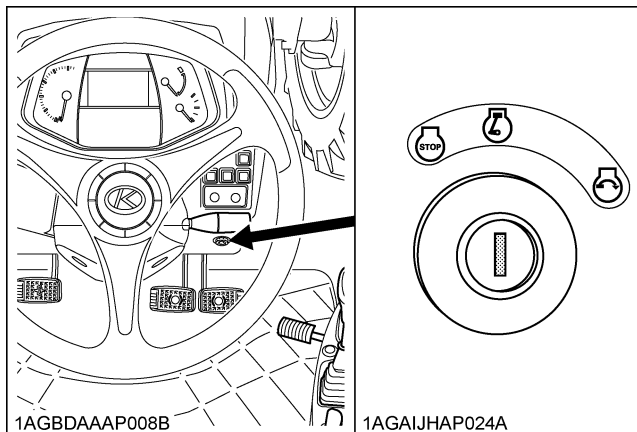

1AGBDAAAP008B

1AGAIJHAP024A

"OFF"

"ON"

"START"

◆ Check Easy Checker(TM) Indicators:

- When the key is turned "ON", indicators (1) (2) should come on. If trouble should occur at any location while the engine is running, the indicator corresponding to problem will turn "ON".
- Suppose that the engine coolant temperature is not high enough yet. The heater indicator (7) also turns "ON" when the key is turned "ON" to preheat the engine and goes off automatically when preheat is completed.
Illumination time of indicator varies according to the temperature of coolant.
- The PTO clutch indicator (3) comes on while PTO clutch control switch is engaged "ON" and goes off when disengaged.
- If the fuel level indicator (8) lights up, when fuel level is very low, therefore add fuel and the indicator will turn "OFF".
- If the DEF/AdBlue® warning indicator (4) lights up, check to see icon on LCD. (See "Warning Indication and its Countermeasure" in "SELECTIVE CATALYTIC REDUCTION (SCR) MUFFLER" in "OPERATING THE ENGINE" section.)
- If the Water separator indicator (6) lights up, when water in the Water separator is very high, therefore drain the water and the indicator will turn "OFF".
- If the parking brake warning indicator (5) does not illuminate, set the parking brake.

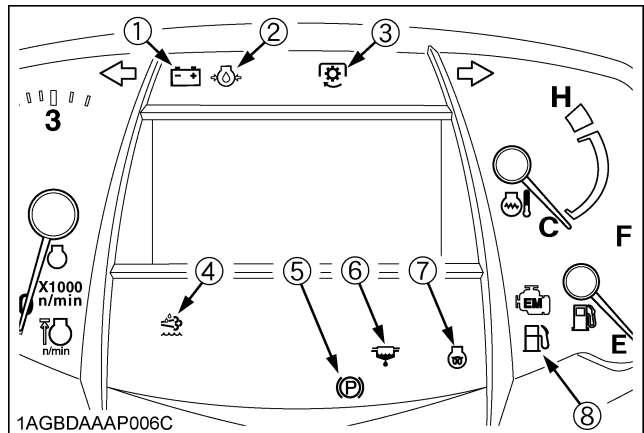

1AGBDAAAP006C

- | | |
|---|-------------------------------------|
| (1) Electrical charge warning indicator | (5) Parking brake warning indicator |
| (2) Engine oil pressure warning indicator | (6) Water separator indicator |
| (3) PTO clutch indicator | (7) Heater indicator |
| (4) DEF/AdBlue® warning indicator | (8) Fuel level indicator |

NOTE :

- Some of the Easy Checker(TM) indicators may illuminate or start flashing depending on the positions of the levers and switches.

IMPORTANT :

- Daily checks with the Easy Checker(TM) only, are not sufficient. Never fail to conduct daily checks carefully by referring to Daily Check. (See "DAILY CHECK" in "PERIODIC SERVICE" section.)

7. Fully depress the clutch pedal.

8. Turn the key to "START" position and release when the engine starts.

IMPORTANT :

- Because of the safety devices, the engine will not start except when the PTO clutch control switch is placed in the "OFF" position and shuttle shift lever is placed in the "NEUTRAL" position.

9. Check to see that all the indicators on the Easy Checker(TM) are "OFF".

If an indicator is still on, immediately stop the engine and determine the cause.

10. Release the clutch pedal.

7. Accelerate the Engine.

■ Hand Throttle Lever

Pulling the throttle lever back decreases engine speed, and pushing it forward increases engine speed.

■ Foot Throttle

Use the foot throttle when traveling on the road. Press down on it for higher speed. The foot throttle is interlocked with the hand throttle lever; when using the foot throttle, keep the hand throttle lever in low idling position.

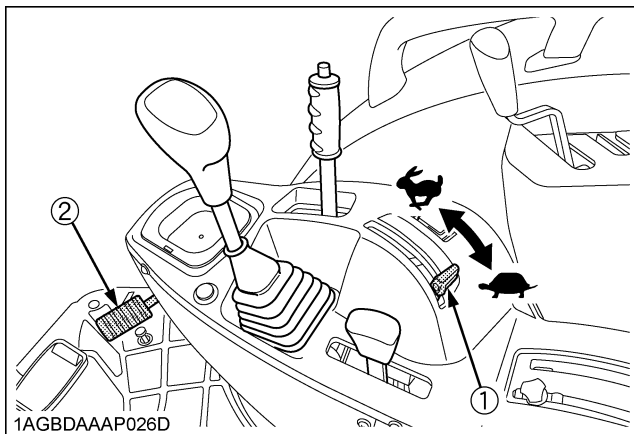

(1) Hand throttle lever 🐰 "INCREASE"
(2) Foot throttle 🐢 "DECREASE"

8. Unlock the Brake Pedals and Slowly Release the Clutch.

STOPPING

■ Stopping

1. Slow down the engine.
2. Step on the clutch and brake pedal.
3. After the tractor has stopped, disengage the PTO, lower the implement to the ground, shift the transmission to neutral, release the clutch pedal, and set the parking brake.

CHECK DURING DRIVING

■ Immediately Stop the Engine if:

- The engine suddenly slows down or accelerates,
- Unusual noises are suddenly heard,
- Exhaust fumes suddenly become very dark,

■ Easy Checker(TM)

If the warning lamps in the Easy Checker(TM) come on during operation, immediately stop the engine, and find the cause as shown below.

Never operate the tractor while Easy Checker(TM) lamp is on.

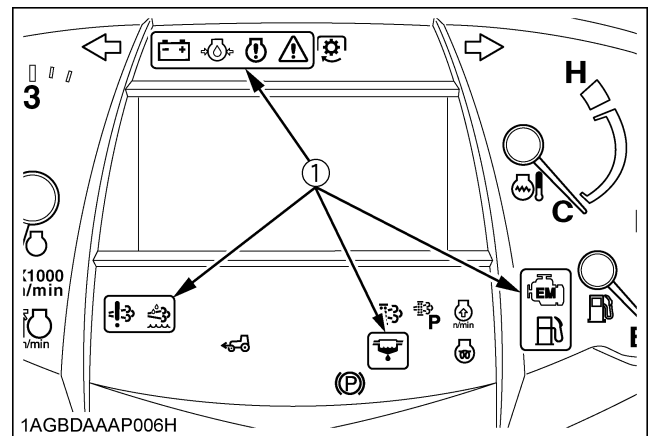

(1) Easy Checker(TM)



Engine warning

This indicator serves the following two functions. If the indicator lights up, pinpoint the cause and take a proper measure.

1. Error with the engine control system
If during operation the water temperature gauge reads an acceptable level but the warning lamp in the Easy Checker(TM) comes on, stop the engine and get it restarted. If the error happens again, consult your local KUBOTA Dealer.

IMPORTANT :

- If the warning indicator lights up, the following phenomena may appear depending on the engine's trouble spot.
 - The engine stops unexpectedly.
 - The engine fails to start or gets interrupted just after start.
 - The engine output is not enough.
 - The engine output is enough, but the warning indicator stays on.

If the engine output is not enough, immediately interrupt the operation and move the tractor to a safe place and stop the engine.

■PTO Gear Shift Lever

[if equipped]



WARNING

To avoid personal injury or death:

- Be sure to observe the PTO shaft speed prescribed for the individual implements. It is extremely dangerous to run an implement at high speed that is meant to be operated at low speed. Use only when this higher rpm is specifically recommended by the implement manufacturer.

The PTO gear shift lever can be set to either 540 rpm or 540E rpm positions.

Move this lever to either position with the PTO clutch control switch set to "OFF".

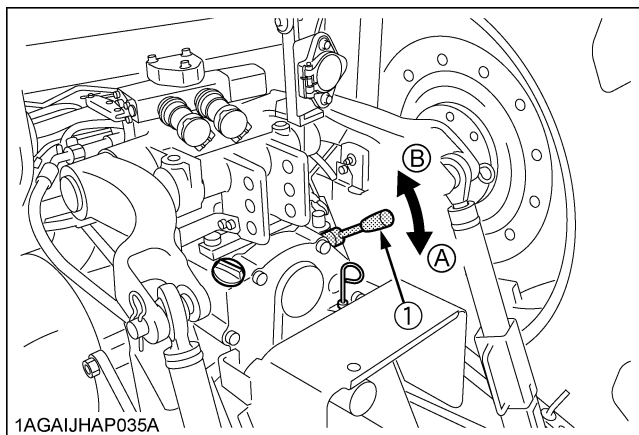

(1) PTO gear shift lever

(A) 540 rpm

(B) 540E rpm

NOTE :

- When light load, select the "540E" position for economical operation.

PTO gear shift lever	Engine speed rpm	PTO speed rpm
540	2035	540
540E	1519	540

■PTO Speed Limiter

NOTE :

- Move the PTO gear shift lever (if equipped) to "540E" and then turn on the PTO clutch control switch, and the rev-limiter indicator lights up on the meter panel.
- If the PTO clutch control switch is turned on with the engine rpm higher than the PTO 540E limit level, the PTO clutch indicator on the meter panel starts blinking and the PTO is disabled. After a while, the engine rpm automatically drops below the PTO 540E limit level and the PTO starts functioning. At the same time, the flashing PTO clutch indicator stays "ON".
- If the PTO clutch control switch is turned "OFF" but the engine rpm fails to rise with the throttle, return the engine rpm to a lower level. This enables acceleration again.

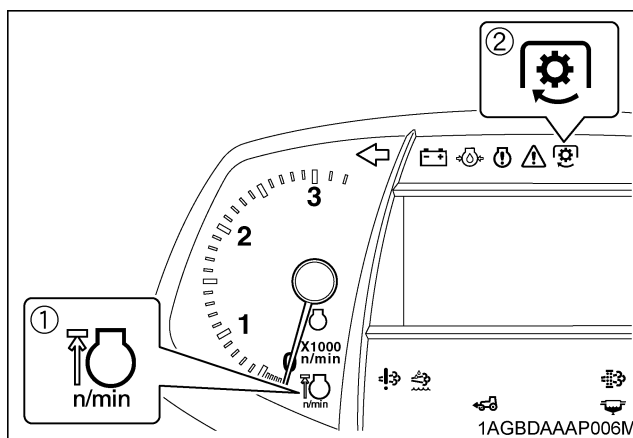

(1) Rev-limiter indicator

(2) PTO clutch indicator

PTO	Limitation PTO / Engine speed (rpm)
540E	630 / 1772

■Mixed Control

In draft control, when draft decreases, the implement automatically lowers to increase draft. However, the implement sometimes lowers too much. To limit the degree, the implement can be lowered, set the position control lever at the lowest working depth desired for the implement. Lower the draft control lever to the point where the implement is at the desired depth.

This stops the implement from going too deep and causing loss of traction and ground speed.

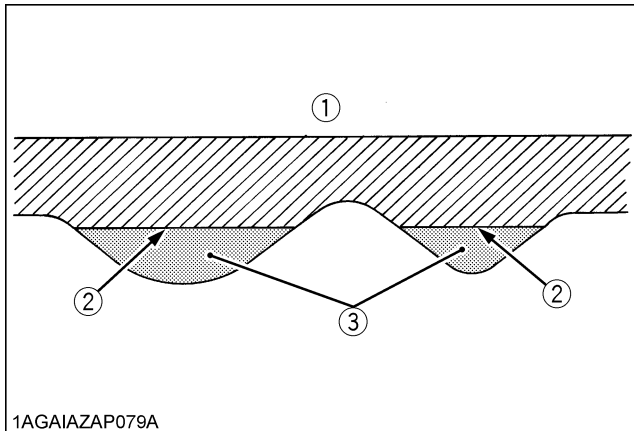

1AGAIAP079A

- (1) Ground surface
(2) Implement penetration limit
(3) Light soil

■Float Control

Place both the draft control lever and the position control lever in the float position to make the lower links move freely along with the ground conditions.

■3-point Hitch Lowering Speed



WARNING

To avoid personal injury or death:

- Fast lowering speed may cause damage or injury. Lowering speed of implement should be adjusted to 2 or more seconds.

The lowering speed of the 3-point hitch can be controlled by adjusting the 3-point hitch lowering speed knob.

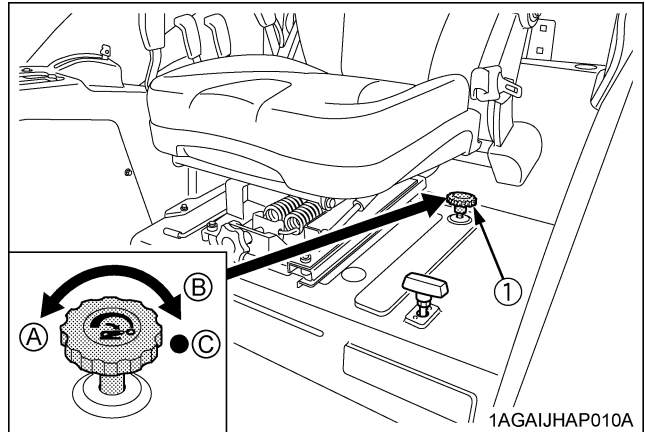

(1) 3-point hitch lowering speed knob

- (A) "FAST"
(B) "SLOW"
(C) "LOCK"

REMOTE HYDRAULIC CONTROL SYSTEM

The hydraulic auxiliary control valves can be installed up to triple segments.

■Remote Control Valve

There are 2 types of remote valves available for these models.

- Double acting valve with detents and self cancelling:
This valve may be placed in the detent mode. The lever will stay in this position until the pressure reaches a predetermined level or a cylinder reaches the end of its stroke. Then it will automatically return to neutral.
- Double acting valve with float position:
This valve may be placed in the float mode with the control lever all the way forward. The cylinder is free to extend or retract, letting an implement such as a loader bucket follow the ground.

**WARNING**

To avoid personal injury or death:

- Before jacking up the tractor, park it on a firm and level ground and chock the front wheels.
- Fix the front axle to keep it from swinging.
- Select a jack that withstands the machine weight and set it up as shown below.

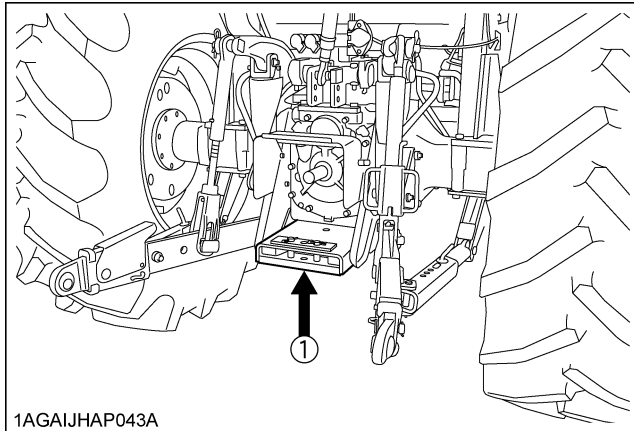

1AGAIJHAP043A

(1) Jack point

BALLAST**WARNING**

To avoid personal injury or death:

- Additional ballast will be needed for transporting heavy implements. When the implement is raised, drive slowly over rough ground, regardless of how much ballast is used.
- Do not fill the front wheels with liquid to maintain steering control.

Front Ballast

Add weights if needed for stability (2WD, 4WD models) and improve traction (4WD model). Heavy pulling and heavy rear mounted implements tend to lift front wheels. Add enough ballast to maintain steering control and prevent tip over. Remove weight when no longer needed.

Front End Weights (option)

The front end weights can be attached to the bumper. See your implement operator's manual for required number of weights or consult your local KUBOTA Dealer to use.

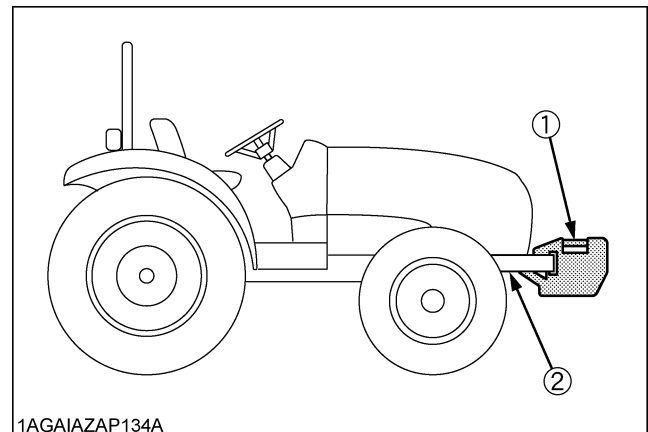

1AGAIAP134A

(1) Front end weights

(2) Bumper

IMPORTANT :

- Do not overload tires.
- Add no more weight than indicated in chart.
- Do not attach the front bumper when the front loader is attached.

Maximum weight	47 kg x 10 pieces (1036 lbs.)
----------------	----------------------------------

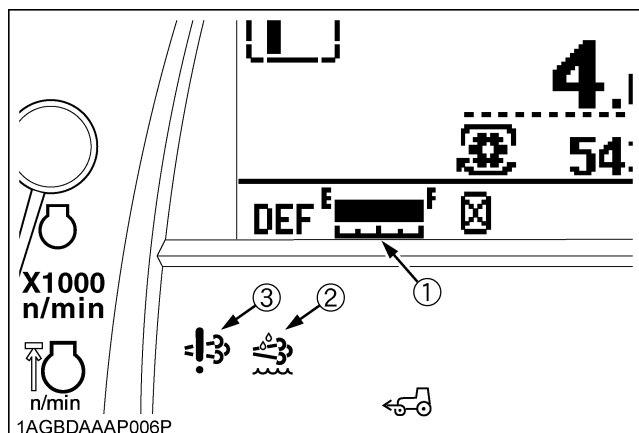

- (1) DEF/AdBlue® gauge
 (2) DEF/AdBlue® warning indicator
 (3) DEF/AdBlue® system warning indicator

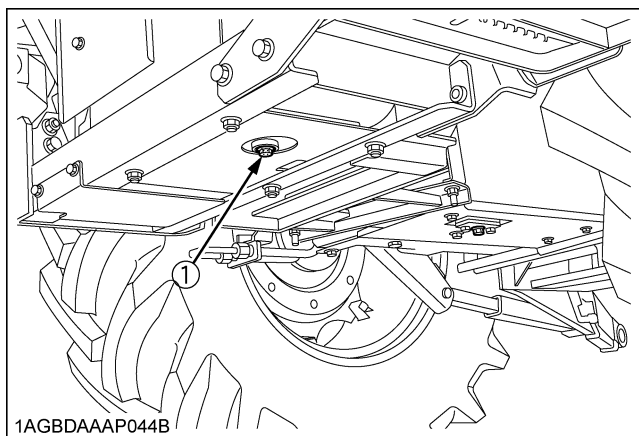

- (1) Drain plug

Tank capacity	12.3 L (3.2 U.S.gals.)
---------------	------------------------

IMPORTANT :

- Use exclusively DEF/AdBlue® that complies with the requirements of ISO 22241-1.
- **Do not allow fuel, oil or the like to enter the DEF/AdBlue® tank.**
 If any other substance (gasoline/diesel/oil) is mistakenly introduced into the DEF/AdBlue® tank, do not attempt to start the engine and contact your local KUBOTA dealer as soon as possible.
- Check the DEF/AdBlue® gauge regularly to avoid emptying its tank.
- If the DEF/AdBlue® spills, wipe it with water. If spills are not wiped, metal areas will rust and the aluminum areas will corrode.
- Be careful not to overfill the DEF/AdBlue® tank because otherwise a small amount of DEF/AdBlue® might flow out of the breather. Pour DEF/AdBlue® until its level rises up to the filler port. And the air will be let out of the tank and the liquid level will drop below the filler port. But do not attempt to pour any more.

■ Checking Water Separator

1. When the water has collected upper limit in the water separator, the water separator indicator on the instrument panel lights up and warning buzzer sounding.

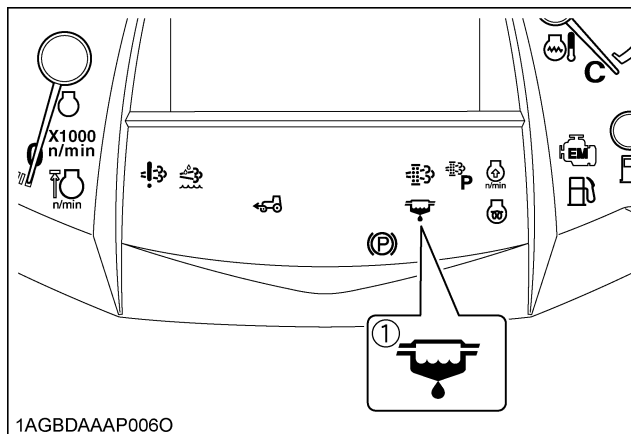

- (1) Water separator indicator

2. In such case, close the fuel shutoff-valve and loosen the air plug and drain plug by several turns.
3. Allow water to drain. When no more water comes out and fuel starts to flow out, retighten the air plug and drain plug.
4. Bleed the fuel system.
 (See "SERVICE AS REQUIRED" in "PERIODIC SERVICE" section.)

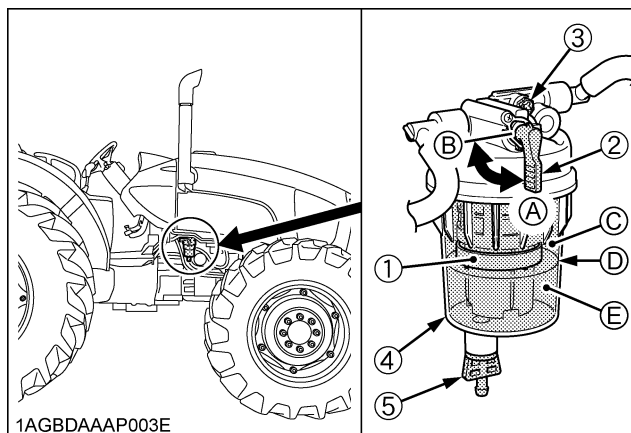

- (1) Red float
 (2) Fuel shutoff-valve
 (3) Air plug
 (4) Cup
 (5) Drain plug

- (A) "ON"
 (B) "OFF"
 (C) "FUEL"
 (D) "UPPER LIMIT"
 (E) "WATER"

NOTE :

- When the red float reaches near the upper limit level, start from step 2 in the above procedure to drain water in the water separator.

IMPORTANT :

- If water is drawn through to the fuel pump, extensive damage will occur.

EVERY 400 HOURS

■Cleaning Water Separator

This job should not be done in the field, but in a clean place.

1. Disconnect the connector of water sensor.
2. Close the fuel shutoff-valve.
3. Unscrew the cup and remove it, then rinse the inside with kerosene.
4. Take out the element and dip it in the kerosene to rinse.
5. After cleaning, reassemble the water separator, keeping out dust and dirt.
6. Connect the connector of water sensor.
7. Bleed the fuel system.

(See "SERVICE AS REQUIRED" in "PERIODIC SERVICE" section.)

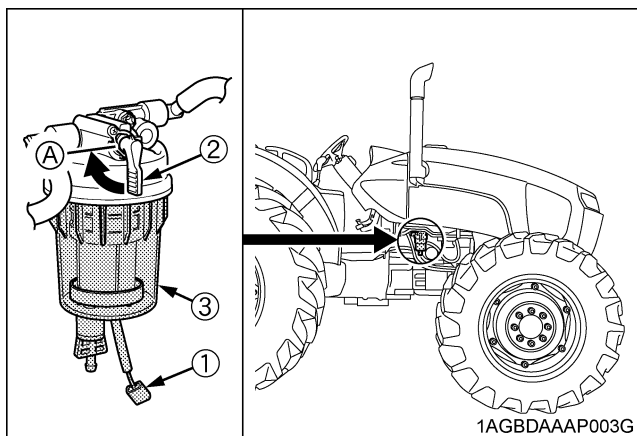

- (1) Water sensor connector (A) "CLOSE"
 (2) Fuel shutoff-valve
 (3) Cup

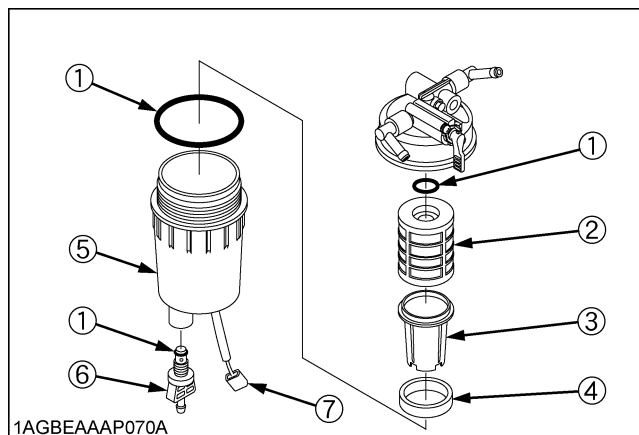

- (1) O ring
 (2) Element
 (3) Element cup
 (4) Red float
 (5) Cup
 (6) Drain plug
 (7) Water sensor connector

IMPORTANT :

- If the water separator and/or fuel filter is not well maintained, the supply pump and injector may be damaged earlier than expected.

■Lubricating Grease Fitting [2WD Model]

Detach the cover, and apply bearing grease.

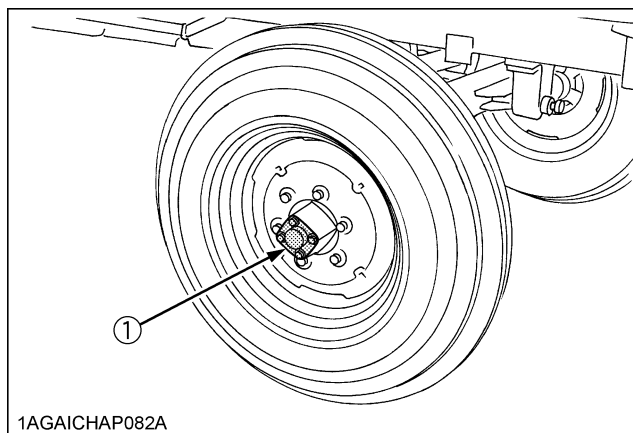

(1) Front wheel hub cover

EVERY 500 HOURS

■Changing Engine Oil



WARNING

To avoid personal injury or death:

- Be sure to stop the engine before changing the oil.
- Allow engine to cool down sufficiently, oil can be hot and can burn.

1. To drain the used oil, remove the drain plug at the bottom of the engine and drain the oil completely into the oil pan.
2. After draining reinstall the drain plug.
3. Fill with the new oil up to the upper notch on the dipstick.
 (See "LUBRICANTS" in "MAINTENANCE" section.)

Oil capacity with filter

10.7 L (11.3 U.S.qts.)

IMPORTANT :

- Use DPF-compatible oil (CJ-4) for the engine.

■Checking DEF/AdBlue® injector

Consult your local KUBOTA Dealer for this service.

■Replacing DEF/AdBlue® Pump Filter

1. Loosen 4 bolts and remove pump cover.
2. Clean up around the plug and remove the plug.
3. Loosen the top of filter assembly and remove it from pump.
4. Replace the filter assembly with new one.

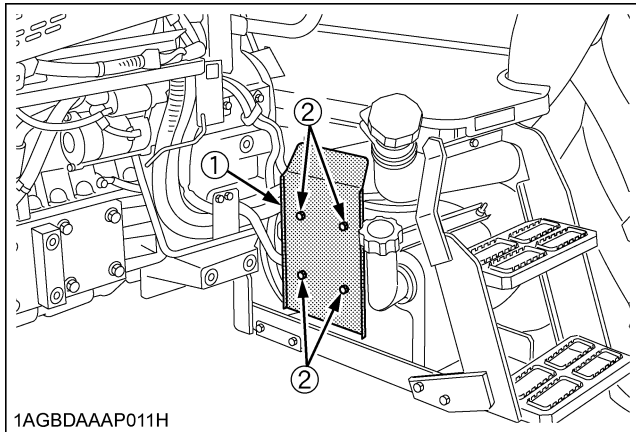

- (1) Pump cover
(2) Bolt

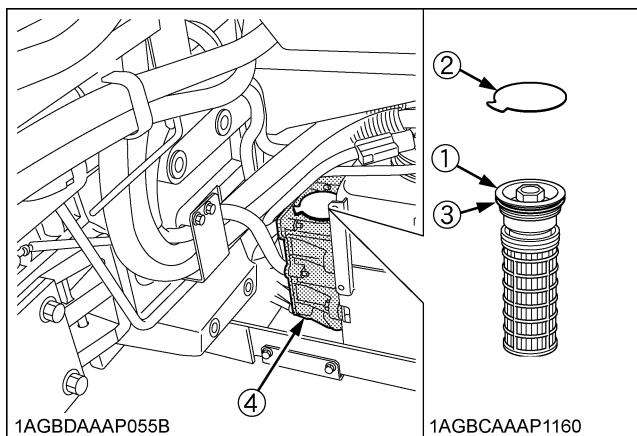

- (1) Filter assembly
(2) Plug
(3) O-ring
(4) DEF/AdBlue® pump

NOTE :

- Even after stopping the engine, the injector cooling DEF/AdBlue® fluid continues to circulate through the circuit for a couple of minutes.
When this circulation has ended, do the replacement job. (During cooling, the fluid's circulating noise is heard.)
- Do not apply oil to the O-ring of the cover.

EVERY 9000 HOURS**■Replacing DEF/AdBlue® Tank Filter**

Consult your local KUBOTA Dealer for this service.

EVERY 1 YEAR**■Checking Antifrost Heater for Oil Separator**

(if equipped)

Consult your local KUBOTA Dealer for this service.

■Checking DPF Related Pipe

Consult your local KUBOTA Dealer for this service.

■Checking EGR Pipe

Consult your local KUBOTA Dealer for this service.

EVERY 2 YEARS**■Cleaning Master Cylinder Filter**

Consult your local KUBOTA Dealer for this service.

■Replacing Oil Separator Related Rubber Pipe

Consult your local KUBOTA Dealer for this service.

■Replacing DPF Related Rubber Pipe

Consult your local KUBOTA Dealer for this service.

■Replacing EGR Cooler Hose

Consult your local KUBOTA Dealer for this service.

■Replacing Boost Sensor Hose

Consult your local KUBOTA Dealer for this service.

EVERY 4 YEARS**■Replacing Radiator Hose (Water pipes)**

Replace the hoses and clamps.

(See "Checking Radiator Hose and Clamp" in "EVERY 500 HOURS" in "PERIODIC SERVICE" section.)

■Replacing Fuel Hose

Consult your local KUBOTA Dealer for this service.

■Replacing Intake Air Line

Consult your local KUBOTA Dealer for this service.

12. Do not stand between tractor and implement or trailed vehicle unless parking brake is applied.

◆ Safety for children

Tragedy can occur if the operator is not alert to the presence of children. Children generally are attracted to machines and the work they do.

1. Never assume that children will remain where you last saw them.
2. Keep children out of the work area and under the watchful eye of another responsible adult.
3. Be alert and shut your machine down if children enter the work area.
4. Never carry children on your machine. There is no safe place for them to ride. They may fall off and be run over or interfere with your control of the machine.
5. Never allow children to operate the machine even under adult supervision.
6. Never allow children to play on the machine or on the implement.
7. Use extra caution when backing up. Look behind and down to make sure area is clear before moving.

◆ Operating on slopes

Slopes are a major factor related to loss-of-control and tip-over accidents, which can result in severe injury or death. All slopes require extra caution.

1. To avoid upsets, always back up steep slopes. If you cannot back up the slope or if you feel uneasy on it, do not operate on it. Stay off slopes too steep for safe operation.
2. Driving forward out of a ditch, mired condition or up a steep slope increases the risk of a tractor to be upset backward. Always back out of these situations. Extra caution is required with 4-wheel drive models because their increased traction can give the operator false confidence in the tractor's ability to climb slopes.
3. Keep all movement on slopes slow and gradual. Do not make sudden changes in speed, direction or apply brake and make sudden motions of the steering wheel.
4. Avoid disengaging the clutch or changing gears speed when climbing or going down a slope. If on a slope disengaging the clutch or changing gears to neutral could cause loss of control.
5. Special attention should be made to the weight and location of implements and loads as such will affect the stability of the tractor.
6. To improve stability on slope, set widest wheel tread as shown in "TIRES, WHEELS AND BALLAST" section.
Follow recommendations for proper ballasting.
7. To avoid free wheeling:
 - Do not shift the shuttle lever while on a slope.
 - Stop completely by using the brake and by depressing the clutch pedal, then shift the shuttle lever.
 - Start off after selecting shuttle direction, by releasing the clutch pedal.

◆ Driving the tractor on the road

1. Lock the 2 brake pedals together to help assure straight-line stops. Uneven braking at road speeds could cause the tractor to tip over.

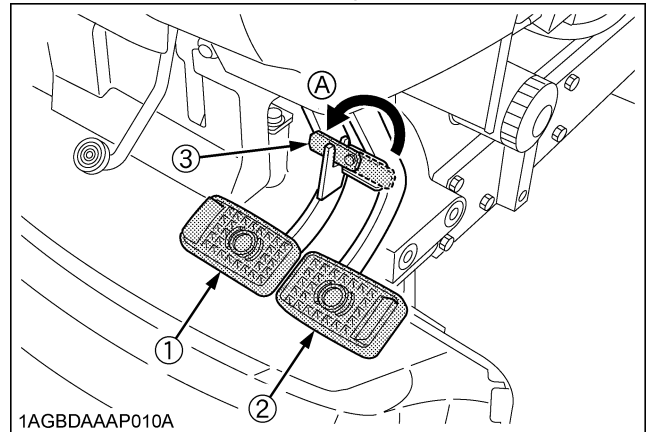

- (1) Brake Pedal (LH) (A) Whenever travelling on the road
 (2) Brake Pedal (RH)
 (3) Brake Pedal Lock

2. Check the front wheel engagement. The braking characteristics are different between 2 and 4-wheel drive. Be aware of the difference and use carefully.
3. Always slow the tractor down before turning. Turning at high speed may tip the tractor over.
4. Make sure that the Slow Moving Vehicle (SMV) sign is clean and visible. Use hazard lights and turn signals as required.

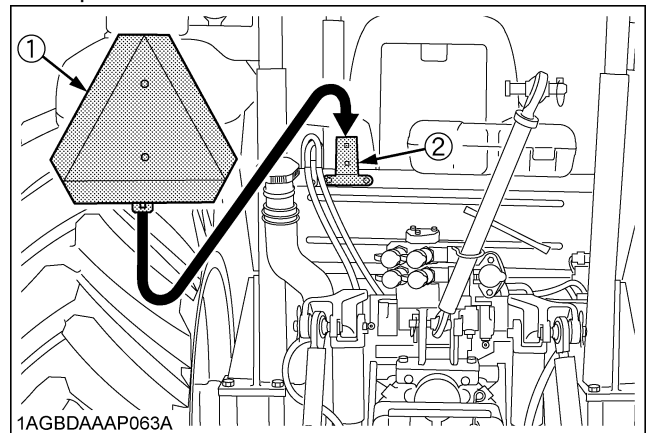

- (1) SMV emblem
 (2) Bracket

5. On public roads use the SMV emblem and hazard lights, if required by local traffic and safety regulations.
6. Observe all local traffic and safety regulations.
7. Turn the headlights on. Dim them when meeting another vehicle.
8. Drive at speeds that allow you to maintain control at all times.
9. Do not apply the differential lock while traveling at road speeds. The tractor may run out of control.

(1) Part No. TC660-9861-1

⚠ WARNING

TO AVOID PERSONAL INJURY OR DEATH:
When the Diesel Particulate Filter (DPF) is in the regenerating mode, the exhaust gas and the DPF muffler become hot. During regeneration, take into account that the muffler will be very hot and keep the machine away from other people, animals, plants, and flammable material. Also keep the area near the DPF muffler clean and away from flammable material.

1AGAHAKAP051A

(2) Part No. K3512-4719-1

Do not touch hot surface
like muffler, etc

1BDABANAP080A

(3) Part No. TA040-4965-2

⚠ DANGER

TO AVOID POSSIBLE INJURY OR DEATH FROM A MACHINE RUNAWAY.

1. Do not start engine by shorting across starter terminals or bypassing the safety start switch. Machine may start in gear and move if normal starting circuitry is bypassed.
2. Start engine only from operator's seat with transmission and PTO OFF. Never start engine while standing on the ground.

1AGAIAP009A

(4) Part No. 3A111-9801-1

⚠ WARNING

TO Avoid Serious Crushing Injuries or Death.
Do not ride or stand on the step during operation. Riding or standing there could result in being crushed under the rear tire due to slippage or the step fracturing or displacing due to unintended loading.

1AGAIHAP099A

(5) Part No. 3B291-1240-1

⚠ WARNING

TO AVOID PERSONAL INJURY OR DEATH FROM MALFUNCTION OF FRONT LOADER:
Refer to Operator's Manual and install hose guide when front loader is attached.

1AGBDAAAP085A

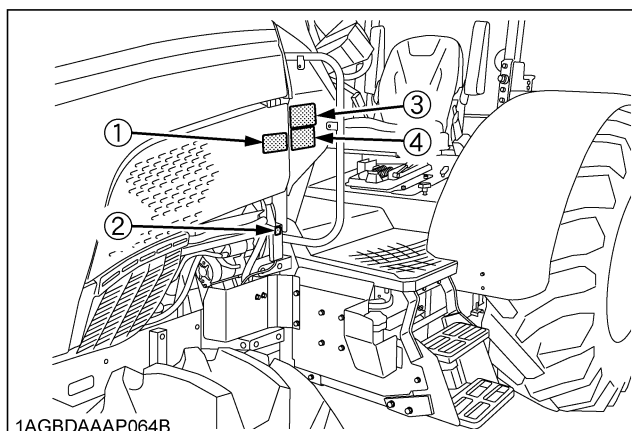

1AGBDAAAP064B

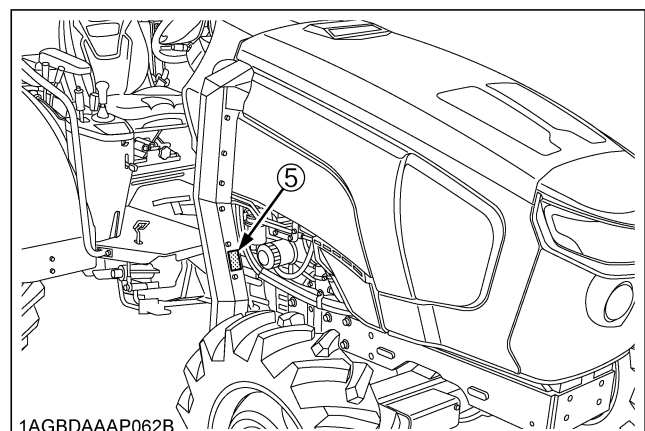

1AGBDAAAP062B

1AGBDAAAP070A

REMOTE HYDRAULIC CONTROL SYSTEM

The hydraulic auxiliary control valves can be installed up to triple segments.

Remote Control Valve

There are 2 types of remote valves available for these models.

- Double acting valve with detents and self cancelling:
This valve may be placed in the detent mode. The lever will stay in this position until the pressure reaches a predetermined level or a cylinder reaches the end of its stroke. Then it will automatically return to neutral.
- Double acting valve with float position:
This valve may be placed in the float mode with the control lever all the way forward. The cylinder is free to extend or retract, letting an implement such as a loader bucket follow the ground.

NOTE :

- This float valve can not be attached as the first segment.

Remote Control Valve Lever Location

	Remote Control Valve Lever		
	A	B	C
When 2 valves have been installed	---	1st	2nd
When 3 valves have been installed	1st	2nd	3rd

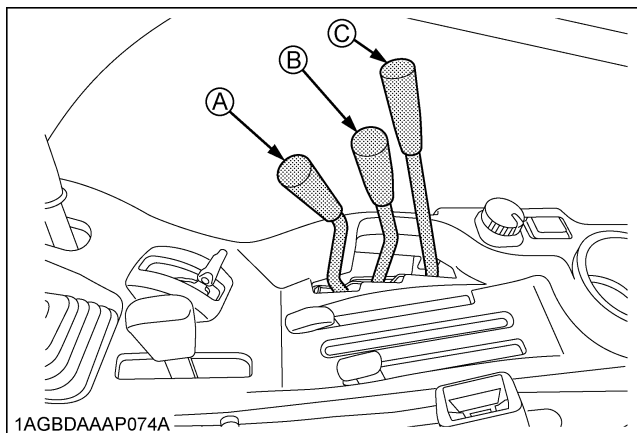

Remote Control Valve Lever

The remote control valve lever directs pressurized oil flow to the implement hydraulic system.

[Example: Installing triple segment valves]

1st	Double acting valve with detents and self cancelling (standard)
2nd	Double acting valve with detents and self cancelling (standard)
3rd	Double acting valve with float position (option)

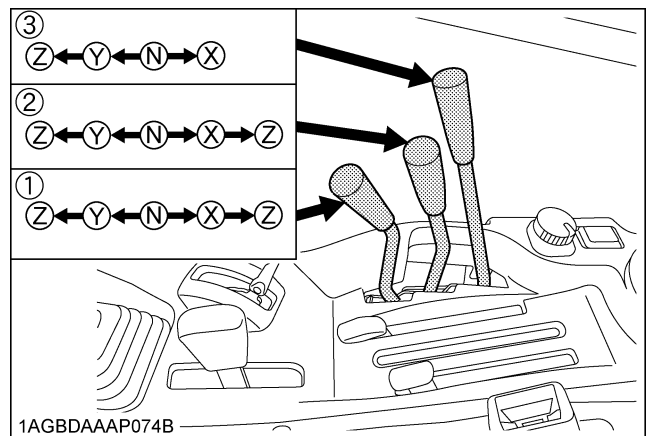

- (1) Remote control valve lever 1
(2) Remote control valve lever 2
(3) Remote control valve lever 3

