



SAFE OPERATION

Careful operation is your best insurance against an accident.

Read and understand this manual carefully before operating the tractor.

All operators, no matter how much experience they may have, should read this and other related manuals before operating the tractor or any implement attached to it. It is the owner's obligation to instruct all operators in safe operation.

1. BEFORE OPERATING THE TRACTOR

1. Know your equipment and its limitations. Read this entire manual before attempting to start and operate the tractor.
2. Pay special attention to the danger, warning and caution labels on the tractor.
3. KUBOTA recommends the use of a CAB or Roll Over Protective Structures (ROPS) and seat belt in almost all applications. This combination will reduce the risk of serious injury or death, should the tractor be upset. If the tractor is equipped with a foldable ROPS it may be temporarily folded down only when absolutely necessary for areas with height constraints.
(There is no operator protection provided by the ROPS in the folded position. For operator safety the ROPS should be placed in the upright and locked position and the seat belt fastened for all other operations.)
If the CAB or ROPS is loosened or removed for any reason, make sure that all parts are reinstalled correctly before operating the tractor.
Never modify or repair a ROPS because welding, bending, drilling, grinding, or cutting may weaken the structure.
A damaged CAB or ROPS structure must be replaced, not repaired or revised.
If any structural member of the CAB or ROPS is damaged, replace the entire structure at your local KUBOTA Dealer.

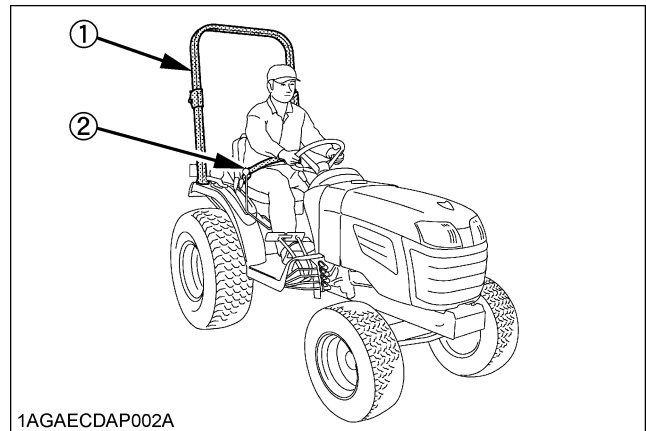

- (1) ROPS
(2) Seat belt

4. Always use the seat belt if the tractor has a CAB or ROPS.
Do not use the seat belt if a foldable ROPS is down or there is no ROPS. Check the seat belt regularly and replace if frayed or damaged.
5. Do not operate the tractor or any implement attached to it while under the influence of alcohol, medication, controlled substances or while fatigued.
6. Carefully check the vicinity before operating tractor or any implement attached to it. Check for overhead clearance which may interfere with a CAB or ROPS. Do not allow any bystanders around or near tractor during operation.
7. Before allowing other people to use your tractor, explain how to operate and have them read this manual before operation.
8. Never wear loose, torn, or bulky clothing around tractor. It may catch on moving parts or controls, leading to the risk of an accident. Use additional safety items, e.g. hard hat, safety boots or shoes, eye and hearing protection, gloves, etc., as appropriate or required.
9. Do not allow passengers to ride on any part of the tractor at anytime. The operator must remain in the tractor seat during operation.
10. Check brakes, clutch, linkage pins and other mechanical parts for improper adjustment and wear. Replace worn or damaged parts promptly. Check the tightness of all nuts and bolts regularly. (For further details, see "MAINTENANCE" section.)
11. Keep your tractor clean. Dirt, grease, and trash build up may contribute to fires and lead to personal injury.
12. Use only implements meeting the specifications listed under "IMPLEMENT LIMITATIONS" in this manual or implements approved by KUBOTA.

7. DANGER, WARNING AND CAUTION LABELS

(1) Part No. 6C150-4743-1 [HST type]



1AGAEBMAP069E

(1) Part No. 6C140-4743-1 [Manual Transmission type]



1AGAEBQAP085E

(2) Part No. 6C090-4965-1



1AGAEBMAP074E

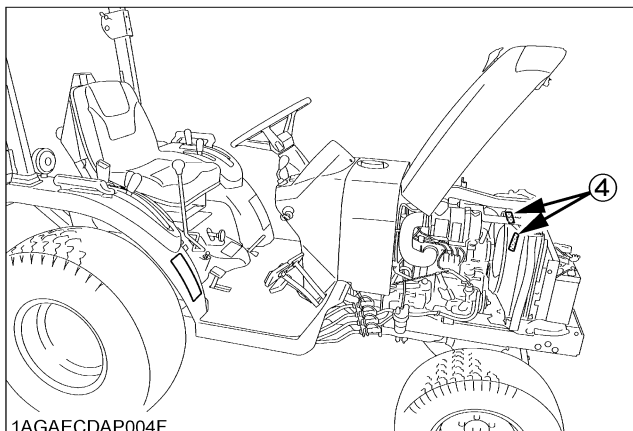

1AGAECDAPO04F

(3) Part No. 6C090-4959-1
Do not touch hot surface like muffler; etc.

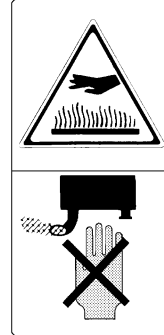

1AGAECDAPO320

(4) Part No. 6C090-4958-2
Do not get your hands close to engine fan and fan belt.



1AGAECDAPO310

(5) Part No. TC420-4956-1

Diesel fuel only

No fire



1AGAIDHAP154E

(6) Part No. 6C300-4744-1



1AGAIHFAP069A

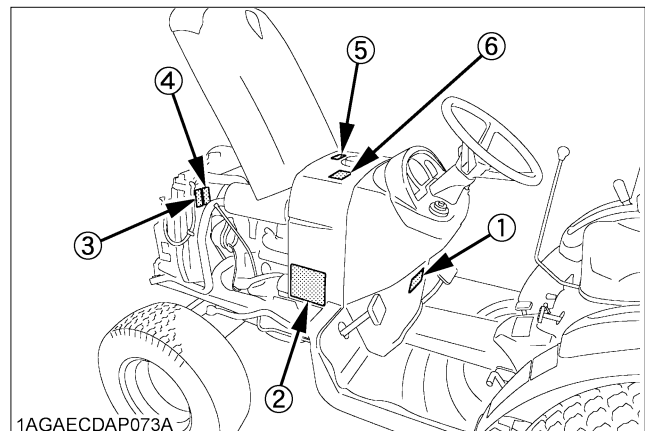

1AGAECDAPO73A

Model				B2320DTN-1	B2320DT	B2320HSDN	B2320HSD	B2620HSD	B2920HSD
Traveling system	Tires	Front		5-12	6-12	5-12	6-12	7-12	
		Rear		8-16	9.5-16	8-16	9.5-16	11.2-16	
	Steering			Integral type power steering					
	Transmission			Gear shift, 9 forward and 3 reverse		Main-hydrostatic transmission, 3 range gear shift (3 forward, 3 reverse)			
	Brake			Wet disk type					
	Min. turning radius (with brake)		m (feet)	2.1 (6.9)					
Hydraulic unit	Hydraulic control system			Position control valve	Quarter inching valve	Position control valve	Quarter inching valve		
	Pump capacity		L / min (gals / min)	3P: 17.9 (4.7), Power steering: 13.5 (3.6)					
	Three point hitch			SAE Category 1					
	Max. lift force	At lift points	kg (lbs.)	750 (1655)	615 (1356)	750 (1655)	615 (1356)		
		24 in. behind lift point	kg (lbs.)	590 (1300)	480 (1058)	590 (1300)	480 (1058)		
PTO	Rear-PTO			SAE 1-3/8, 6 splines					
	PTO / Engine speed		rpm	540 / 2773, 960 / 2722					
	Mid-PTO			-	USA No. 5 (KUBOTA 10-tooth) involute spline				
	PTO / Engine speed		rpm	-	2500 / 2750				

NOTE: * Manufacturer's estimate

The company reserves the right to change the specifications without notice.

Foot and Hand Controls [HST Type]

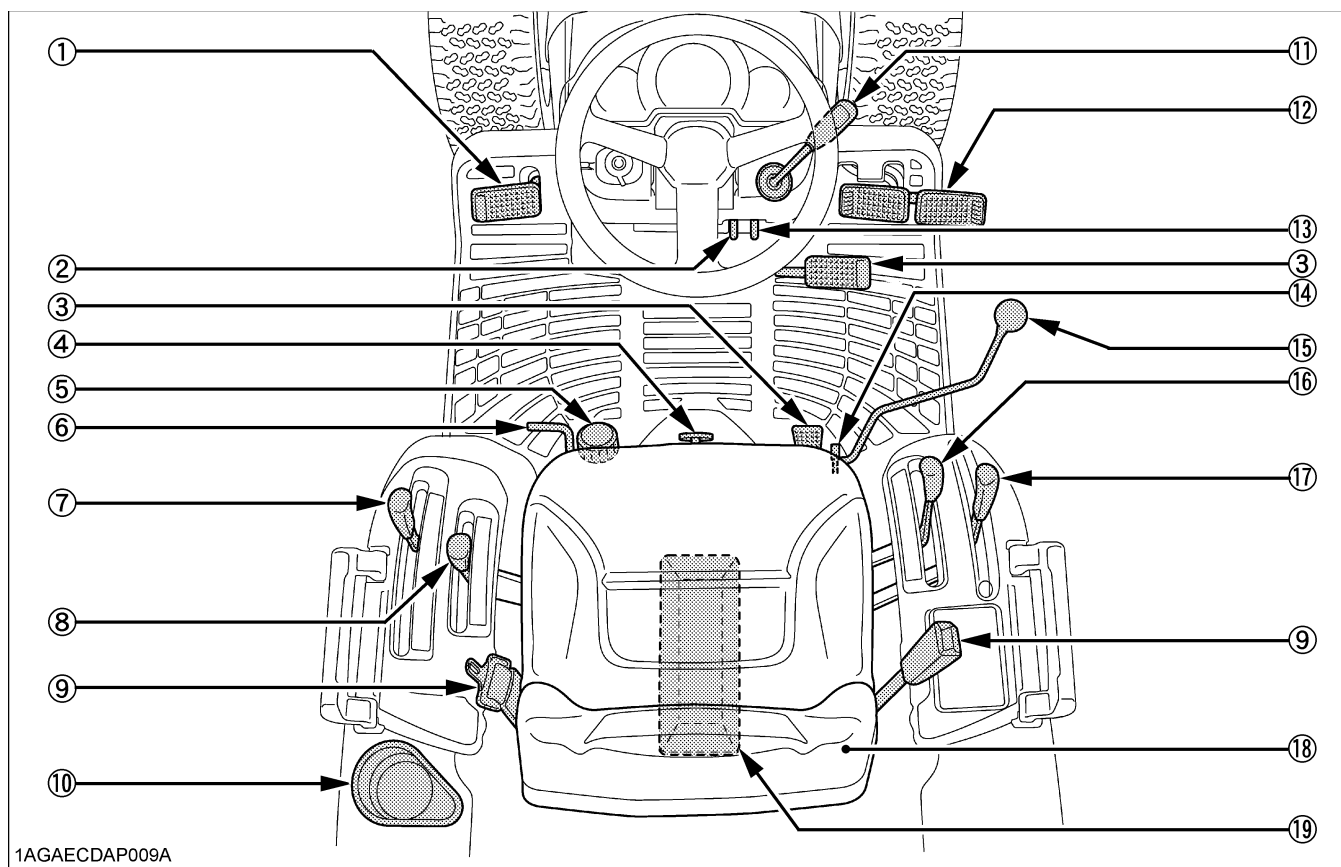

1AGAECDA009A

ILLUSTRATED CONTENTS

(1) Clutch pedal	21
(2) Speed set lever	25
(3) Speed control pedal	24
(4) 3-Point hitch lowering speed knob	35
(5) Cutting height control dial (if equipped)	---
(6) Differential lock pedal	27
(7) Range gear shift lever	22
(8) PTO gear shift lever	29
(9) Seat belt	20
(10) Cup holder	---
(11) Hand throttle lever	23
(12) Brake pedal	21
(13) Parking brake lever	27
(14) Loader lock lever	38
(15) Loader control lever	12, 37
(16) Front wheel drive lever	23
(17) Hydraulic control lever [Except B2320HSDN]..	34
Position control lever [B2320HSDN]	34
(18) Operator's seat	19
(19) Tool-box	---

8. Fully depress the clutch pedal, turn the key to "PREHEAT" position and hold it for about 2 to 3 seconds.

Temperature	Preheating Time
Over 0 °C (32 °F)	2 to 3 sec.
0 to -5 °C (32 to 23 °F)	5 sec.
-5 to -15 °C (23 to 5 °F)	10 sec.

NOTE :

- Glow plug indicator (5) comes on while engine is being preheated.

9. Turn the key to "START" position and release when the engine starts.

IMPORTANT :

- [HST type]
Because of the safety devices, the engine will not start except when the PTO gear shift lever is placed in the "OFF" position, the speed control pedal is placed in the "NEUTRAL" position, and the clutch pedal is disengaged.
- [Manual transmission type]
Because of the safety devices, the engine will not start except when the PTO gear shift lever is placed in the "OFF" position, the main gear shift lever is placed in the "NEUTRAL" position, and the clutch pedal is disengaged.

◆ **Cold Weather Starting**

When the ambient temperature is below -5 °C (23 °F) and the engine is very cold. If the engine fails to start, turn off the key for 30 seconds. Then repeat steps 8 and 9. To protect the battery and the starter, make sure that the starter is not continuously turned for more than 30 seconds.

■ **Block Heater (Option)**

A block heater is available as an option from your dealer. It will assist you in starting your tractor when the ambient temperature is below -15°C (5°F)

10. Check to see that all the lamps on the Easy Checker(TM) are "OFF".

If a lamp is still on, immediately stop the engine and determine the cause.

11. Release the clutch pedal

STOPPING THE ENGINE

1. After slowing the engine to idle, turn the key to "OFF".
2. Remove the key.

WARMING UP



CAUTION

To avoid personal injury:

- Be sure to set the parking brake during warm-up.
- Be sure to set all shift levers to the "NEUTRAL" positions and to place PTO lever in "OFF" position during warm-up.

For five minutes after engine start-up, allow engine to warm up without applying any load, this is to allow oil to reach every engine part. If load should be applied to the engine without this warm-up period, trouble such as seizure, breakage or premature wear may develop.

■ Warm-up Transmission Oil at Low Ambient Temperatures

Hydraulic oil serves as transmission fluid. In cold weather, the oil may be cold with increased viscosity. This can cause delayed oil circulation or abnormally low hydraulic pressure for some time after engine start-up. This in turn can result in trouble in the hydraulic system. To prevent the above, observe the following instructions:

Warm up the engine at about 50 % of rated rpm according to the table below:

Ambient temperature	Warm-up time requirement
Above 0 °C (32 °F)	At least 5 minutes
0 to -10 °C (32 to 14 °F)	5 to 10 minutes
-10 to -20 °C (14 to -4 °F)	10 to 15 minutes
Below -20 °C (-4 °F)	More than 15 minutes

IMPORTANT :

- Do not operate the tractor under full load condition until it is sufficiently warmed up.

3. Checking the brake pedal.

■ Brake Pedals (Right and Left)



WARNING

To avoid personal injury:

- Applying only one rear wheel brake at high speeds could cause the tractor to swerve or roll-over.



CAUTION

To avoid personal injury:

- An accident may occur if the tractor is suddenly braked, such as by heavy towed loads shifting forward or loss of control.
- The braking characteristics are different between two and four wheel drive. Be aware of the difference and use carefully.
- When driving on icy, wet or loose surfaces, make sure the tractor is correctly ballasted to avoid skidding and loss of steering control. Operate at reduced speed.

1. Before operating the tractor on the road or before applying the parking brake, be sure to interlock the right and left pedals as illustrated below.
2. Use individual brakes to assist in making sharp turns at slow speeds (Field Operation Only). Disengage the brake pedal lock and depress only one brake pedal.
3. Be sure brake pedals have equal adjustment when using locked together.

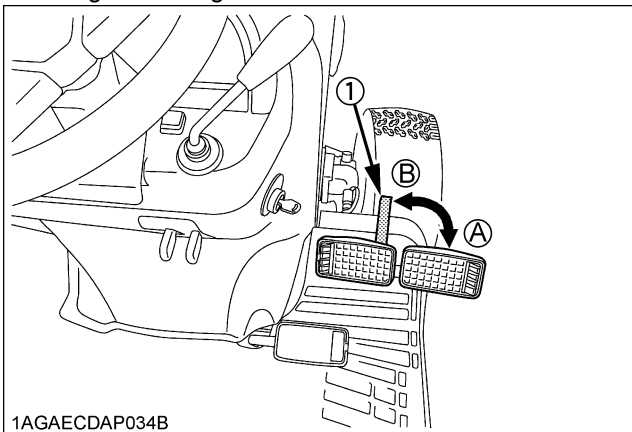

1AGAECDAPO34B

(1) Brake pedal lock

(A) "LOCK"

(B) "RELEASE"

4. Raise the implement. (See "HYDRAULIC UNIT" section.)

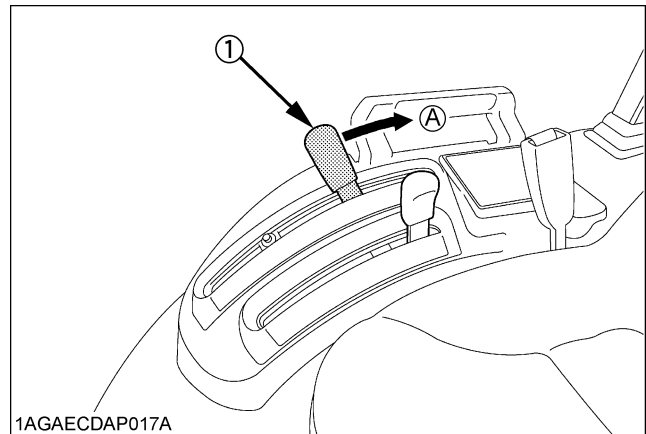

1AGAECDAPO17A

(1) Hydraulic control lever
[Except B2320DTN, B2320HSDN]
Position control lever
[B2320DTN, B2320HSDN]

(A) "UP"

5. Depress the Clutch Pedal.

■ Clutch Pedal



CAUTION

To avoid personal injury:

- Sudden release of the clutch may cause the tractor to lunge in an unexpected manner.

The clutch is disengaged when the clutch pedal is fully pressed down.

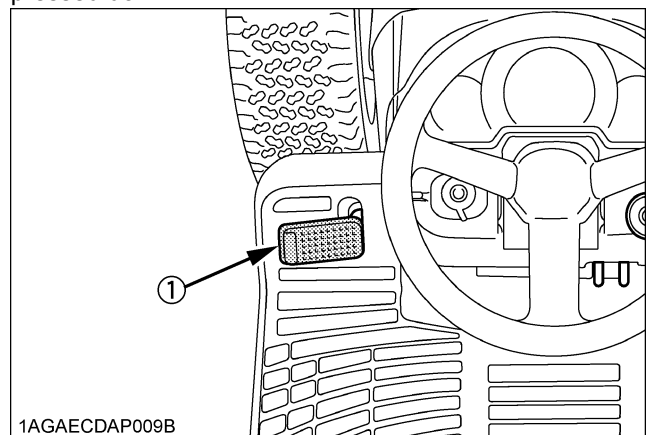

1AGAECDAPO09B

(1) Clutch pedal

IMPORTANT :

To help prevent premature clutch wear:

- The clutch pedal must be quickly disengaged and be slowly engaged.

PARKING

■ Parking Brake



CAUTION

To avoid personal injury:

- Always set the parking brake, stop the engine and remove the key before leaving the tractor seat.

1. When parking, be sure to set the parking brake.
To set the parking brake;
(1) Interlock the brake pedals.
(2) Depress the brake pedals.
(3) Latch the brake pedals with the parking brake lever.

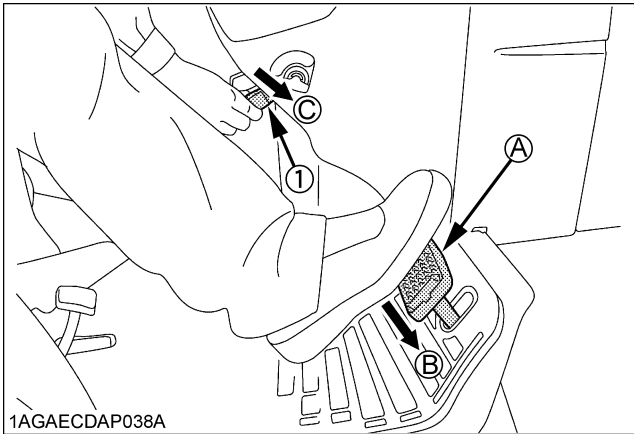

- (1) Parking brake lever
(A) Interlock the brake pedals
(B) "DEPRESS"
(C) "PUSH-DOWN"

2. Before getting off the tractor, disengage the PTO, lower all implements to the ground, place all control levers in their neutral positions, set the parking brake, stop the engine and remove the key.
3. If it is necessary to park on an incline, be sure to chock the wheels to prevent accidental rolling of the machine.

OPERATING TECHNIQUES

■ Differential Lock



WARNING

To avoid personal injury due to loss of steering control:

- Do not operate the tractor at high speed with differential lock engaged.
- Do not attempt to turn with the differential lock engaged.
- Be sure to release the differential lock before making a turn in field conditions.

If one of the rear wheels should slip, step on the differential lock pedal. Both wheels will turn together, then reduce slippage.

Differential lock is maintained only while the pedal is depressed.

[HST Type]

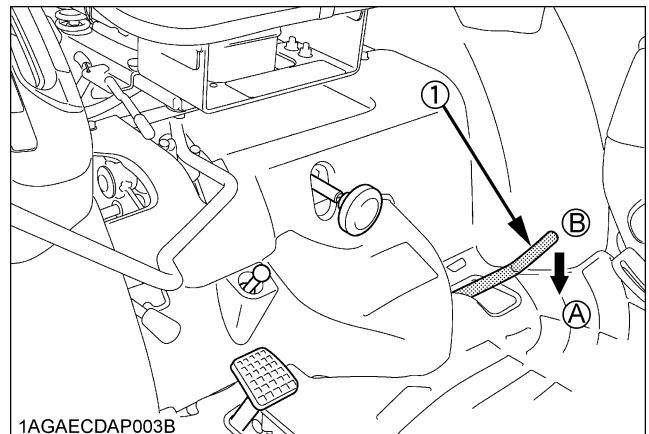

1AGAECDA003B

[Manual Transmission Type]

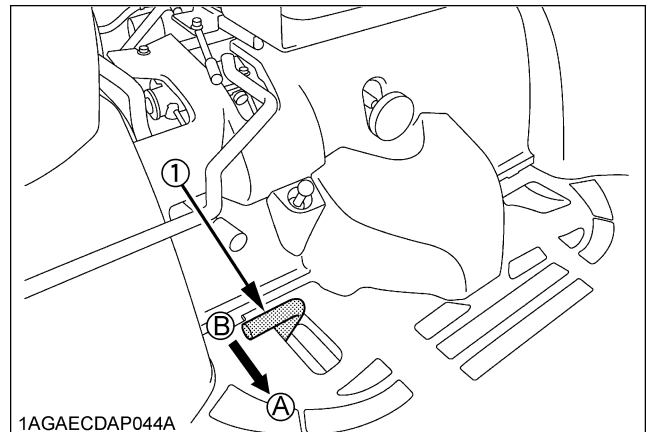

1AGAECDA044A

- (1) Differential lock pedal
(A) Press to "ENGAGE"
(B) Release to "DISENGAGE"

■ Implement Lowering Limit

[Except B2320DTN, B2320HSDN]

The implement lowering limit can be changed by shifting the locker (A).

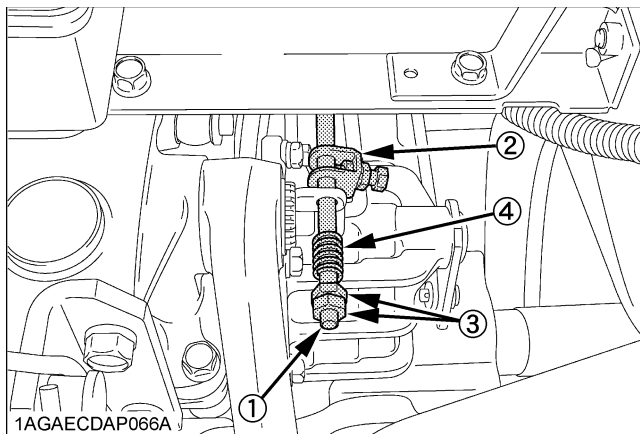

(1) Interlock rod
(2) Locker (A)
(3) Nuts
(4) Spring

Lower Limit

The lower limit can be changed by adjusting the position of locker (A). Shifting the locker (A) backward raises the lower limit and shifting it forward lowers the lower limit.

■ 3-point Hitch Lowering Speed



CAUTION

To avoid personal injury:

- Fast lowering speed may cause damage or injury. Lowering speed of implement should be adjusted to two or more seconds.

The lowering speed of the 3-point hitch can be controlled by adjusting the 3-point hitch lowering speed knob.

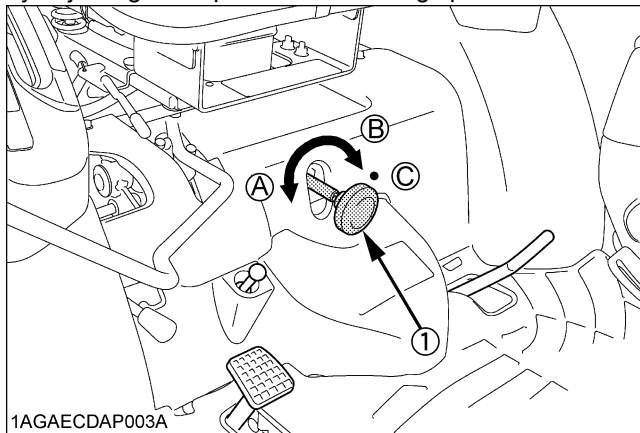

(1) 3-point hitch lowering speed knob
(A) "FAST"
(B) "SLOW"
(C) "LOCK"

AUXILIARY HYDRAULICS

Hydraulic outlet is provided on the tractor.
(without loader valve only)

■ Hydraulic Block Type Outlet

Hydraulic block type outlet is useful when adding hydraulically operated equipment such as front end loader, front blade, etc.

When implement is attached

1. Remove the block cover.
2. Attach the block outlet cover. (option)

[B2320DT]

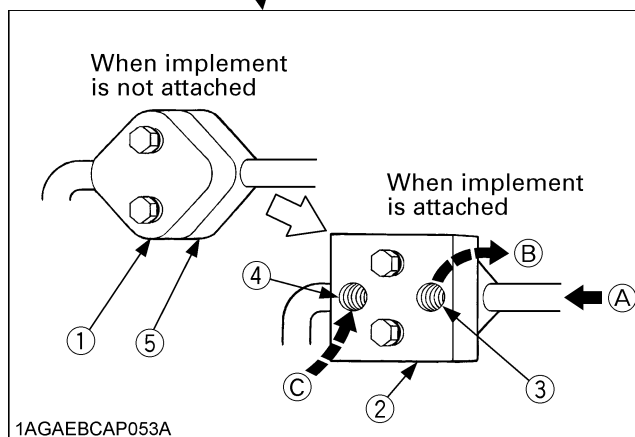
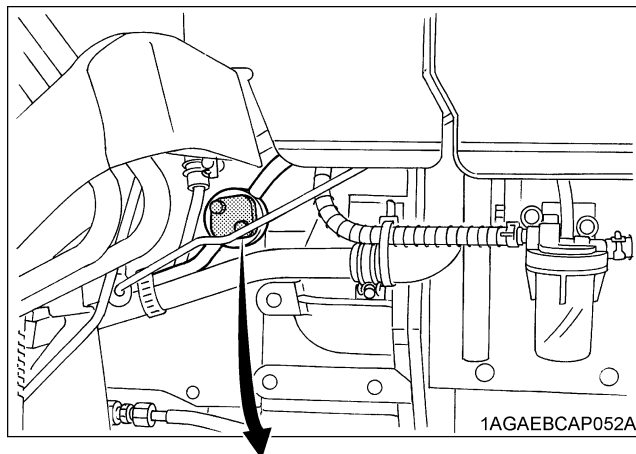

(1) Block cover
(2) Block outlet cover (option)
(3) Outlet
(4) Inlet
(5) Hydraulic block
(A) From gear pump
(B) To implement inlet
Max. flow
17.9 L/min
(4.7 U.S.gals./min)
No relief valve in the
hydraulic block.
(C) From implement outlet

IMPORTANT :

- For hydraulic block type outlet, be sure to use the control valve of the "Power beyond type" with relief valve that has a third line return to tank for the operation of hydraulic block.

TIRES, WHEELS AND BALLAST

TIRES



WARNING

To avoid personal injury:

- Do not attempt to mount a tire on a rim. This should be done by a qualified person with the proper equipment.
- Always maintain the correct tire pressure. Do not inflate tires above the recommended pressure shown in the operator's manual.

IMPORTANT :

- Do not use tires other than those approved by KUBOTA.

■ Inflation Pressure

Though the tire pressure is factory-set to the prescribed level, it naturally drops slowly over the course of time. Thus, check it regularly and inflate as necessary.

	Tire sizes	Inflation Pressure
Rear	8 - 16, 4PR	160kPa(1.6kgf/cm ² , 23psi)
	8.3 - 16, 6PR	150kPa(1.5kgf/cm ² , 22psi)
	9.5 - 16, 4PR	140kPa(1.4kgf/cm ² , 20psi)
	9.5 - 18, 4PR	160kPa(1.6kgf/cm ² , 23psi)
	315/75D - 15, 4PR	100kPa(1.0kgf/cm ² , 14psi)
	11.2 - 16, 4PR	130kPa(1.3kgf/cm ² , 18psi)
	12 - 16.5, 4PR	270kPa(2.7kgf/cm ² , 40psi)
	31x13.5 - 15, 4PR	140kPa(1.4kgf/cm ² , 20psi)
	31x15.5 - 15, 4PR	140kPa(1.4kgf/cm ² , 20psi)
Front	33x12.5 - 15, 4PR	140kPa(1.4kgf/cm ² , 20psi)
	5 - 12, 4PR	240kPa(2.4kgf/cm ² , 34psi)
	6 - 12, 4PR	200kPa(2.0kgf/cm ² , 28psi)
	7 - 12, 4PR	170kPa(1.7kgf/cm ² , 24psi)
	21x8.00 - 10, 4PR	160kPa(1.6kgf/cm ² , 23psi)
	22x8.50 - 12, 4PR	160kPa(1.6kgf/cm ² , 23psi)
	23x8.50 - 12Turf, 4PR	150kPa(1.5kgf/cm ² , 22psi)
	23x8.50 - 12Ind., 4PR	250kPa(2.5kgf/cm ² , 35psi)
	24x8.50 - 12, 4PR	160kPa(1.6kgf/cm ² , 23psi)

NOTE :

- Maintain the maximum recommended pressure in the front tires, when using a front loader or equipped with a full load of front weights.

■ Dual Tires

Dual tires are not approved.

WHEEL ADJUSTMENT



CAUTION

To avoid personal injury:

- When working on slopes or when working with trailer, set the wheel tread as wide as practical for maximum stability.
- Support tractor securely on stands before removing a wheel.
- Do not work under any hydraulically supported devices. They can settle, suddenly leak down, or be accidentally lowered. If necessary to work under tractor or any machine elements for servicing or adjustment, securely support them with stands or suitable blocking beforehand.
- Never operate tractor with a loose rim, wheel, or axle.

■ Front Wheels

Front tread width can not be adjusted.

IMPORTANT :

- Do not turn front discs to obtain wider tread.
- When re-fitting or adjusting a wheel, tighten the bolts to the following torques then recheck after driving the tractor 200 m (200 yards) and 10 times of shuttle movement by 5 m (5 yards), and thereafter according to service interval. (See "MAINTENANCE" section.)

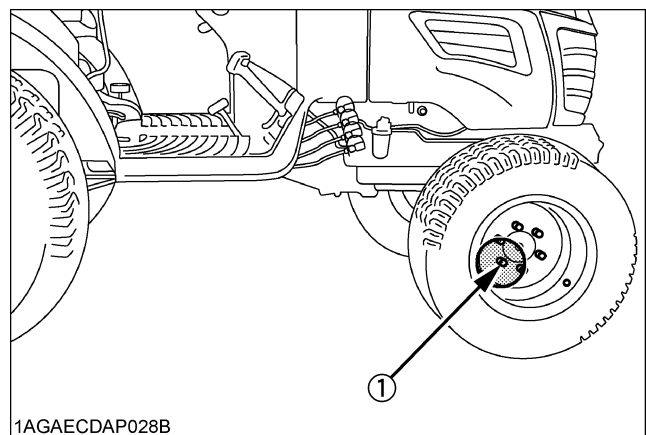

1AGAECDAPO28B

(1) 79 to 92 N-m (8.1 to 9.4 kgf-m, 58.3 to 67.9 ft-lbs)

■ Engine Side Cover

1. Tilt down the front grille forward.
2. Lift up the front of the engine side cover and free the upper and lower projections.

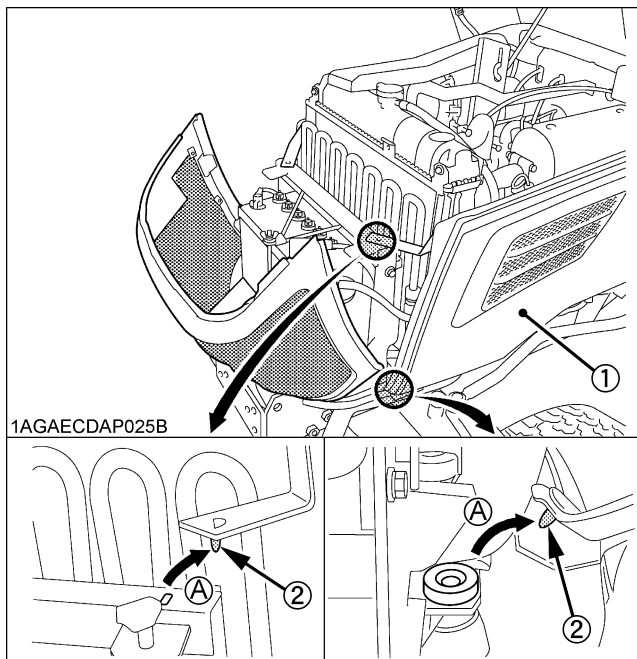

(1) Engine side cover
(2) Projection

(A) "LIFT UP TO REMOVE"

3. Pull the engine side cover forward and free the rear notches. Now the side cover can be detached.

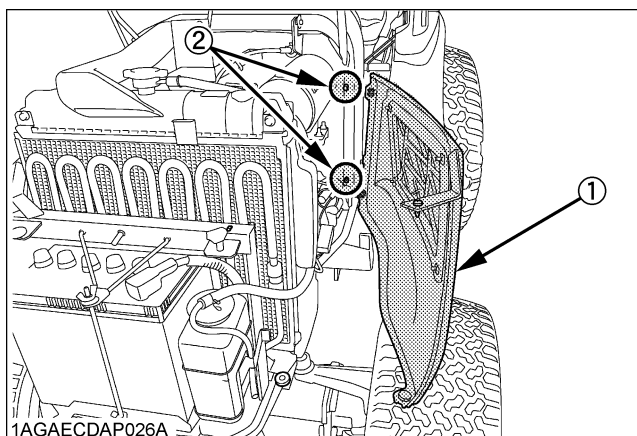

(1) Engine side cover
(2) Notch

DAILY CHECK

For your own safety and maximum service life of the machine, make a thorough daily inspection before operating the machine to start the engine.



CAUTION

To avoid personal injury:

- Be sure to check and service the tractor on a level surface with the engine shut off and the parking brake "ON" and implement lowered to the ground.

■ Walk Around Inspection

Look around and under the tractor for such items as loose bolts, trash build-up, oil or coolant leaks, broken or worn parts.

■ Cleaning Grill and Radiator Screen



CAUTION

To avoid personal injury:

- Be sure to stop the engine and remove the key before removing the screen.

1. Check front grill and side screens to be sure they are clean of debris.
2. Detach the screen and remove all foreign materials and clean the front of radiator completely.

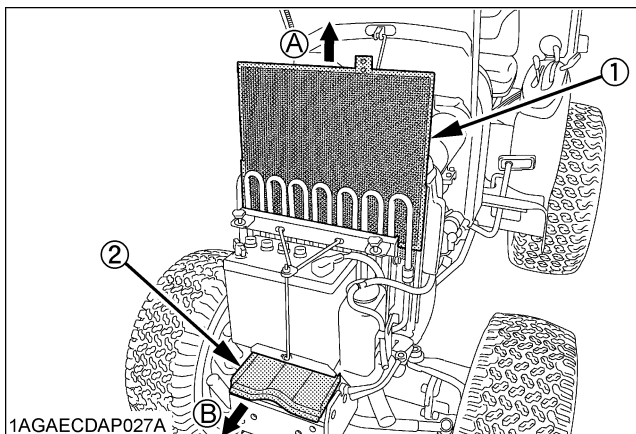

1AGAECDAPO27A

- (1) Radiator screen
(2) Shutter plate

- (A) "DETACH"
(B) "PULL"

IMPORTANT :

- Grill and screen must be clean from debris to prevent engine from overheating and to allow good air intake for the air cleaner.

NOTE :

- If the dust or chaff has accumulated between the battery and radiator, open the shutter plate and clean the front of radiator completely.

■ Checking Brake Pedals and Clutch Pedal

1. Inspect the brake and clutch pedals for free travel, and smooth operation.
2. Adjust if incorrect measurement is found:
(See "Adjusting Clutch Pedal" and "Adjusting Brake Pedal" in "EVERY 100 HOURS" in "PERIODIC SERVICE" section.)

NOTE :

- Brake pedals should be equal when depressed.

■ Checking Gauges, Meter and Easy Checker(TM)

1. Inspect the instrument panel for broken gauge(s), meter(s) and Easy Checker(TM).
2. Replace if broken.

■ Checking Head Light, Hazard Light etc.

1. Inspect the lights for broken bulbs and lenses.
2. Replace if broken.

■ Checking Seat Belt and ROPS

1. Always check condition of seat belt and ROPS attaching hardware before operating tractor.
2. Replace if damaged.

EVERY 100 HOURS

■ Battery



DANGER

To avoid the possibility of battery explosion:
For the refillable type battery, follow the instructions below.

- Do not use or charge the refillable type battery if the fluid level is below the LOWER (lower limit level) mark. Otherwise, the battery component parts may prematurely deteriorate, which may shorten the battery's service life or cause an explosion. Check the fluid level regularly and add distilled water as required so that the fluid level is between the UPPER and LOWER levels.



CAUTION

To avoid personal injury:

- Never remove the vent caps while the engine is running.
- Keep electrolyte away from eyes, hands and clothes. If you are spattered with it, wash it away completely with water immediately and get medical attention.
- Wear eye protection and rubber gloves when working around the battery.

The factory-installed battery is of non-refillable type. If the indicator turns white, do not charge the battery but replace it with new one.

Mishandling the battery shortens the service life and adds to maintenance costs.

The original battery is maintenance free, but needs some servicing.

If the battery is weak, the engine will be difficult to start and the lights will be dim. It is important to check the battery periodically.

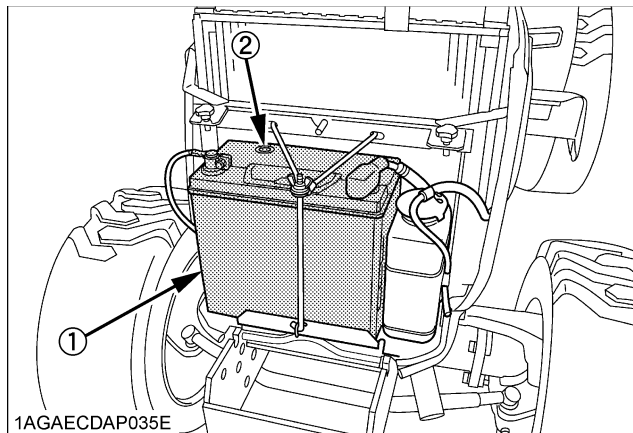

(1) Battery
(2) Indicator

◆ How to read the indicator

Check the battery condition by reading the indicator.

State of indicator display	
Green	Specific gravity of electrolyte and quality of electrolyte are both in good condition.
Black	Needs charging battery.
White	Needs replacing battery.

◆ Battery Charging



CAUTION

To avoid personal injury:

- When the battery is being activated, hydrogen and oxygen gases in the battery are extremely explosive. Keep open sparks and flames away from the battery at all times, especially when charging the battery.
- When charging the battery, ensure the vent caps are securely in place. (if equipped)
- When disconnecting the cable from the battery, start with the negative terminal first.
When connecting the cable to the battery, start with the positive terminal first.
- Never check battery charge by placing a metal object across the posts.
Use a voltmeter or hydrometer.

■Cleaning Fuel Filter

This job should not be done in the field, but in a clean place.

1. Loosen and remove the filter bowl, and rinse the inside with kerosene.
2. Take out the element and dip it in the kerosene to rinse.
3. After cleaning, reassemble the fuel filter, keeping out dust and dirt.
4. Bleed the fuel system.
(See "SERVICE AS REQUIRED" in "PERIODIC SERVICE" section.)

IMPORTANT :

- When the fuel filter bowl has been removed, fuel stops flowing from the fuel tank. If the fuel tank is almost full, however, the fuel will flow back from the fuel return pipe to the fuel filter. Before checking, make sure the fuel tank is less than half-full.

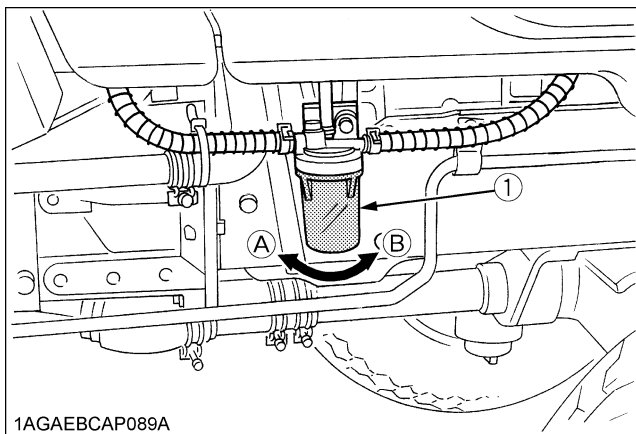

(1) Fuel filter bowl

(A) "LOOSEN"
(B) "TIGHTEN"

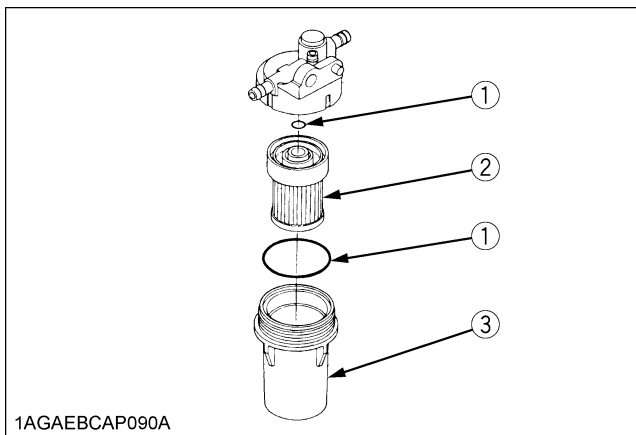

(1) O ring
(2) Filter element
(3) Filter bowl

IMPORTANT :

- If dust, dirt or water enters the fuel system, the fuel pump and injection nozzles are subject to premature wear. To prevent this, be sure to clean the fuel filter bowl and element periodically.

■Adjusting Fan Belt Tension

Proper fan belt tension	A deflection of between 7 to 9 mm (0.28 to 0.35 in.) when the belt is pressed in the middle of the span.
-------------------------	--

1. Stop the engine and remove the key.
2. Apply moderate thumb pressure to belt between pulleys.
3. If tension is incorrect, loosen the alternator mounting bolts and, using a lever placed between the alternator and the engine block, pull the alternator out until the deflection of the belt falls within acceptable limits.
4. Replace fan belt if it is damaged.

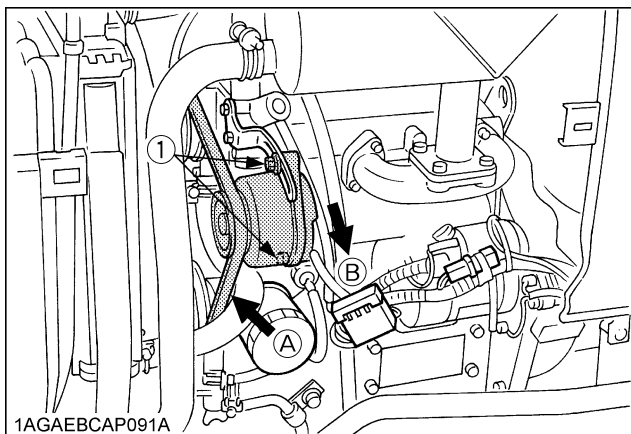

(1) Bolt

(A) Check the belt tension
(B) To tighten

■ Replacing Transmission Oil Filter [HST Type]



CAUTION

To avoid personal injury:

- Be sure to stop the engine before changing the oil filter cartridge.
- Allow engine to cool down sufficiently, oil can be hot and can burn.

1. Remove the drain plugs at the bottom of the transmission case and drain the oil completely into the oil pan.
2. After draining reinstall the drain plugs.

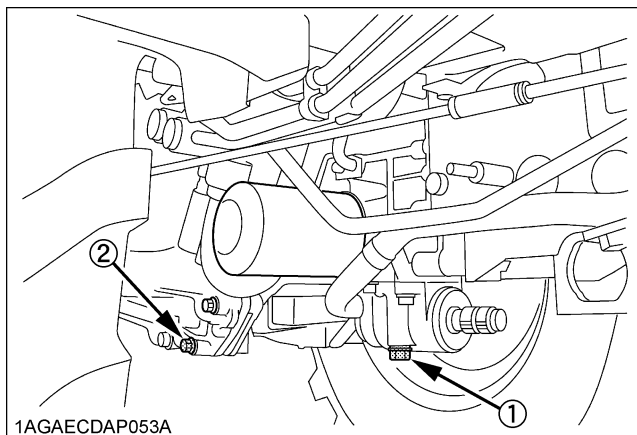

- (1) Drain plug
(2) Drain plugs (Both sides)

3. Remove the oil filter.

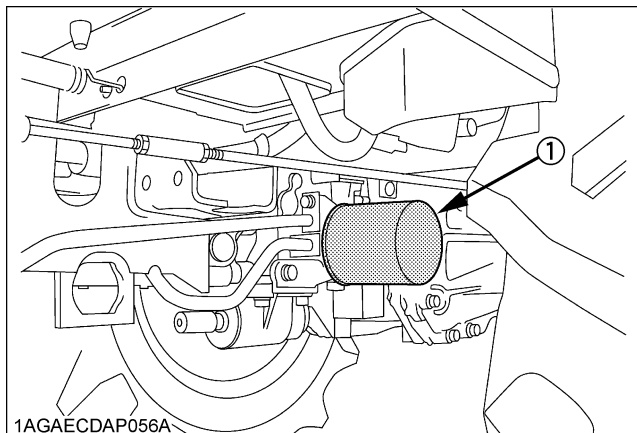

- (1) Transmission oil filter [HST Type]

4. Put a film of clean transmission oil on the rubber seal of the new filter.
5. Quickly tighten the filter until it contacts the mounting surface, then, with a filter wrench, tighten it an additional 1 turn only.
6. After the new filter has been replaced, fill the transmission oil up to the upper notch on the dipstick.

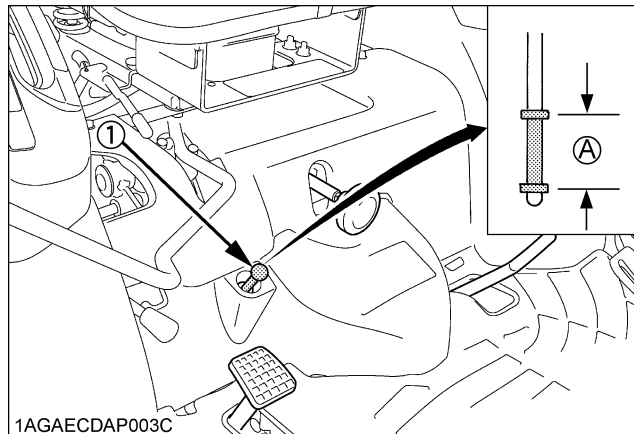

- (1) Dipstick (A) Oil level is acceptable within this range.

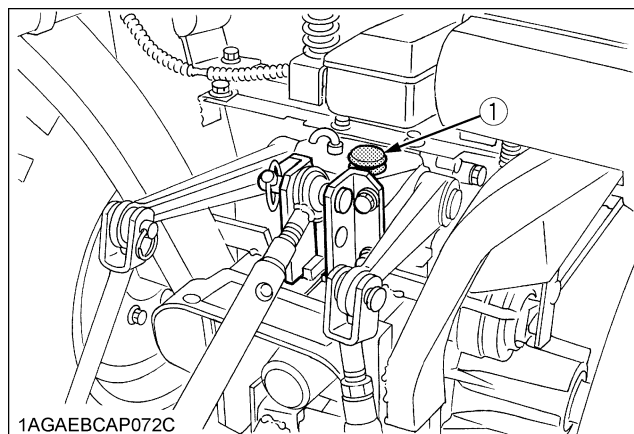

- (1) Oil inlet

7. After running the engine for a few minutes, stop the engine and check the oil level again, add oil to the prescribed level.
8. Make sure that the transmission fluid doesn't leak past the seal on the filter.

IMPORTANT :

- To prevent serious damage to the hydraulic system, use only a KUBOTA genuine filter.

■ Replacing Fuse

The tractor electrical system is protected from potential damage by fuses.

A blown fuse indicates that there is an overload or short somewhere in the electrical system.

If any of the fuses should blow, replace with a new one of the same capacity.

IMPORTANT :

- Before replacing a blown fuse, determine why the fuse blew and make any necessary repairs. Failure to follow this procedure may result in serious damage to the tractor electrical system. Refer to the "TROUBLESHOOTING" section of this manual or your local KUBOTA Dealer for specific information dealing with electrical problems.

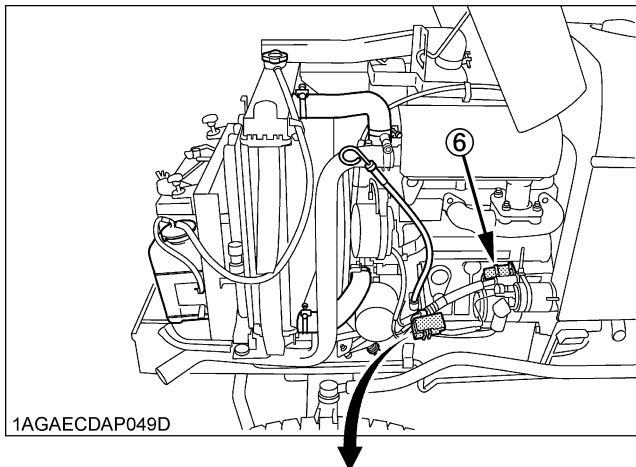

HAZARD	10A	①
SOLENOID	30A	②
KEY STOP	5A	③
HEAD LIGHT PANEL	10A	④
WORK LIGHT	20A	⑤

1AGAECDAPO62A

◆ Protected circuit

FUSE No.	CAPACITY (A)	Protected circuit
(1)	10	HAZARD
(2)	30	SOLENOID
(3)	5	KEY STOP
(4)	10	HEAD LIGHT PANEL
(5)	20	WORK LIGHT
(6)	Slow blow fuse	Check circuit against wrong battery connection

■ Replacing Light Bulb

1. Head light
Take the bulb out of the light body and replace with a new one.
2. Other lights
Detach the lens and replace the bulb.

Light	Capacity
Head light	23W
Tail light	8W
Turn signal / Hazard light	23W and 23W
Instrument panel light	1.7W
Hazard light switch indicator	0.6W