

**Chrome Rear Step Bumpers ... Style and Utility All in One**

Ranger 1983-09



50-5285

50-5289

Chrome Rear Step Bumpers give your truck the ability to tow up to 300 pounds tongue weight and 3,500 pounds trailer weight.

These bumpers offer the ease of bolt-on installation, the convenience of a step and come complete with rear license plate lamps. Do not exceed truck manufacturer's recommended towing capacity. A Bumper Mounting Kit #50-0050 is required when installing these rear bumpers.

\* After the sell price means Oversize Part Charge. Your order will incur a charge of \$20.00. When ordering multiple oversized parts only one Oversize Part Charge of \$20.00 will be applied to your order.

**Chrome Rear Step Bumper - Diamond Tread**

This traditional utility bumper features a classic embossed steel top plate on a stylish and reliable step bumper.

**Chrome Rear Step Bumper - Polymer Pad**

This classic style rear step bumper features a step pad to give your truck that finishing touch. Made from molded polymer, the step pad protects your truck from scratches while the grid pattern adds an excellent anti-skid surface for sure footing while loading and unloading.

PART	DESCRIPTION AND APPLICATION	REQD	LIST	SELL
50-5285	CHROME STEP BUMPER-DIAMOND TREAD	STYLESIDE 83-09 (1)	249.94	199.95 *
50-5289	CHROME STEP BUMPER W/STEP PAD	STYLESIDE 83-09 (1)	287.44	229.95 *
50-0050	BUMPER MOUNTING KIT	STYLESIDE 83-09 (1)	37.44	29.95

**Reproduction Chrome Door Mirror**

Ranger 1983-89  
Bronco II 1984-89

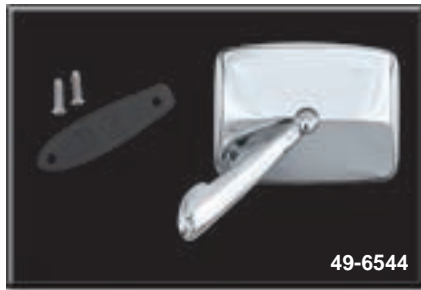

Hardware Included

49-6544

PART	DESCRIPTION AND APPLICATION	REQD	LIST	SELL
49-6544	DOOR MIRROR-LH-CHROME	MANUAL RGR BRII 83-89 (1)	49.94	39.95
49-6545	DOOR MIRROR-RH-CHROME	MANUAL RGR BRII 83-89 (1)	49.94	39.95

**Reproduction Black Door Mirror**

Ranger 1985-92  
Bronco II 1985-90  
Explorer 1991-94



49-6640

Hardware Included

PART	DESCRIPTION AND APPLICATION	REQD	LIST	SELL
49-6640	DOOR MIRROR-LH-BLACK	4" X 6" 85-94 (1)	49.94	39.95
49-6641	DOOR MIRROR-RH-BLACK CONVEX	4" X 6" 85-94 (1)	49.94	39.95

**Black Rubber Floor Mat**

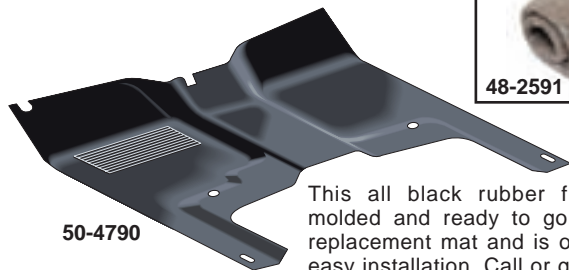

50-4790



48-2591

This all black rubber floor mat is molded and ready to go. It is a full replacement mat and is one piece for easy installation. Call or go online and order yours today!

This 1/4" thick synthetic Insulation Material is similar to the insulation used in today's trucks. It also makes a great sound deadening material when used underneath rubber floor mats or wherever your truck needs extra insulation.

PART	DESCRIPTION AND APPLICATION	REQD	LIST	SELL
50-4790	RUBBER FLOOR MAT	STD CAB RANGER 83-97 (1)	112.44	89.95
48-2591	INSULATION MATERIAL 36" X 72" ROLL	CUT TO FIT	18.69	14.95

**Reproduction Stainless Steel Door Mirror**

Ranger 1983-92  
Bronco II 1984-90  
Explorer 1991-94



Hardware Included

49-6620

Can be used to replace original style mirror on models equipped with factory internal door mirror brace.

PART	DESCRIPTION AND APPLICATION	REQD	LIST	SELL
49-6620	DOOR MIRROR-LH	STAINLESS STEEL 5" X 6" 83-94 (1)	49.94	39.95
49-6621	DOOR MIRROR-RH	STAINLESS STEEL 5" X 8" 83-94 (1)	49.94	39.95
49-6623	DOOR MIRROR-RH CONVEX	STAINLESS STEEL 5" X 8" 85-94 (1)	49.94	39.95