

# F RELAY LOCATIONS

## [Engine Compartment]

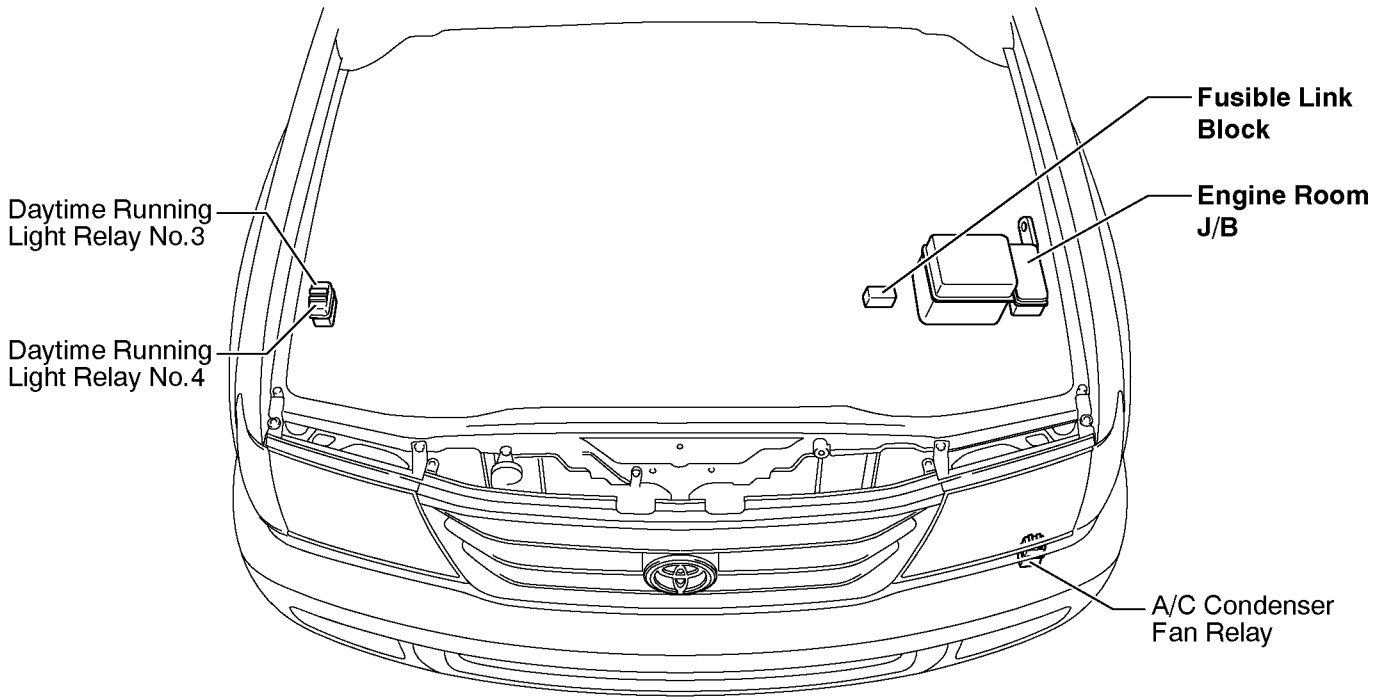

## [Instrument Panel]

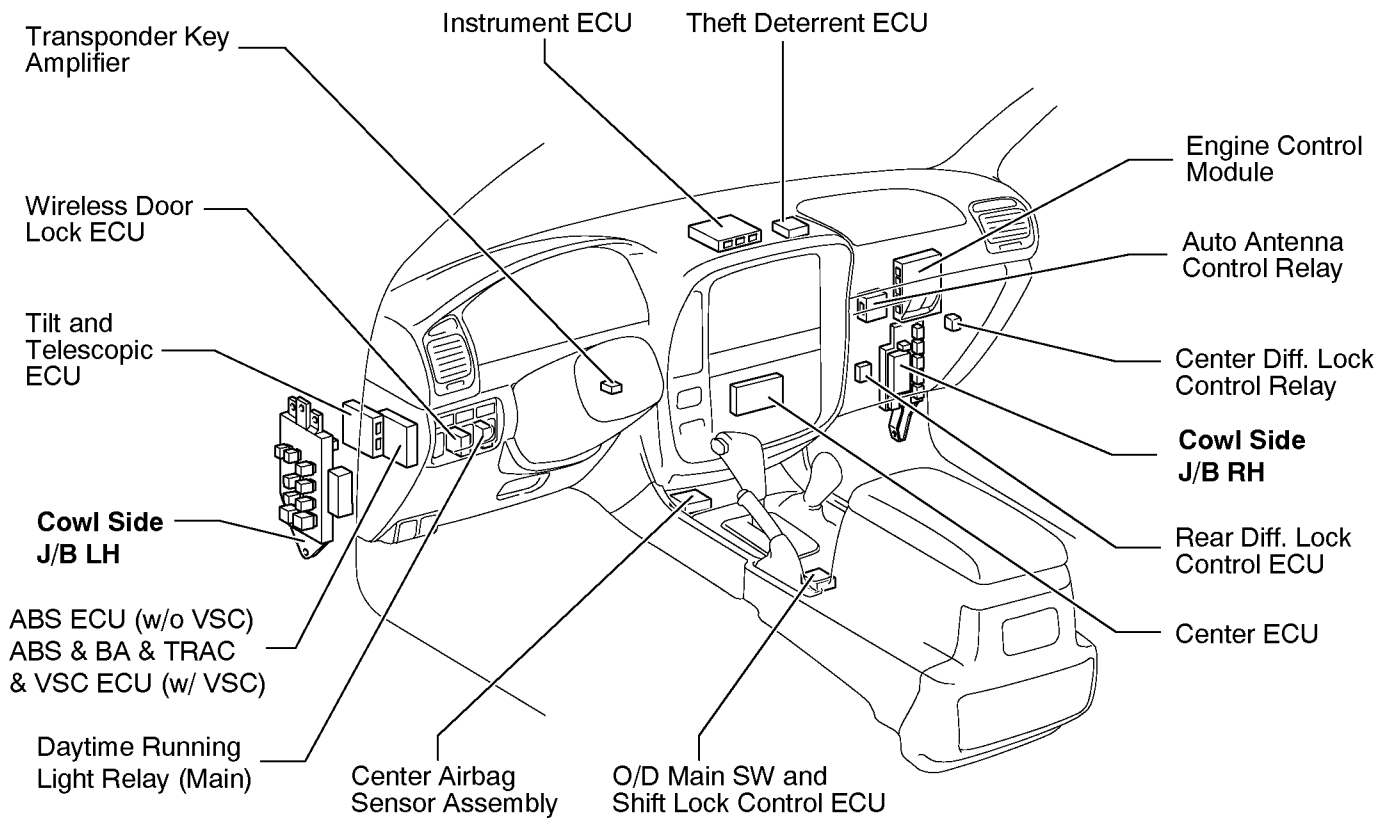



# G ELECTRICAL WIRING ROUTING

□ : Location of Connector Joining Wire Harness and Wire Harness

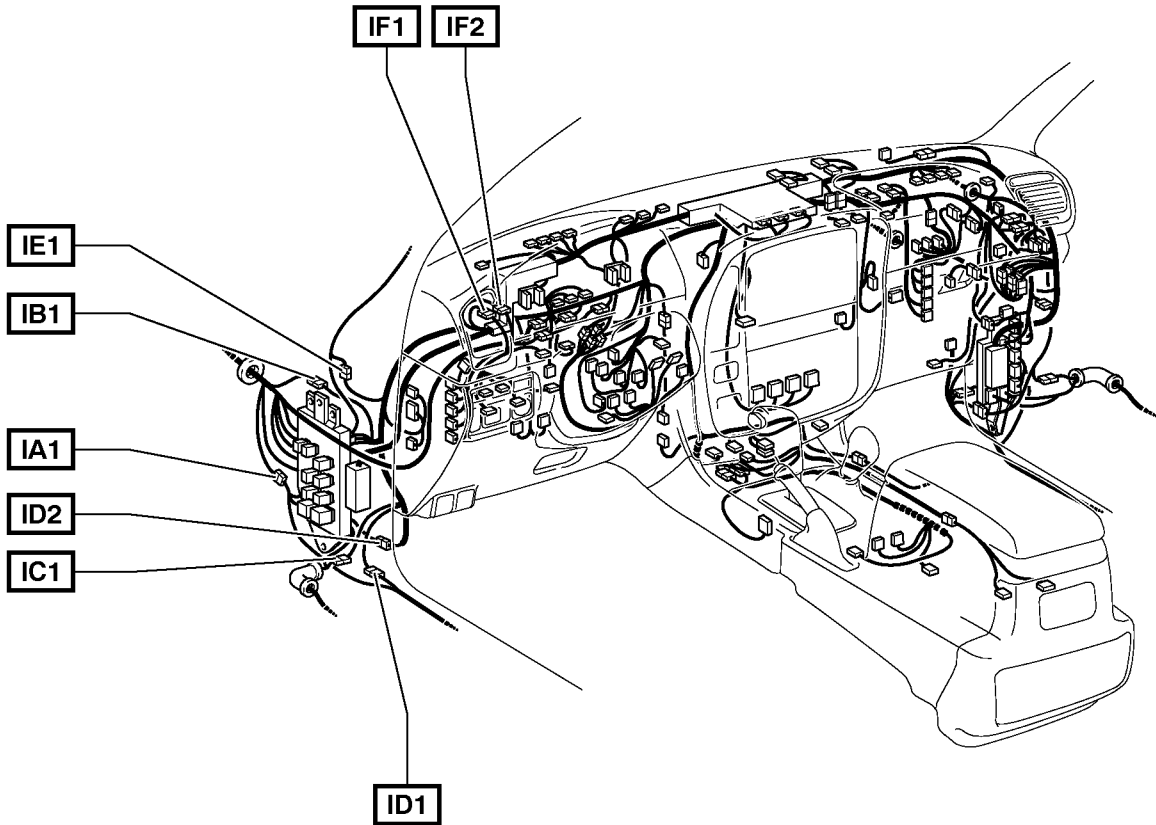

▽ : Location of Ground Points

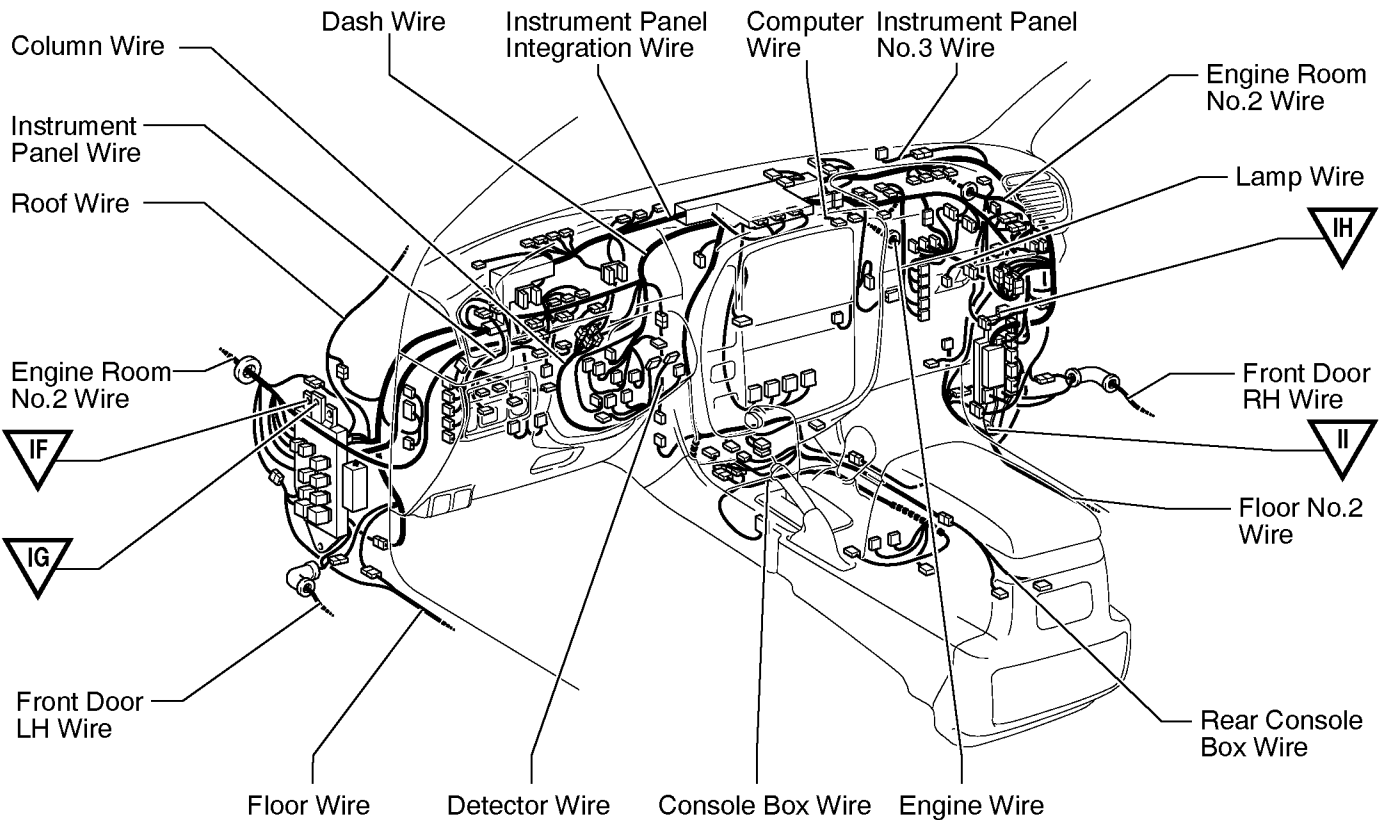

# IGNITION

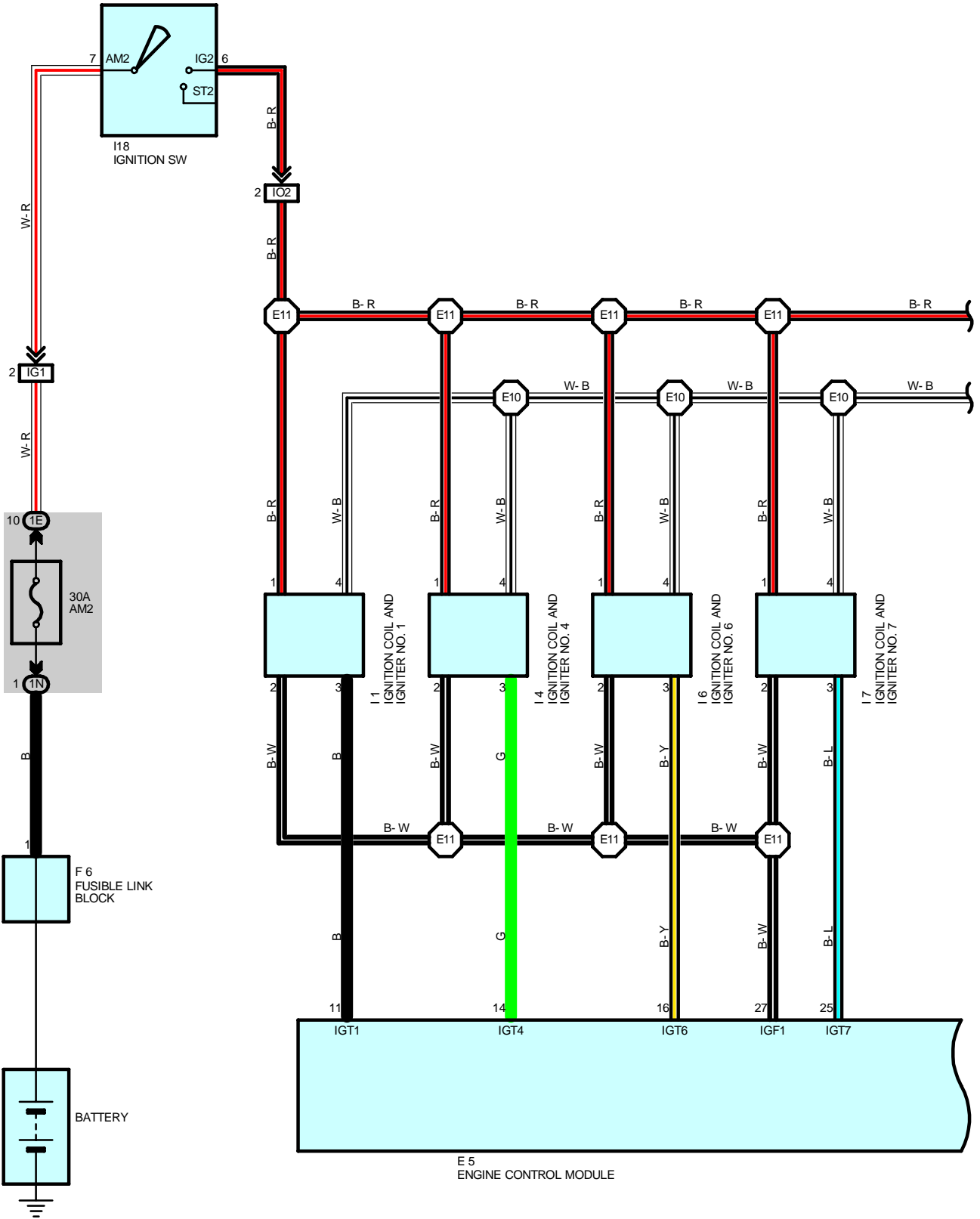

**SERVICE HINTS****FR FOG RELAY**

5-3 : Closed with light control SW at **HEAD** position, dimmer SW at **LOW** position and fog SW at **ON** position

 : **PARTS LOCATION**

Code	See Page	Code	See Page	Code	See Page
C16	40	F2	38		
F1	38	J19	41		

 : **JUNCTION BLOCK AND WIRE HARNESS CONNECTOR**

Code	See Page	Junction Block and Wire Harness (Connector Location)
1A	23	Engine Room No.2 Wire and Engine Room J/B (Engine Compartment Left)
1C		
1E		
1H	23	Engine Room Main Wire and Engine Room J/B (Engine Compartment Left)
1J		
2F	26	Engine Room No.2 Wire and Cowl Side J/B LH (Left Kick Panel)
2J		
2P	28	Instrument Panel Integration Wire and Cowl Side J/B LH (Left Kick Panel)

 : **CONNECTOR JOINING WIRE HARNESS AND WIRE HARNESS**

Code	See Page	Joining Wire Harness and Wire Harness (Connector Location)
IH1	50	Instrument Panel Integration Wire and Column Wire (Near the Ignition SW)

 : **GROUND POINTS**

Code	See Page	Ground Points Location
EA	46	Front Right Side of Fender Apron
EB		
IF	48	Set Bolt of Cowl Side J/B LH

 : **SPLICE POINTS**

Code	See Page	Wire Harness with Splice Points	Code	See Page	Wire Harness with Splice Points
E2	46	Engine Room Main Wire			

 : PARTS LOCATION

Code	See Page	Code	See Page	Code	See Page
B2	42	D19	42	J15	41
B3	42	D21	42	J17	41
C12	A 40	D22	42	J19	41
C15	D 40	F10	42	J27	41
D10	42	F11	42	J29	41
D11	42	I17	40	J32	42
D12	42	I19	A 40	J33	42
D13	42	I20	B 40	J34	42
D14	42	I21	C 40	R27	43
D15	42	J9	41	V6	43
D16	42	J10	41	V7	43
D17	42	J12	41	W3	41
D18	42	J14	41		

 : JUNCTION BLOCK AND WIRE HARNESS CONNECTOR

Code	See Page	Junction Block and Wire Harness (Connector Location)
1D	23	Engine Room No.2 Wire and Engine Room J/B (Engine Compartment Left)
2A	26	Roof Wire and Cowl Side J/B LH (Left Kick Panel)
2E	26	Engine Room No.2 Wire and Cowl Side J/B LH (Left Kick Panel)
2L	26	Front Door LH Wire and Cowl Side J/B LH (Left Kick Panel)
2M		
2N	26	Floor Wire and Cowl Side J/B LH (Left Kick Panel)
2O		
2P	28	Instrument Panel Integration Wire and Cowl Side J/B LH (Left Kick Panel)
3A	32	Engine Room No.2 Wire and Cowl Side J/B RH (Right Kick Panel)
3E	32	Floor No.2 Wire and Cowl Side J/B RH (Right Kick Panel)
3F		
3G	32	Front Door RH Wire and Cowl Side J/B RH (Right Kick Panel)
3I	32	Instrument Panel Integration Wire and Cowl Side J/B RH (Right Kick Panel)

 : CONNECTOR JOINING WIRE HARNESS AND WIRE HARNESS

Code	See Page	Joining Wire Harness and Wire Harness (Connector Location)
IC1	48	Front Door LH Wire and Dash Wire (Left Kick Panel)
IU1	52	Instrument Panel Integration Wire and Dash Wire (Behind the Glove Box)
IU4		
IW1	54	Engine Room No.2 Wire and Dash Wire (Behind the Glove Box)
BA1	56	Rear Door LH Wire and Floor Wire (Left Side of Center Pillar)
BC1	56	Rear Door RH Wire and Floor No.2 Wire (Right Side of Center Pillar)
BH1	58	Pillar No.1 Wire and Back Door Upper Wire (Left Side of Back Door)
BP1	58	Pillar No.1 Wire and Floor Wire (Left Rear Side Quarter Panel)
BQ1	58	Back Door Lower Wire and Floor Wire (Left Rear Side Quarter Panel)

 : GROUND POINTS

Code	See Page	Ground Points Location
IF	48	Set Bolt of Cowl Side J/B LH
IH	48	Set Bolt of Cowl Side J/B RH
II		
BM	56	Left Rear Side Quarter Panel

---

**SERVICE HINTS****C10 CIGARETTE LIGHTER**2-GROUND : Approx. **12** volts with ignition SW at **ACC** or **ON** position

1-GROUND : Always continuity

 **: PARTS LOCATION**

Code	See Page	Code	See Page	Code	See Page
C10	40				

 **: JUNCTION BLOCK AND WIRE HARNESS CONNECTOR**

Code	See Page	Junction Block and Wire Harness (Connector Location)
2B	26	Dash Wire and Cowl Side J/B LH (Left Kick Panel)
2D		

 **: GROUND POINTS**

Code	See Page	Ground Points Location
IF	48	Set Bolt of Cowl Side J/B LH

FROM POWER SOURCE SYSTEM (SEE PAGE 64)

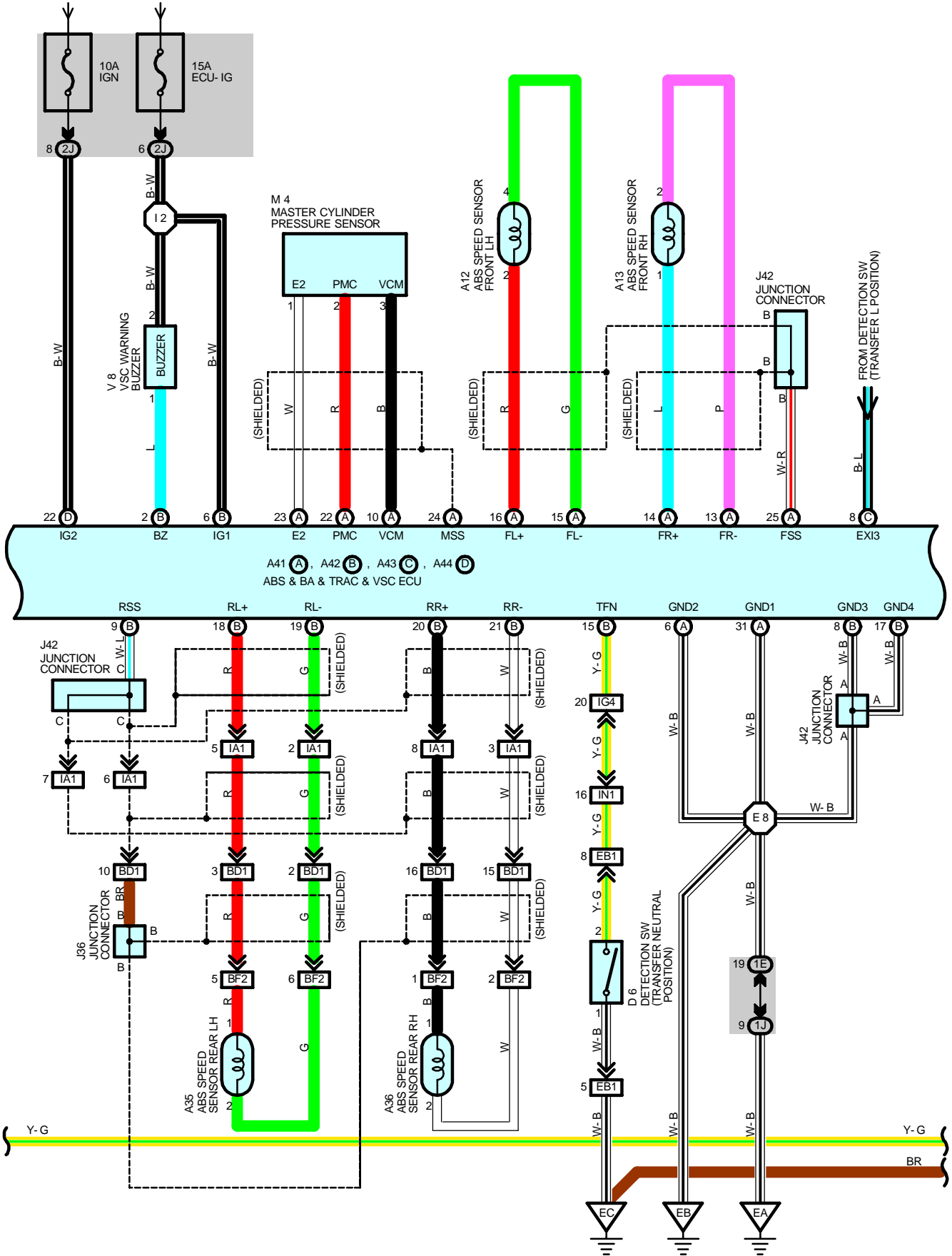



# POWER WINDOW

P12 (A), P13 (B)  
POWER WINDOW MASTER SW

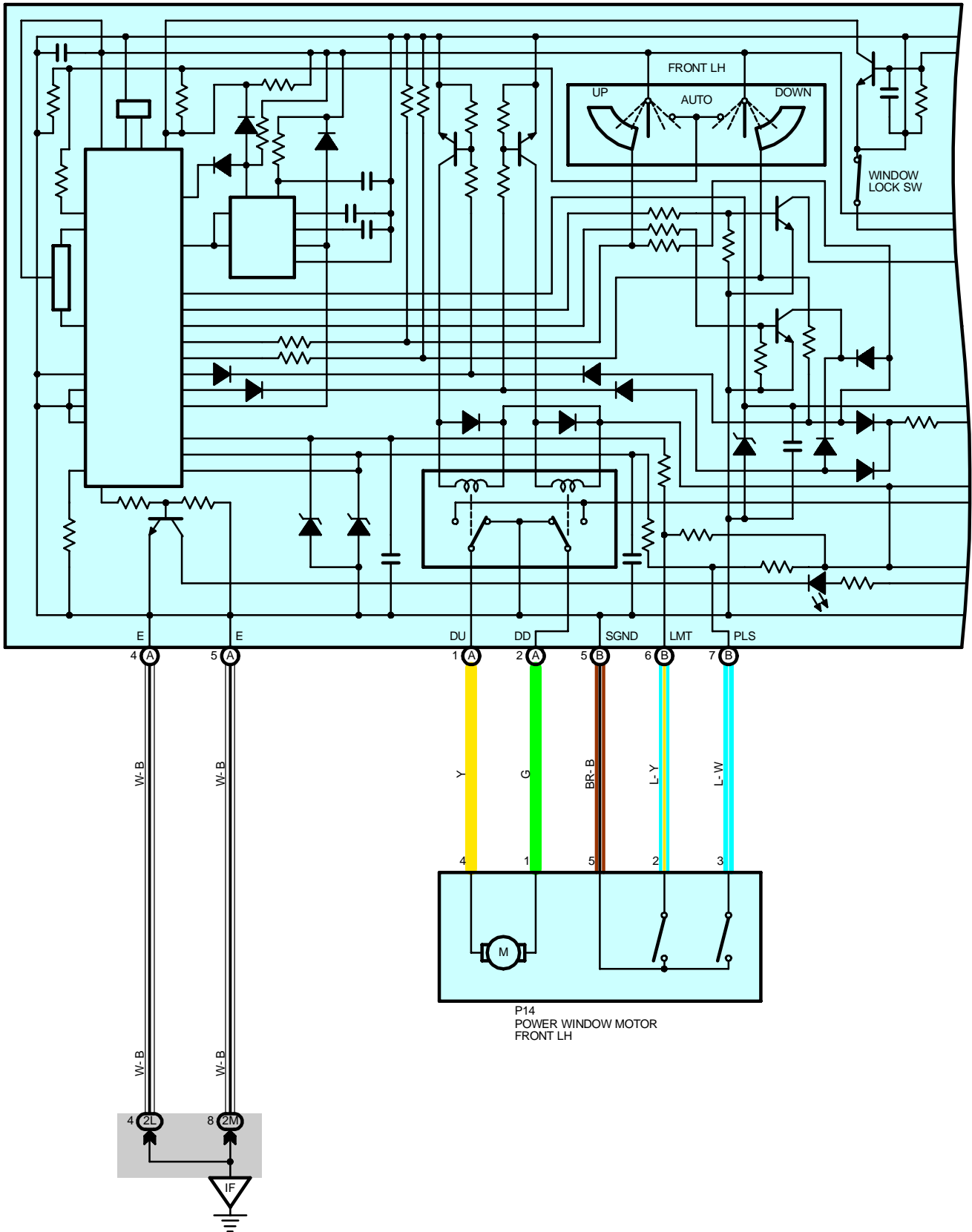

# WIRELESS DOOR LOCK CONTROL

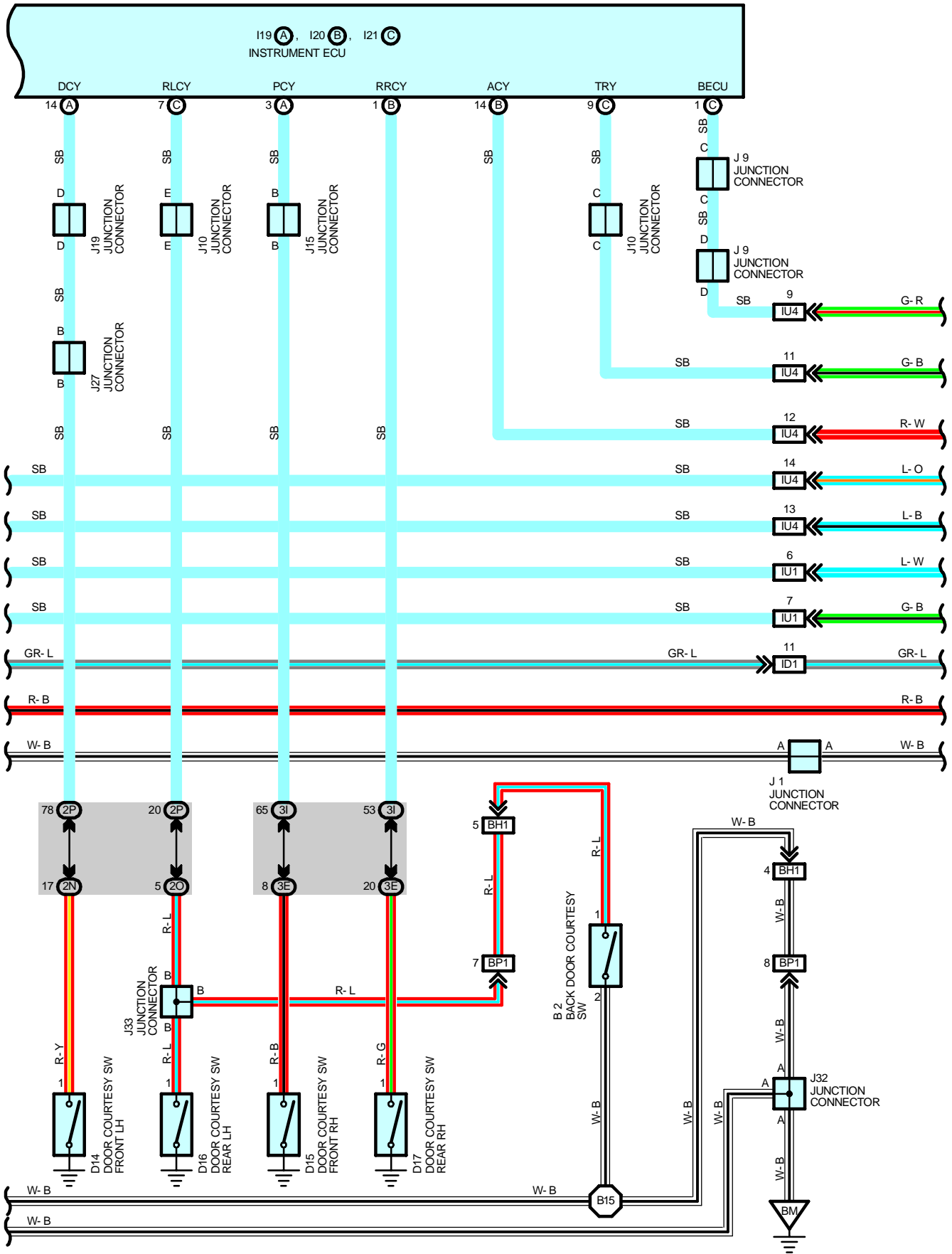

# POWER TILT AND POWER TELESCOPIC

## SYSTEM OUTLINE

This system provides the automatic tilt and telescopic mechanisms using the motor drive, tilt and telescopic ECU control, allowing variable steering movement in the back and forth, and vertical directions. This makes it possible to set the steering to the desired steering position.

### 1. MANUAL OPERATION

The tilt and telescopic can be adjusted while the ignition key is inserted into the key cylinder.

#### \* Tilt operation

When the tilt and telescopic SW is pressed to TILT DOWN position, the current flows from tilt and telescopic ECU TERMINAL (A) 2 to tilt and telescopic SW TERMINAL 9 to TERMINAL 4 to tilt and telescopic ECU TERMINAL (A) 5, and a signal is input to the tilt and telescopic ECU. This activates the tilt and telescopic ECU and rotates the tilt motor to lower the steering while the tilt and telescopic SW is kept pressed to TILT DOWN position.

When the tilt and telescopic SW is pressed to TILT UP position, the current flows from tilt and telescopic ECU TERMINAL (A) 2 to tilt and telescopic SW TERMINAL 9 to TERMINAL 4 to tilt and telescopic ECU TERMINAL (A) 5, and a signal is input to the tilt and telescopic ECU. This activates the tilt and telescopic ECU and rotates the tilt motor to raise the steering while the tilt and telescopic SW is kept pressed to TILT UP position.

#### \* Telescopic operation

When the tilt and telescopic SW is pressed to TELESCO LONG position, the current flows from tilt and telescopic ECU TERMINAL (A) 2 to tilt and telescopic SW TERMINAL 9 to TERMINAL 4 to tilt and telescopic ECU TERMINAL (A) 5, and a signal is input to the tilt and telescopic ECU. This activates the tilt and telescopic ECU and rotates the telescopic motor to extend the telescopic while the tilt and telescopic SW is kept pressed to TELESCO LONG position.

When the tilt and telescopic SW is pressed to TELESCO SHORT position, the current flows from tilt and telescopic ECU TERMINAL (A) 2 to tilt and telescopic SW TERMINAL 9 to TERMINAL 4 to tilt and telescopic ECU TERMINAL (A) 5, and a signal is input to the tilt and telescopic ECU. This activates the tilt and telescopic ECU and rotates the telescopic motor to retract the telescopic while the tilt and telescopic SW is kept pressed to TELESCO SHORT position.

## SERVICE HINTS

### T7 (A), T8 (B) TILT AND TELESCOPIC ECU

- (A) 1-GROUND : Always approx. **12** volts
- (B) 4-GROUND : Always approx. **12** volts
- (A) 4-GROUND : Approx. **12** volts with ignition SW at **ON** or **ST** position
- (A) 6-GROUND : Always continuity

### C17 TILT AND TELESCOPIC SW [COMB. SW]

- 4-9 : Approx. **160** Ω with telescopic long operation
- : Approx. **360** Ω with tilt up operation
- : Approx. **790** Ω with telescopic short operation
- : Approx. **1.99** kΩ with tilt down operation

## ○ : PARTS LOCATION

Code	See Page	Code	See Page	Code	See Page
C17	40	M2	42	T8   B	41
J1	41	T4	41	T9	41
J22	41	T7   A	41		

## ○ : JUNCTION BLOCK AND WIRE HARNESS CONNECTOR

Code	See Page	Junction Block and Wire Harness (Connector Location)
2B	26	Dash Wire and Cowl Side J/B LH (Left Kick Panel)

## □ : CONNECTOR JOINING WIRE HARNESS AND WIRE HARNESS

Code	See Page	Joining Wire Harness and Wire Harness (Connector Location)
IE1	48	Dash Wire and Roof Wire (Left Kick Panel)
II2	50	Column Wire and Dash Wire (Near the Ignition SW)

## ▽ : GROUND POINTS

Code	See Page	Ground Points Location
IF	48	Set Bolt of Cowl Side J/B LH

# REAR HEATER (w/o REAR AIR CONDITIONING)

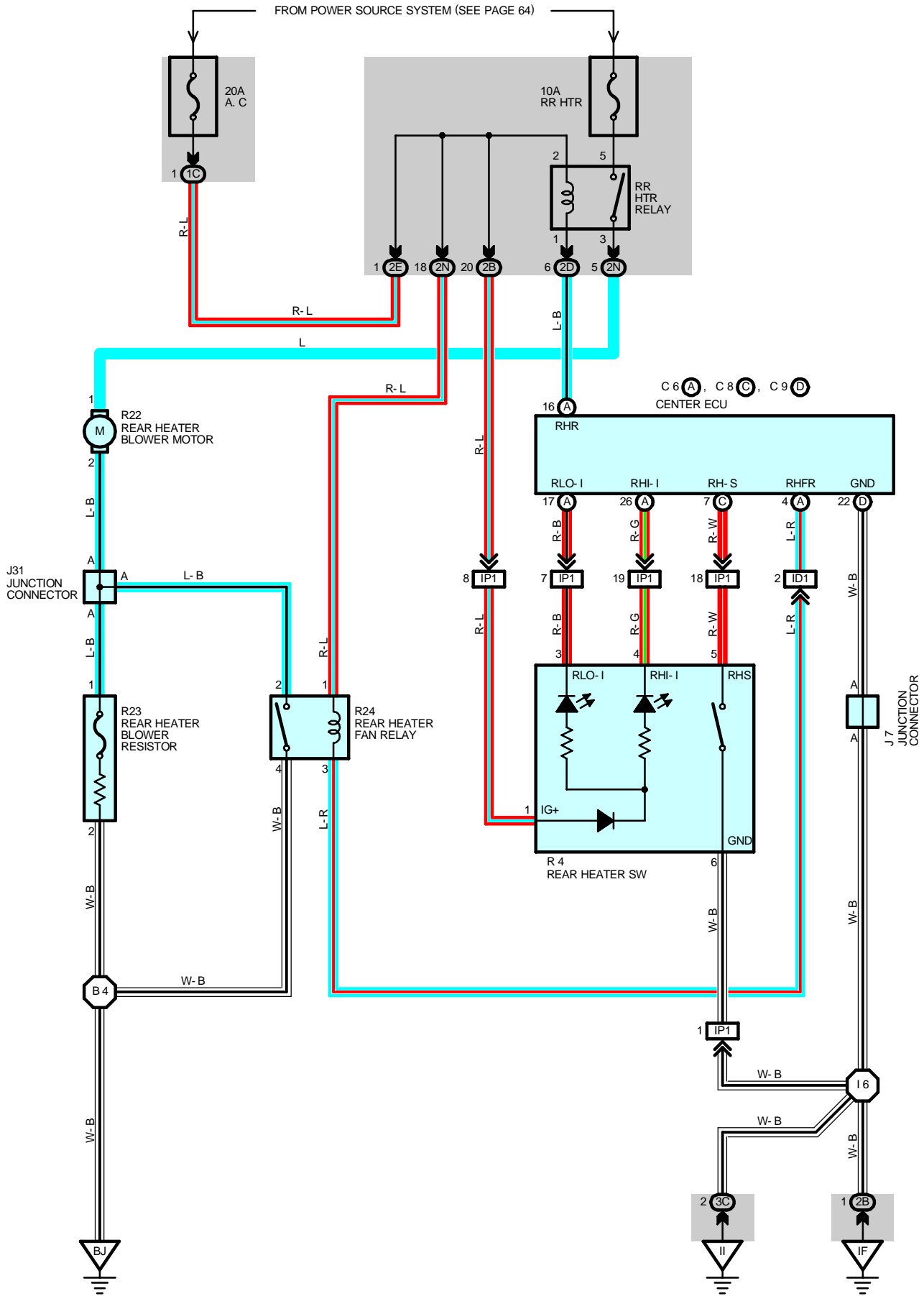

## J POWER SOURCE (Current Flow Chart)

Fuse		System	Page
15A	ECU-IG	Interior Light	106
		Light Auto Turn Off	122
		Moon Roof	190
		Power Tilt and Power Telescopic	220
		Power Window	184
		Shift Lock	174
		Theft Deterrent	210
		VSC	156
		Wireless Door Lock Control	200
15A	FR FOG	Front Fog Light	92
15A	GAUGE	ABS	164
		Back-Up Light	116
		Center Differential Lock	176
		Charging	74
		Combination Meter	242
		Cruise Control	150
		Electronically Controlled Transmission and A/T Indicator	142
		Engine Control and Engine Immobiliser System	76
		Headlight	86
		Key Reminder and Seat Belt Warning	232
		Power Rear Quarter Window	226
		Rear Differential Lock	180
		Rear Window Defogger and Mirror Heater	230
VSC	156		
Wireless Door Lock Control	200		
15A	PWR OUTLET	Power Outlet	138
15A	SRS	SRS	169
15A	STOP	ABS	164
		Cruise Control	150
		Electronically Controlled Transmission and A/T Indicator	142
		Engine Control and Engine Immobiliser System	76
		Shift Lock	174
		Stop Light	114
VSC	156		
15A	TAIL	Automatic Light Control	118
		Illumination	102
		Light Auto Turn Off	122
		Taillight	98
		Theft Deterrent	210
		Wireless Door Lock Control	200
20A	AHC-IG	VSC	156
20A	DEFOG	Rear Window Defogger and Mirror Heater	230
20A	DIFF	Center Differential Lock	176
		Rear Differential Lock	180

\* These are the page numbers of the first page on which the related system is shown.

