

SYSTEM INDEX

GENERAL INFORMATION	Z-2	INTERIOR LIGHTING SYSTEM	
GROUND POINT	Z-12	CARGO COMPARTMENT LIGHT	Z-98
ELECTRICAL WIRING SCHEMATIC	Z-16	TRUNK COMPARTMENT LIGHT	Z-98
ENGINE-RELATED SYSTEM		ILLUMINATION LIGHT	Z-100
CHARGING SYSTEM		INTERIOR LIGHT	Z-104
EXCEPT FS	Z-18	MAP LIGHT	Z-104
FS	Z-20	EXTERIOR LIGHTING SYSTEM	
STARTING SYSTEM		HEADLIGHT	Z-78
EXCEPT FS	Z-18	LICENSE PLATE LIGHT	Z-80
FS	Z-20	PARKING LIGHT	Z-80
ENGINE CONTROL SYSTEM		TAILLIGHT	Z-80
B3	Z-22	FRONT FOG LIGHT	Z-82
“ZL EXCEPT HONG KONG”, ZM	Z-28	TURN AND HAZARD WARNING LIGHT	Z-84
FP	Z-36	BACK-UP LIGHT	Z-86
FS	Z-44	BRAKE LIGHT	Z-88
ZL FOR HONG KONG	Z-54	HIGH-MOUNT BRAKE LIGHT	Z-88
IGNITION SYSTEM		AIR CONDITIONING-RELATED SYSTEM	
B3	Z-22	CONDENSER FAN SYSTEM	Z-90
“ZL EXCEPT HONG KONG”, ZM	Z-28	HEATER AND AIR CONDITIONER	
FP	Z-36	MANUAL	Z-92
FS	Z-44	AUTO	Z-94
ZL FOR HONG KONG	Z-54	ACCESSORY	
FUEL CONTROL SYSTEM	Z-64	CIGARETTE LIGHTER	Z-98
COOLING FAN SYSTEM	Z-66	AUDIO SYSTEM	Z-108
CHASSIS-RELATED SYSTEM		OTHER	
EC-AT CONTROL SYSTEM		DATA LINK CONNECTOR	Z-132
“ZL EXCEPT HONG KONG”, ZM	Z-28	COMMON CONNECTOR LIST	Z-134
FP	Z-36	JOINT BOX	
FS	Z-44	COMPLETE WIRING SYSTEM	Z-140
ZL FOR HONG KONG	Z-54	FUSE BLOCK	
ANTILOCK BRAKE SYSTEM	Z-122	COMPLETE WIRING SYSTEM	Z-142
INSTRUMENT CLUSTER-RELATED SYSTEM		PARTS INDEX	Z-144
INSTRUMENT CLUSTER	Z-68		
BODY-RELATED SYSTEM			
WINDSHIELD WIPER AND WASHER	Z-74		
REAR WIPER AND WASHER	Z-76		
HORN	Z-88		
REAR WINDOW DEFROSTER	Z-98		
KEYLESS UNIT	Z-106		
POWER WINDOW SYSTEM	Z-110		
POWER DOOR LOCK SYSTEM	Z-112		
POWER OUTSIDE MIRROR	Z-116		
RETRACTABLE OUTSIDE MIRROR	Z-116		
SLIDING SUNROOF			
5HB	Z-118		
4SD	Z-120		
AIR BAG SYSTEM SERVICE CAUTIONS /			
SERVICE WARNINGS	Z-124		
AIR BAG SYSTEM	Z-126		
IMMOBILIZER SYSTEM	Z-130		

Routing diagram

- The routing diagram shows where electrical components are on the system circuit diagram by call out line and connector symbols.

Connector symbol

Shows the system that uses the connector.

(Example)

Connector	Symbol
Common connectors	X-19
System connectors	I-03

Component name

Shows the names of components in routing diagrams.







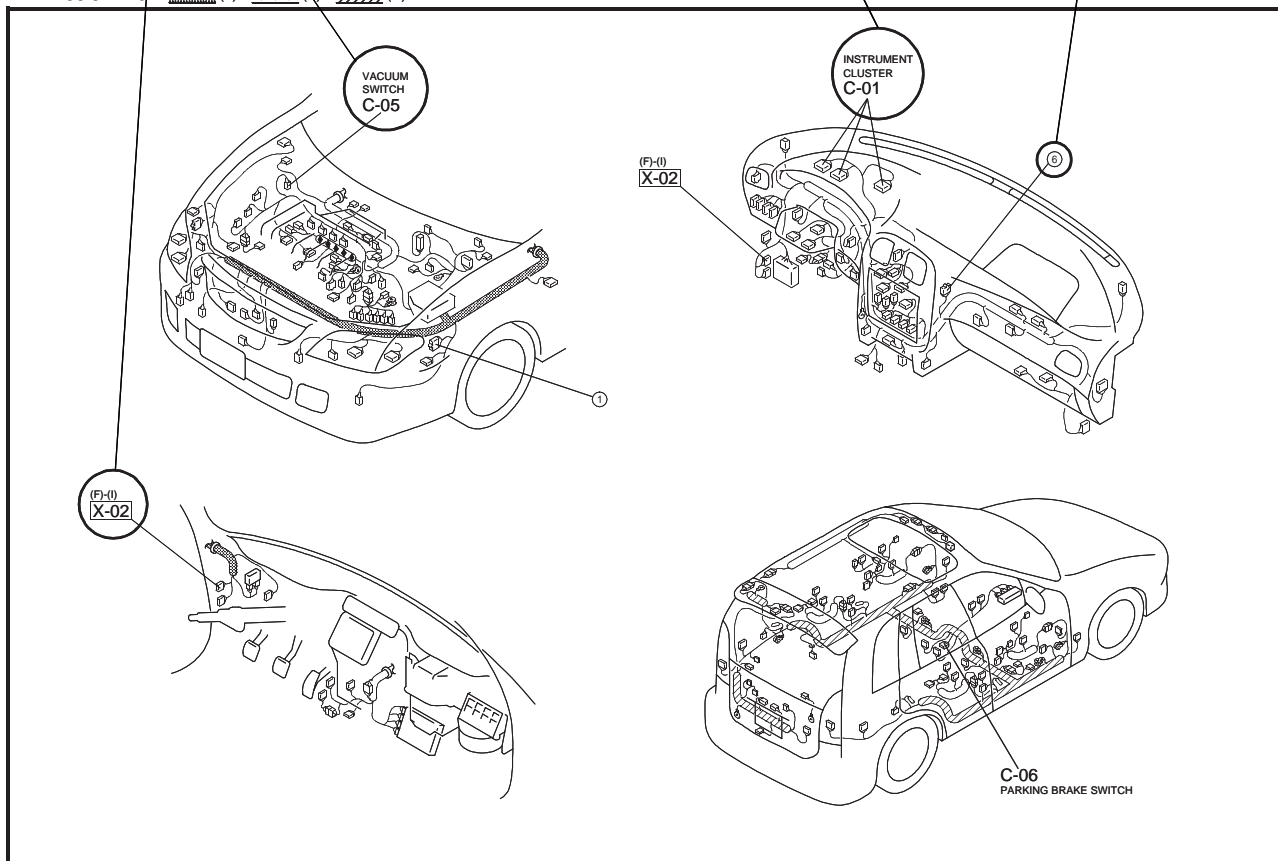



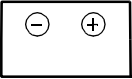

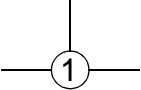
Ground symbol

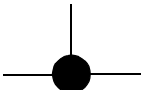
Shows the ground in system diagrams.

HARNESS SYMBOL :  (F)  (E)  (R)

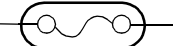
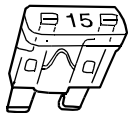
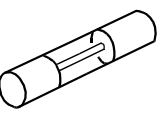

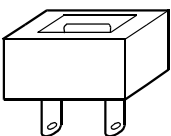
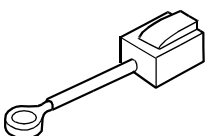
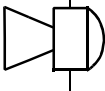
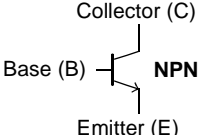
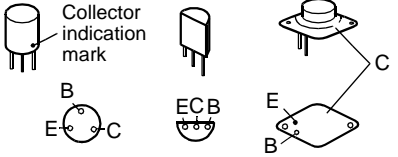
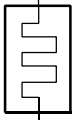
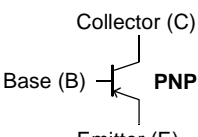
Symbols

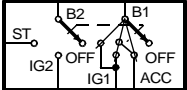
Symbol	Meaning	Symbol	Meaning	
<p>Battery</p> 	<ul style="list-style-type: none"> Generates electricity through chemical reaction. Supplies direct current to circuits. 	<p>Light</p> 	<ul style="list-style-type: none"> Emits light and generates heat when current flows through filament. 	
<p>Ground (1)</p> 	<ul style="list-style-type: none"> Connecting point to vehicle body or other ground wire where current flows from positive to negative terminal of battery. Ground (1) indicates a ground point to body through wire harness. Ground (2) indicates point where component is grounded directly to body. 	<p>Resistance</p> 	<ul style="list-style-type: none"> A resistor with a constant value. Mainly used to protect electrical components in circuits by maintaining rated voltage. 	
<p>Ground (2)</p> 		<p>Remarks</p> <ul style="list-style-type: none"> Current will not flow through a circuit if ground is faulty. 	<p>Motor</p> 	<ul style="list-style-type: none"> Converts electrical energy into mechanical energy.
<p>Fuse (1)</p>  <p>(box)</p>	<p>Precautions</p> <ul style="list-style-type: none"> Do not replace with fuses exceeding specified capacity. 	<p>Pump</p> 	<ul style="list-style-type: none"> Pulls in and discharges gases and liquids. 	
<p>Fuse (2)</p>  <p>(Cartridge)</p>		<p><Blade type></p>  <p><Tube type></p> 	<p>Cigarette lighter</p> 	<ul style="list-style-type: none"> Electrical coil that generates heat.
<p>Main fuse/ Fusible link</p> 		<p><Cartridge type></p>  <p><Fusible link></p> 	<p>Horn</p> 	<ul style="list-style-type: none"> Generates sound when current flows.
<p>Transistor (1)</p> 	<ul style="list-style-type: none"> Electrical switching component. Turns on when voltage is applied to the base (B). 	<p>Heater</p> 	<ul style="list-style-type: none"> Generates heat when current flows. 	
<p>Transistor (2)</p> 		<ul style="list-style-type: none"> Reading code. <p>2 S C 828 A — Revision mark</p> <p>Semiconductor Number of terminals</p> <p>A: High-frequency PNP B: Low-frequency PNP C: High-frequency NPN D: Low-frequency NPN</p>	<p>Speed sensor</p> 	<ul style="list-style-type: none"> Movement of magnet in speedometer turns contact within sensor on and off.
		<p>Ignition switch</p> 	<ul style="list-style-type: none"> Turning ignition key switches circuit to operate various component. <p>(NOTE) Ignition switch is called engine switch on diesel vehicles.</p>	

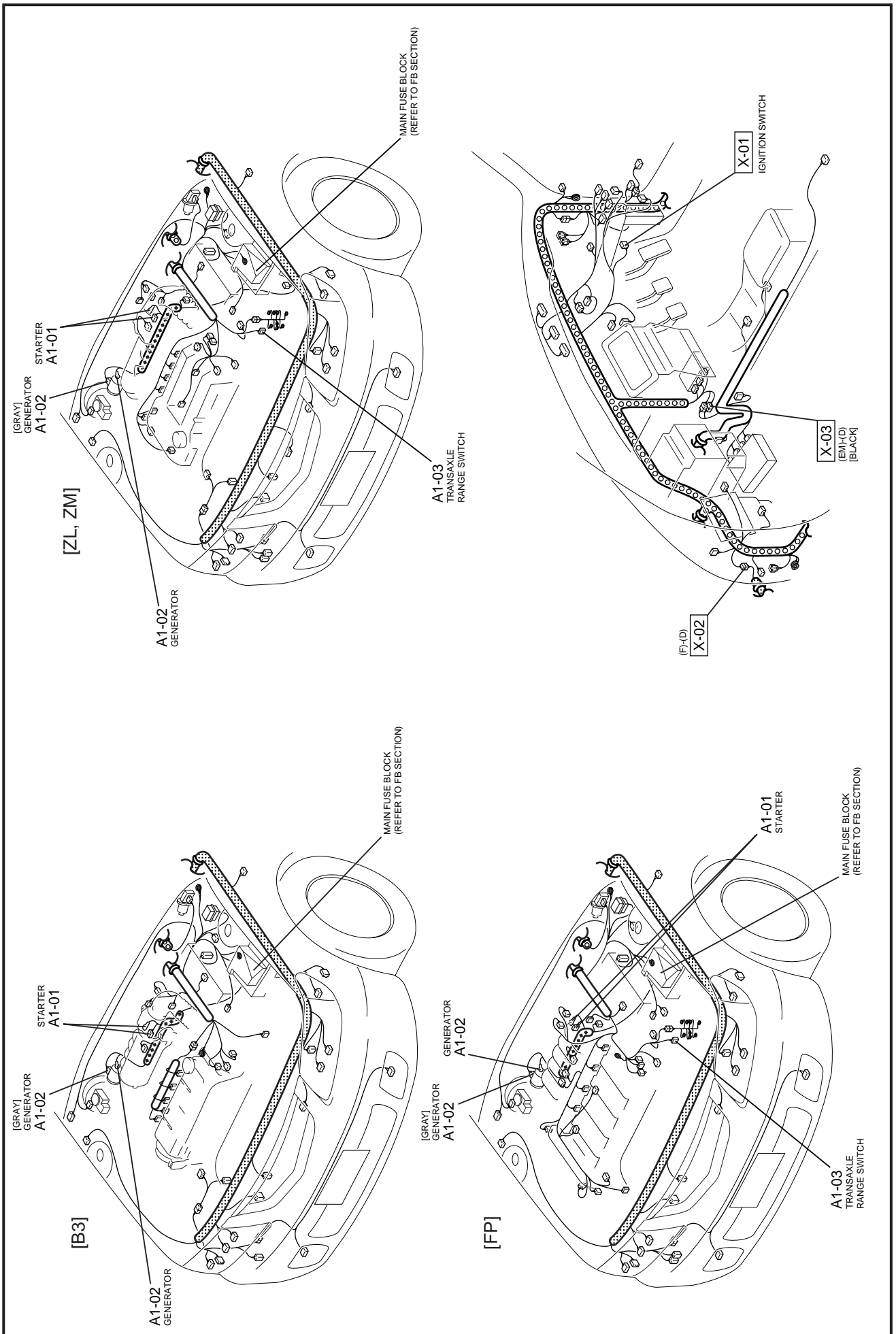

HARNES SYMBOL: [Symbol] (F) [Symbol] (E) [Symbol] (R) [Symbol] (D)

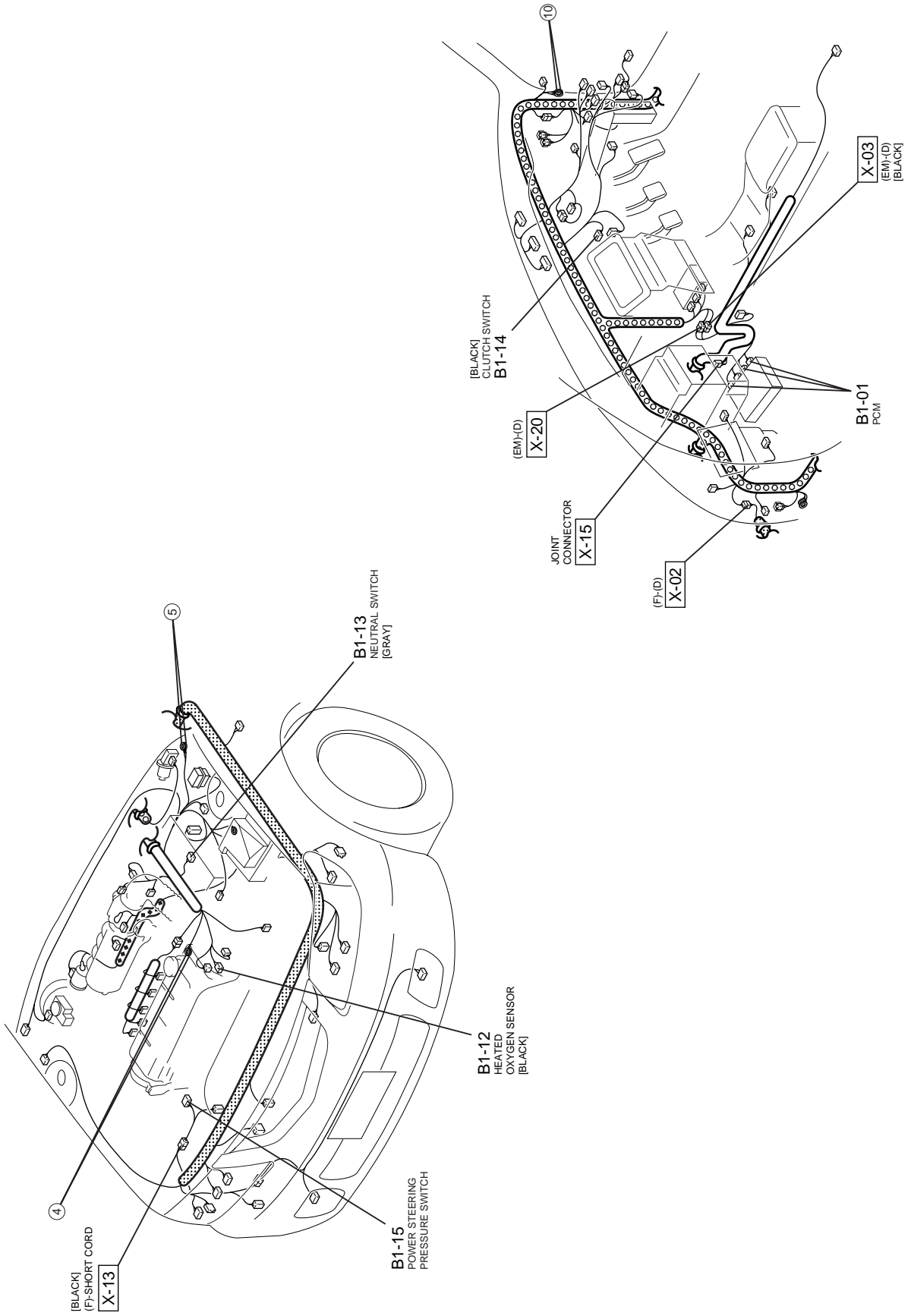

HARNES SYMBOL: [F] [E] [R] [D]

[B3]

[BLACK]
[F]-SHORT CORD
X-13

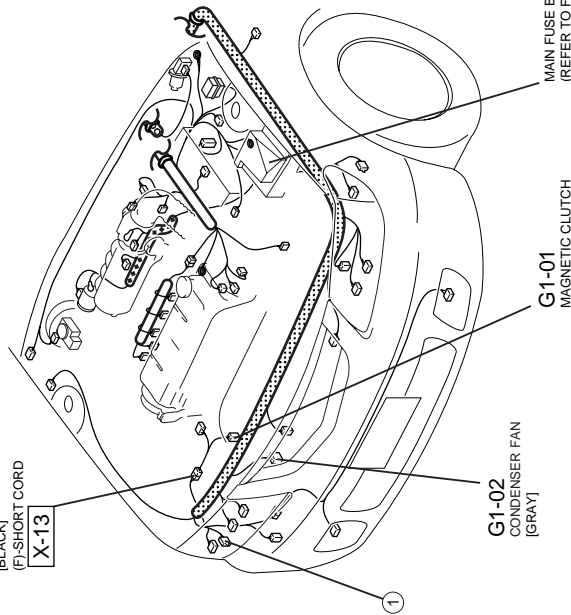

[ZL, ZM]

[BLACK]
[F]-SHORT CORD
X-13

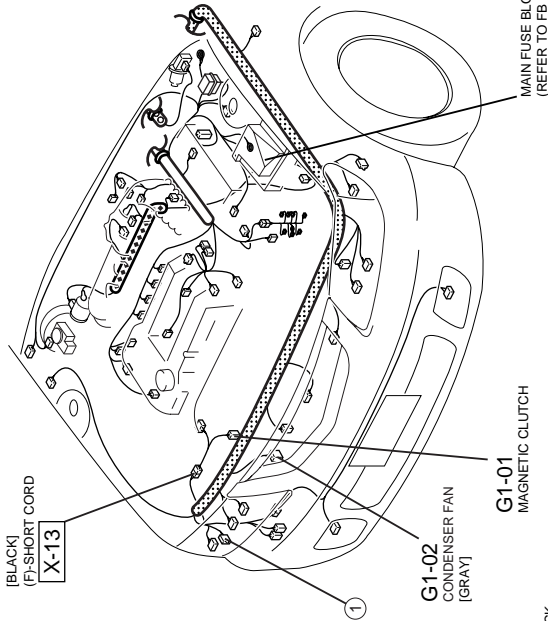

[FP]

MAGNETIC CLUTCH
G1-01

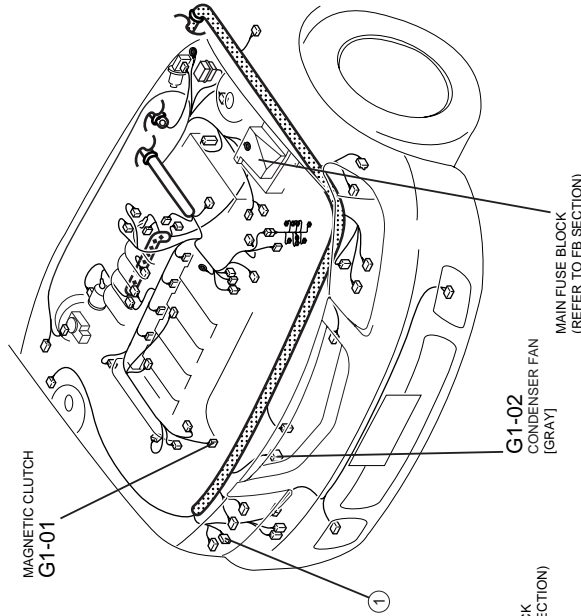

[FS]

MAGNETIC CLUTCH
G1-01

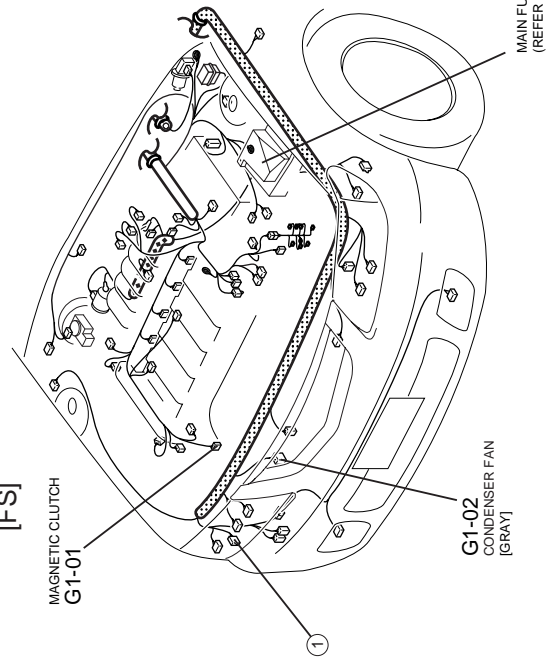

[F-H]
X-02

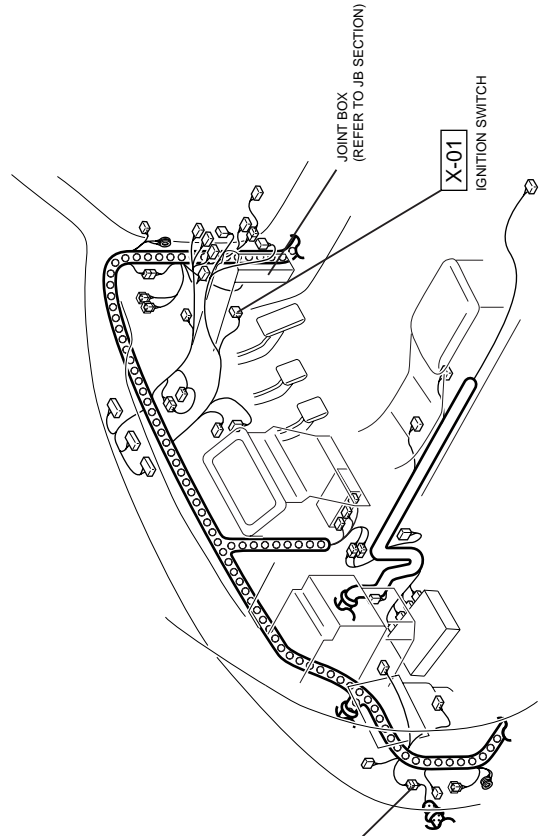

HARNES SYMBOL: [diagonal lines] (F) [diamonds] (E) [hatched] (R) [circles] (D)

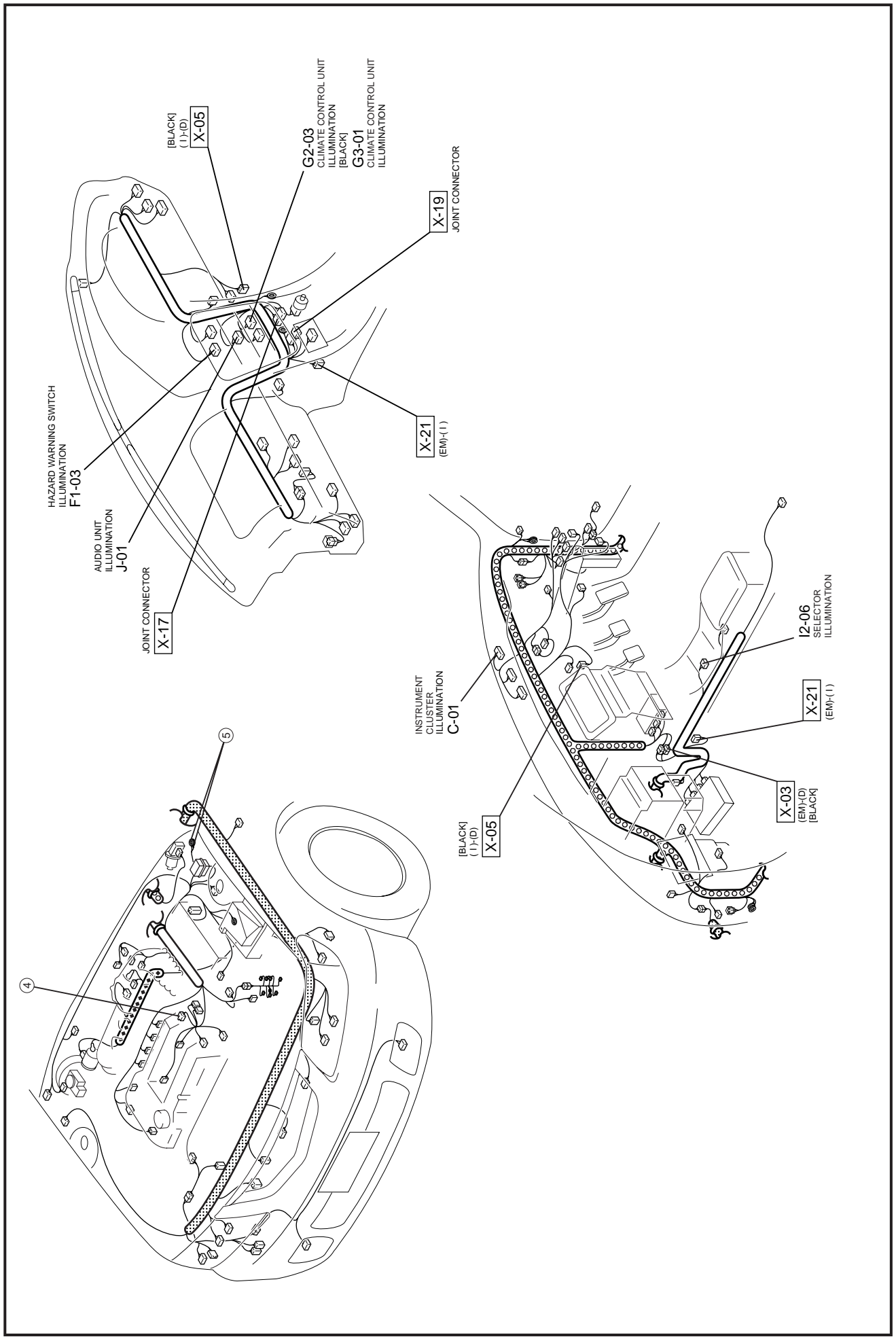

HARNES SYMBOL: (F) (E) (R) (D)

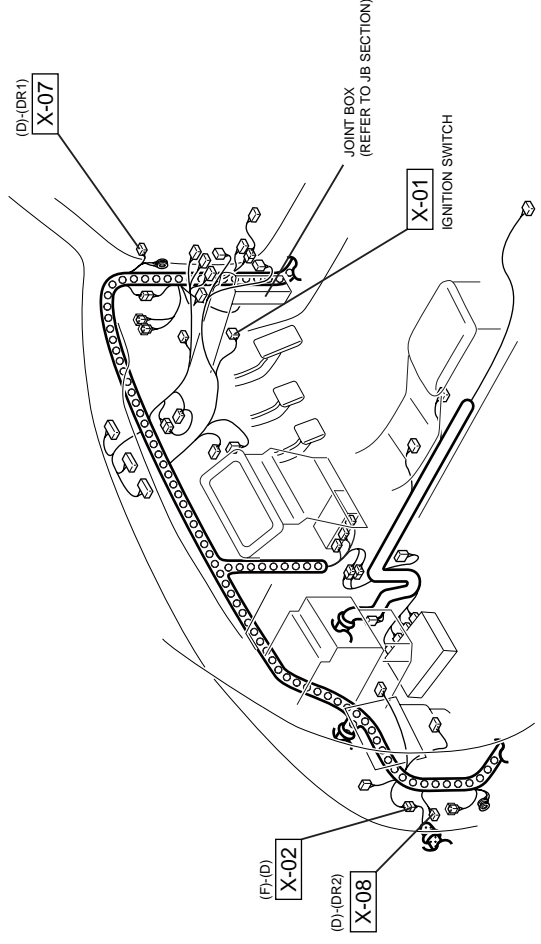
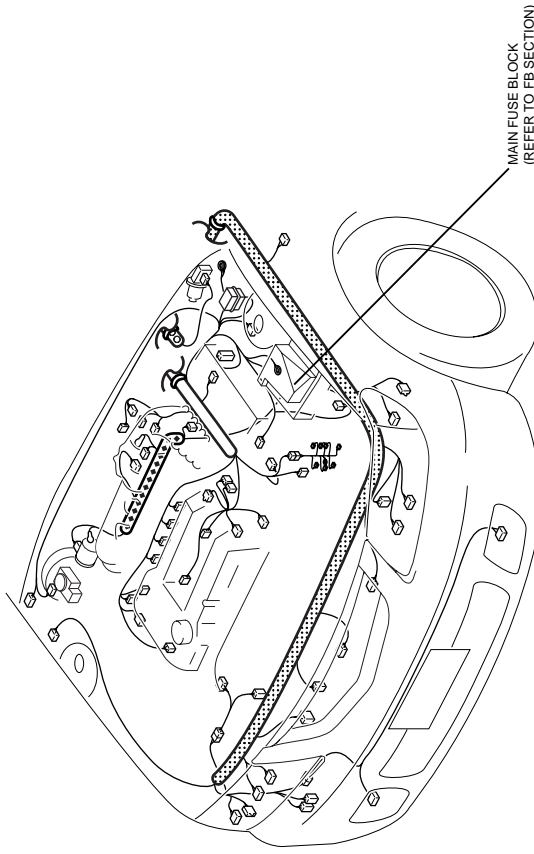
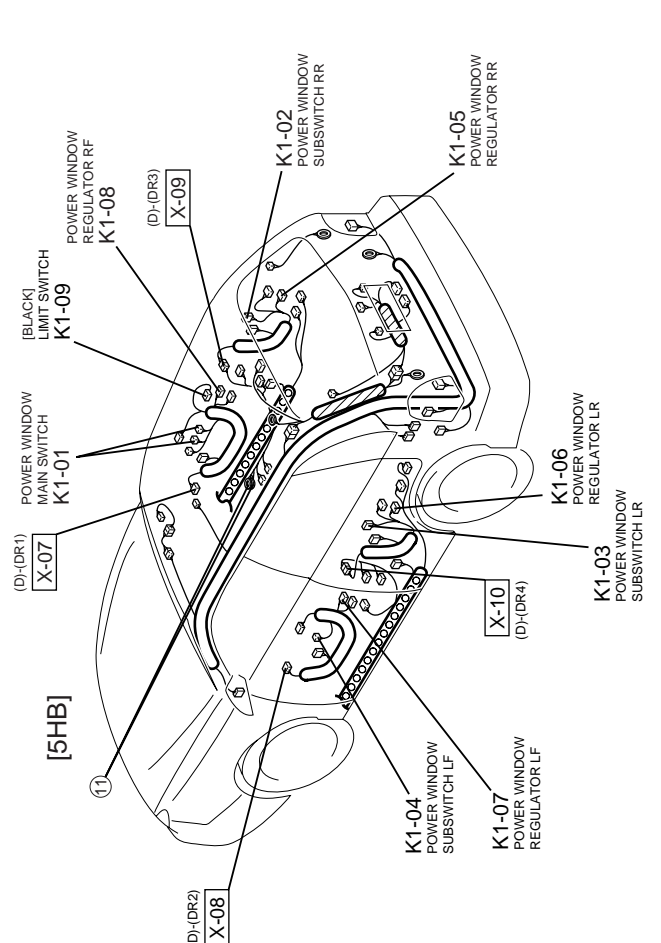
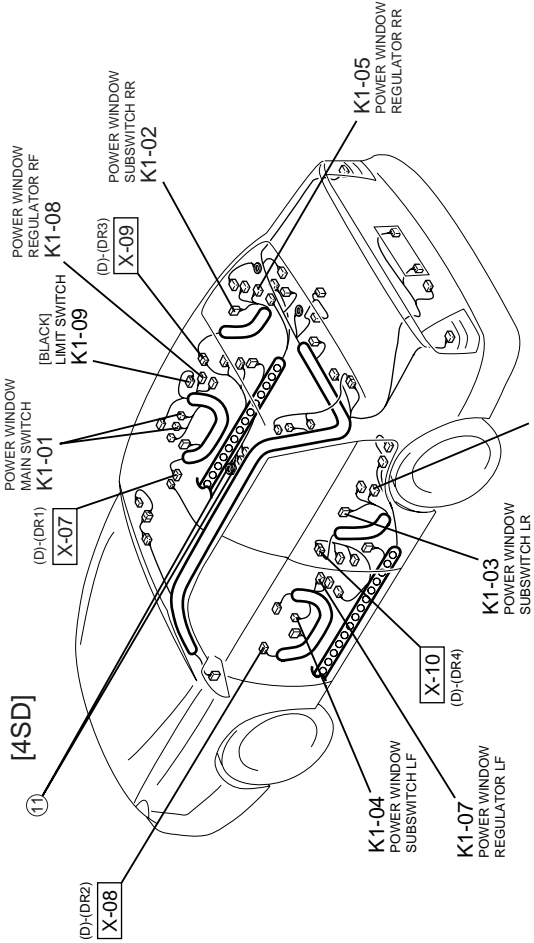

HARNES SYMBOL: [F] [E] [R] [D]

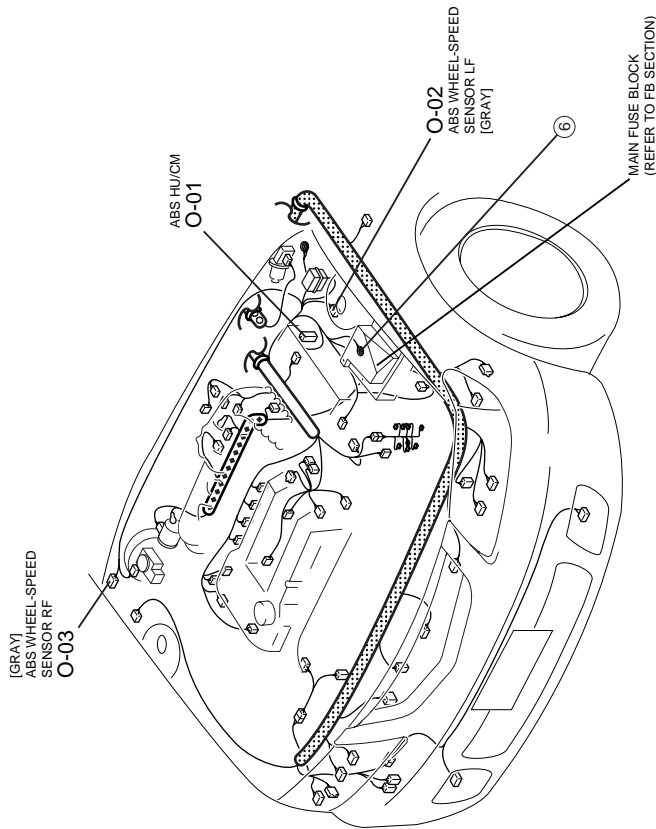

[4SD]

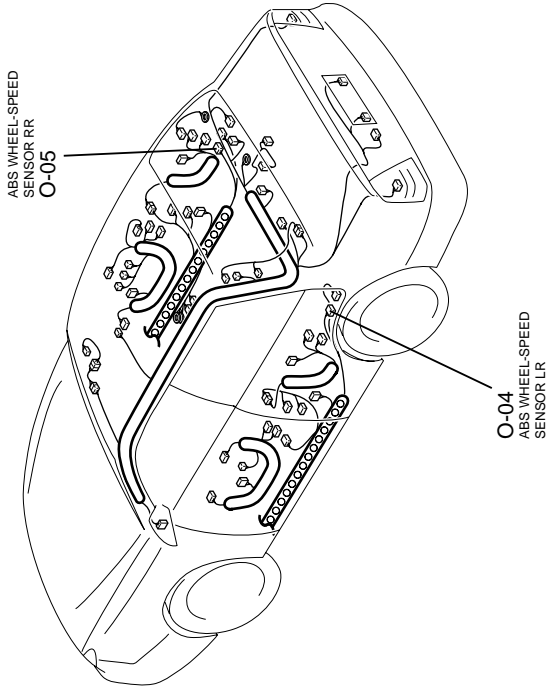

[5HB]

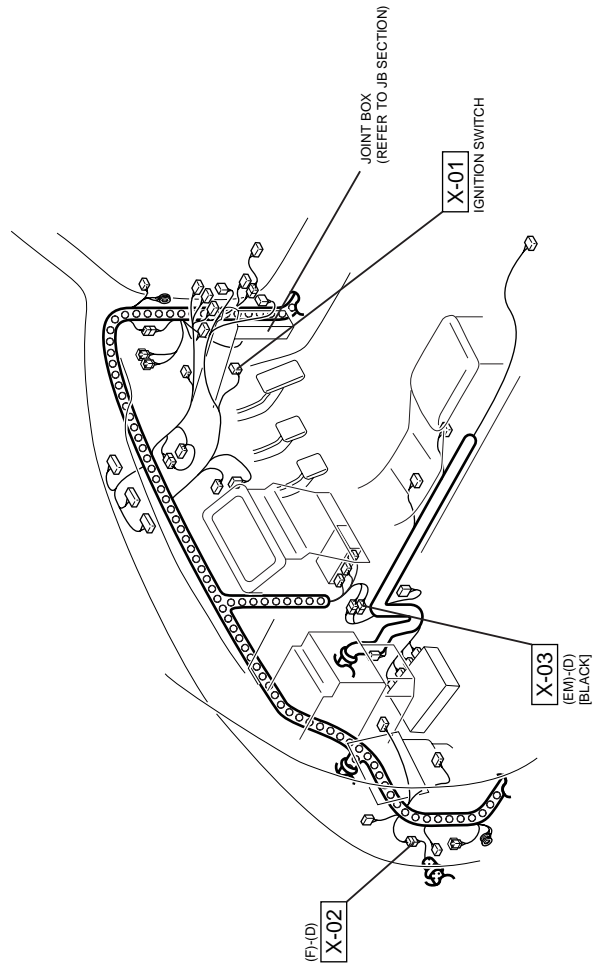
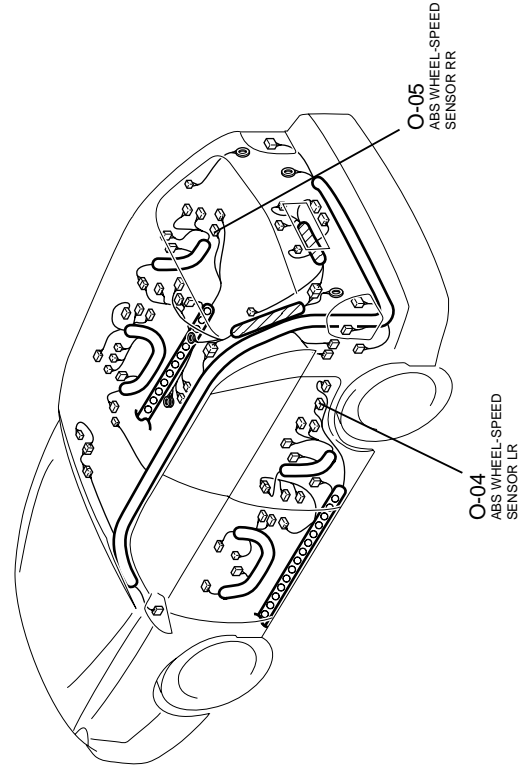

HARNES SYMBOL:  (F)  (E)  (R)  (D)

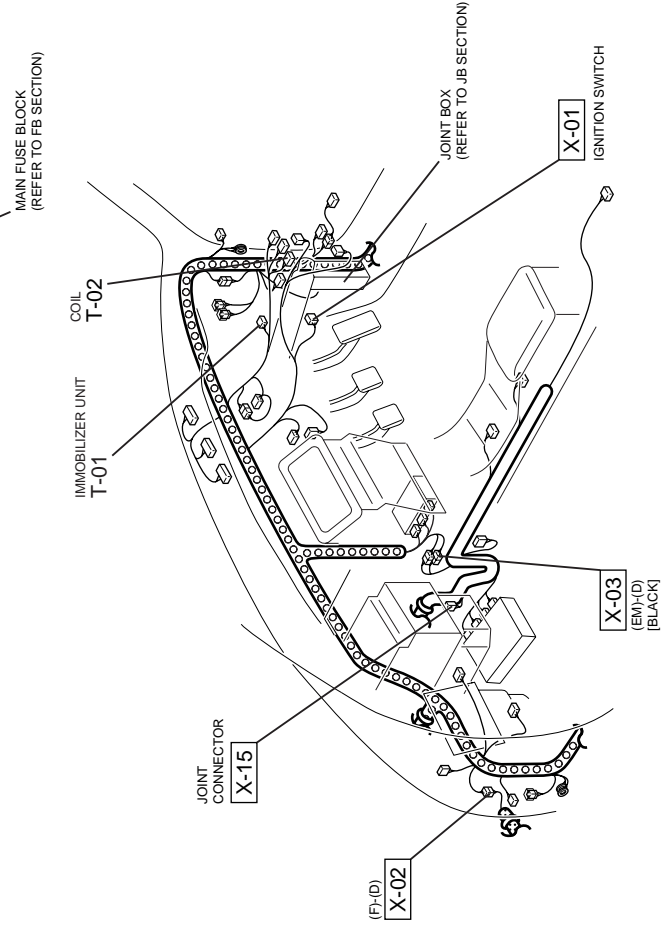
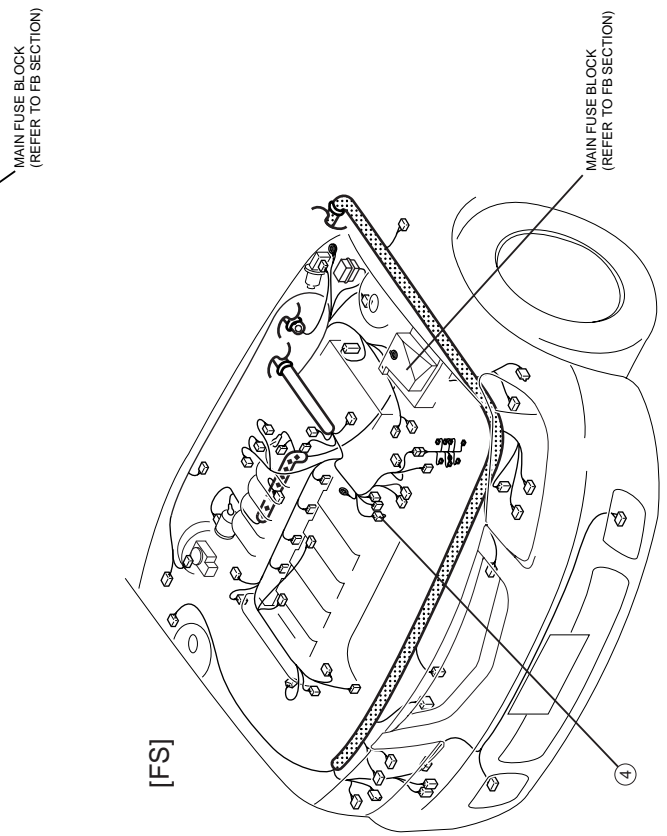
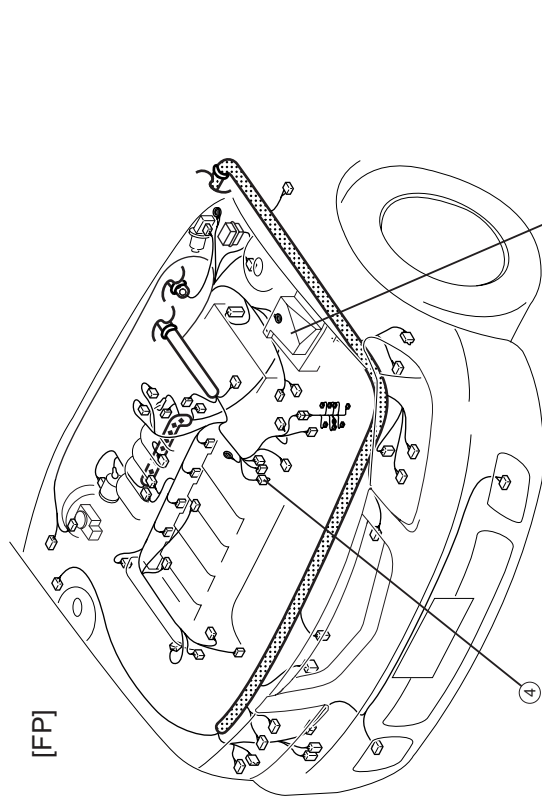
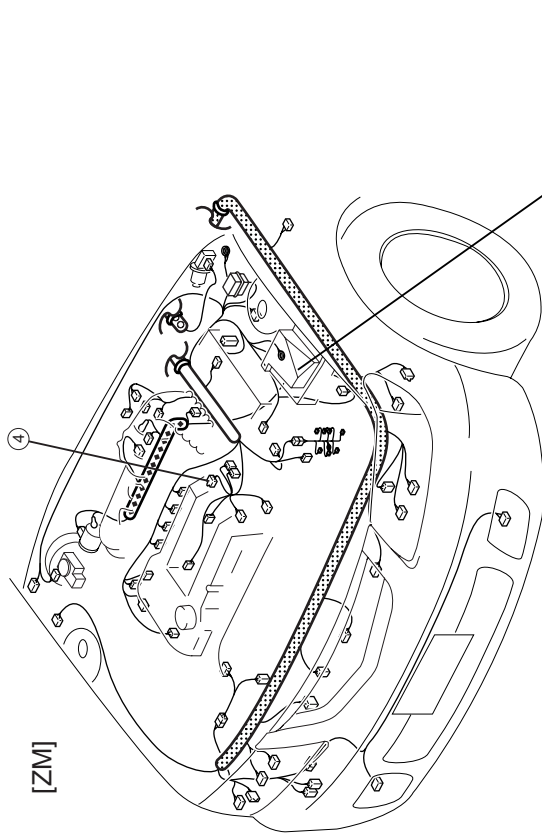

COMMON CONNECTOR LIST

X-3

Z WIRING DIAGRAM

X-07 DASH (D) - DOOR No. 1 (DR1)

@ ... WITH POWER DOOR LOCK SYSTEM
 # ... WITH POWER WINDOW SYSTEM,
 POWER OUTSIDE MIRROR,
 RETRACTABLE OUTSIDE MIRROR
 NOT RECESSED
 < > ... AUSTRALIAN SPECS.
 * ... WITH POWER DOOR LOCK SYSTEM
 WITHOUT POWER WINDOW SYSTEM,
 POWER OUTSIDE MIRROR,
 RETRACTABLE OUTSIDE MIRROR*

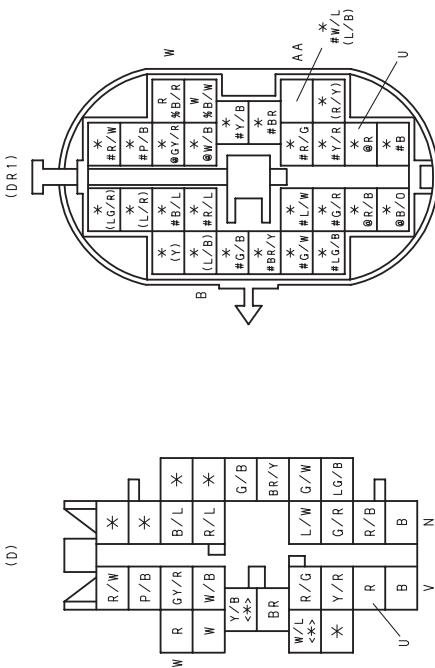

X-08 DASH (D) - DOOR No. 2 (DR2)

... WITH POWER WINDOW SYSTEM,
 POWER OUTSIDE MIRROR,
 RETRACTABLE OUTSIDE MIRROR
 NOT RECESSED
 < > ... AUSTRALIAN SPECS.
 @ ... WITH POWER DOOR LOCK SYSTEM

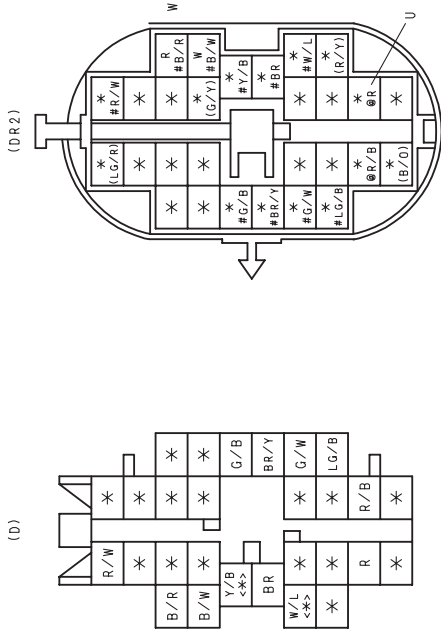

X-09 DASH (D) - DOOR No. 3 (DR3)

() ... 5HB
 # ... WITH POWER WINDOW SYSTEM
 < > ... NOT USED

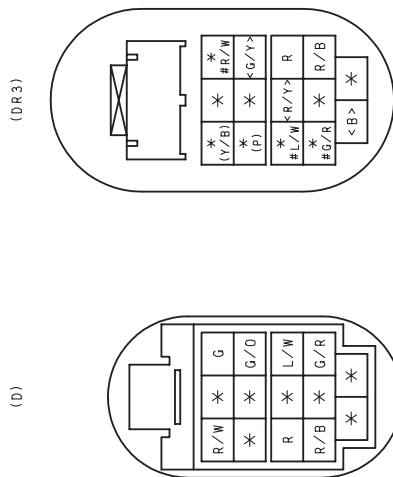

X-10 DASH (D) - DOOR No. 4 (DR4)

() ... 5HB
 # ... WITH POWER WINDOW SYSTEM
 < > ... NOT USED

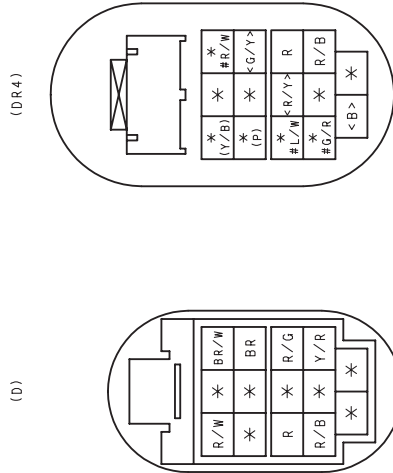

X-11 REAR No. 2 (R2) - INTERIOR LIGHT (1IN)

... NOT USED

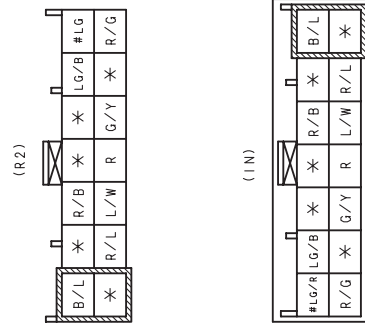

MAIN FUSE BLOCK

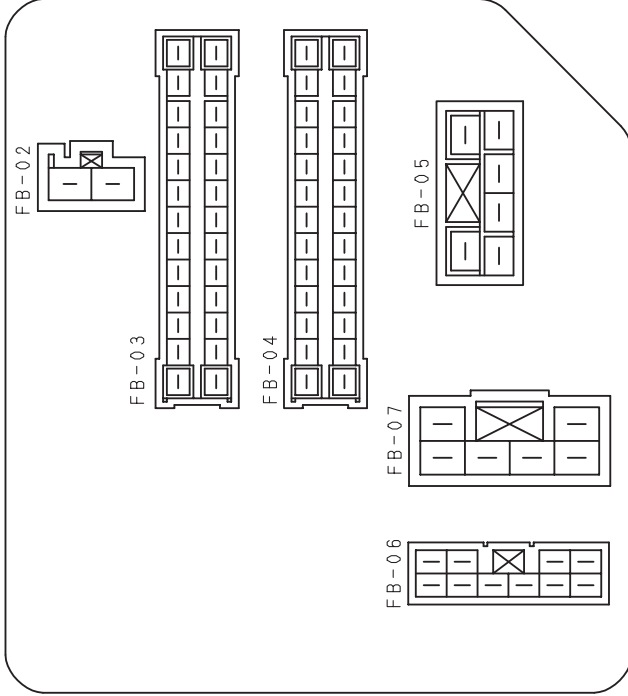
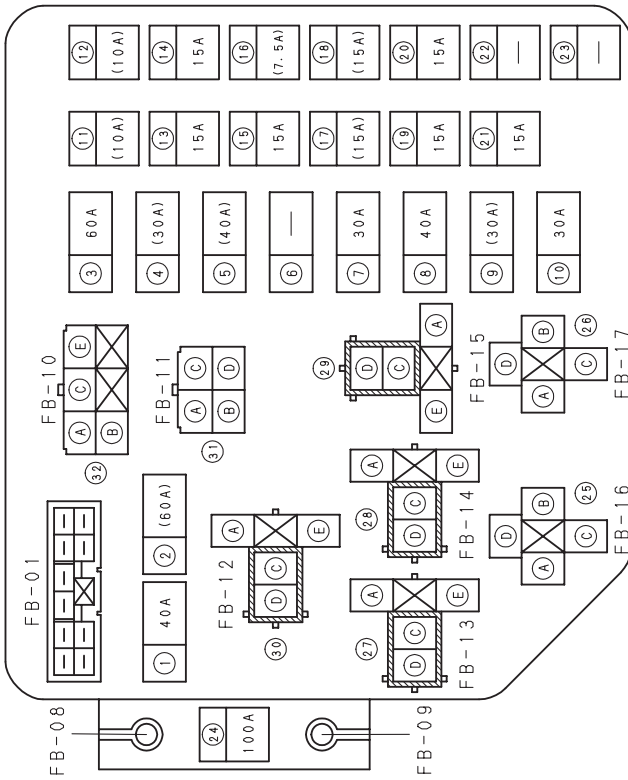

No.	CIRCUIT NAME	No.	CIRCUIT NAME
1	HEATER	13	HORN
2	(ABS)	14	HAZARD
3	IG KEY	15	TAIL
4	(PTC)	16	(HEAD C/U)
5	(GLOW)	17	(FOG)
6	—	18	(FOG)
7	COOLING FAN	19	STOP
8	BTN	20	HEAD R
9	(AD FAN)	21	HEAD L
10	INJ OR FIP	22	—
11	(A/ZC)	23	—
12	(ST STG)	24	MAIN

No.	CIRCUIT NAME	No.	CIRCUIT NAME
25	COOLING FAN	29	HEADLIGHT (HEAD)
26	(CONDENSER FAN)	30	(A/C)
27	TNS (TAIL)	31	MAIN
28	HORN	32	FUEL PUMP (G.C.C.) (OR SPV)

FRONT

FRONT

NOTE: THIS IS THE CONNECTOR AS SEEN FROM THE TERMINAL SIDE.

() CAUTION LABEL TITLE
() EQUIPPED ONLY WITH THE RELATED SYSTEM

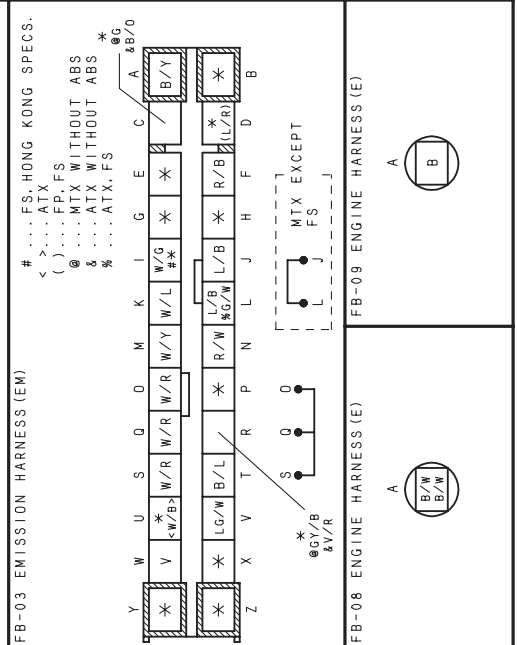
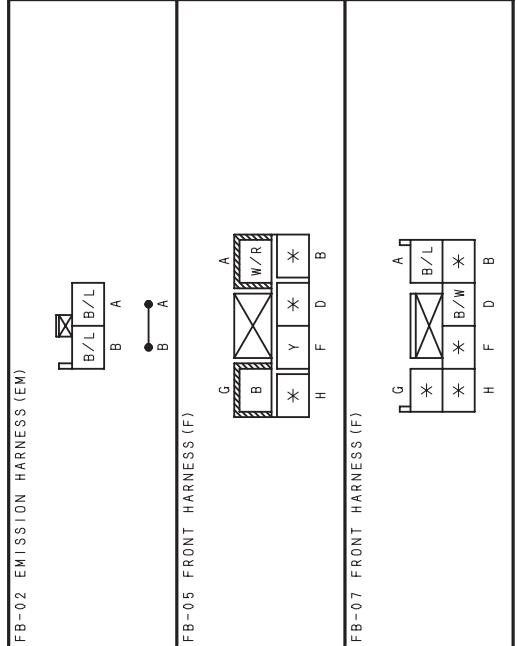
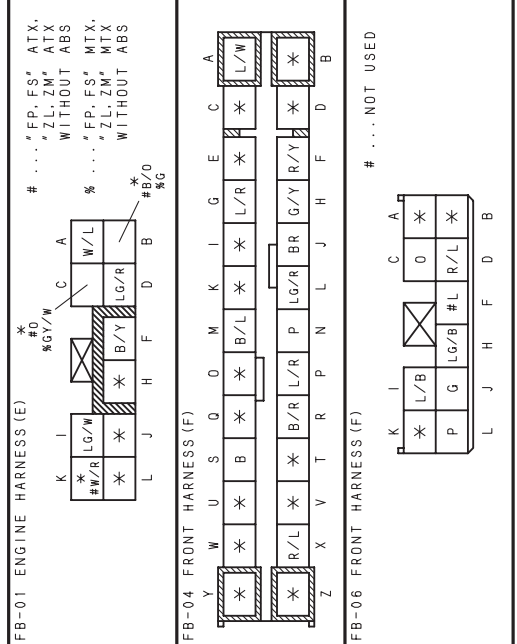

FB-01 ENGINE HARNESS (E)
FB-02 EMISSION HARNESS (EM)
FB-03 EMISSION HARNESS (EM)

... FS, HONG KONG SPECS.
< > ... ATX
() ... FP, FS
@ ... MTX WITHOUT ABS
& ... ATX WITHOUT ABS
% ... ATX, FS
* ... #G/O

FB-04 FRONT HARNESS (F)
FB-05 FRONT HARNESS (F)
FB-06 FRONT HARNESS (F)
FB-07 FRONT HARNESS (F)
FB-08 ENGINE HARNESS (E)
FB-09 ENGINE HARNESS (E)

... NOT USED

() CAUTION LABEL TITLE
() EQUIPPED ONLY WITH THE RELATED SYSTEM