

TECHNICAL DATA

0

1

THREADED CONNECTIONS

2

FLUIDS, OIL AND LUBRICANTS

3

MAINTENANCE SCHEDULE

4

EXPLANATORY NOTES ON THE MAINTENANCE ACTIVITIES

5

MAINTENANCE SCHEDULE

Maintenance activities

CF65/65 (II) series

2.2 OVERVIEW OF ANNUAL MAINTENANCE ACTIVITIES

ANNUAL MAINTENANCE ACTIVITIES (Y-SERVICE)

"Correct, if necessary, after inspection"

CAB AND ELECTRICAL SYSTEM

- ☐ Check pedal rubbers
- ☐ Check whether the latest version of the ITS manual is kept in the cab
- ☐ Replace interior filter element
- ☐ Check fluid level of cab tilting pump
- ☐ Check cab fastening

ENGINE, COOLING SYSTEM AND FUEL SYSTEM

- ☐ Replace air filter element
- ☐ Check air inlet dust trapping valve
- ☐ Check/adjust valve clearance - **see Note 4** Done ☐ Yes ☐ No
- ☐ Check coolant freezing point
- ☐ Change coolant - **see Note 1** Changed ☐ Yes ☐ No
- ☐ Change fuel fine filter

STEERING GEAR AND BRAKE SYSTEM

- ☐ Replace steering gear filter element - **see Note 5** Replaced ☐ Yes ☐ No
- ☐ Check steering ball joints
- ☐ Replace air dryer filter element
- ☐ Check compressor line - **See Note 6**
- ☐ Check brake cylinder fastening
- ☐ Check/adjust load-dependent control valve
- ☐ Check fastening of universal joint to steering box input shaft

DRIVE AND CHASSIS

- ☐ Change differential oil - **See Note 2** Changed ☐ Yes ☐ No
- ☐ Check operation of differential lock
- ☐ Check drive shaft play
- ☐ Change gearbox oil - **see Note 3** Changed ☐ Yes ☐ No
- ☐ Check trailer coupling
- ☐ Check superstructure attachment

OTHER ACTIVITIES

- ☐ Check whether there are any field actions that still need to be performed on the vehicle

3.2 CHECKING THE BATTERY FLUID LEVEL



Avoid sparks and open flames in the vicinity of batteries.

Battery acid is an aggressive fluid.

In the event of contact with the skin: rinse the skin with plenty of water for a sustained period. If redness or pain persists, consult a doctor. Remove any clothing affected and rinse with water.

In the event of contact with the eyes: rinse with plenty of water for at least 15 minutes and consult a doctor.

If swallowed: do NOT induce vomiting. Rinse the mouth, drink two glasses of water and consult a doctor.

In the event of inhalation: get fresh air, rest and consult a doctor.

5

1. Check the electrolyte level. The electrolyte level must be approx. 10 mm above the plates or up to the level indicator if available.
2. If necessary, top up the batteries, see chapter "Draining and filling".

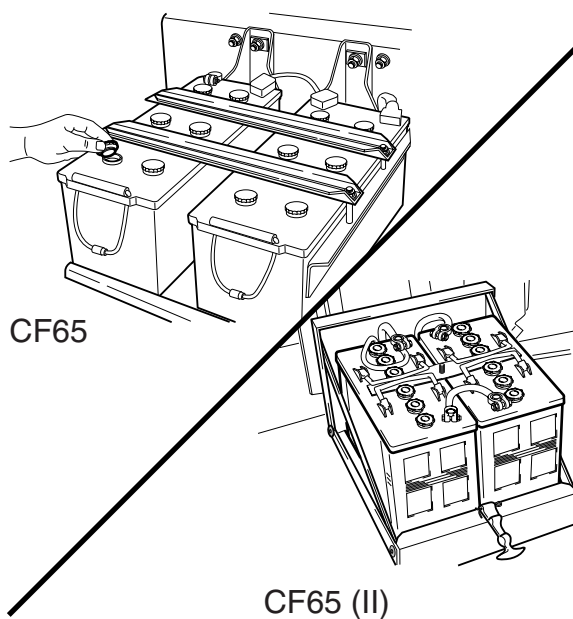

G000380-2

3.3 CHECKING THE BATTERY TERMINALS

1. Visually check the battery terminals for corrosion. Clean the battery terminals if necessary, see chapter on "Cleaning".
2. Check the attachment of the battery terminals.

3.4 CHECKING THE FLUID LEVEL OF THE CAB TILTING PUMP

1. The fluid level must be checked when the cab is in the driving position.
2. The cock (2) should be in the "tilting back" position (anti-clockwise).
3. Unscrew the filler plug (1) 3 to 4 turns. Wait until the overpressure, if any, has left the reservoir. Remove filler plug (1).
4. Start pumping (maximum 5 pump strokes). Ensure that the pump lever is in the lowest position.
5. Check the fluid level. This level should be no more than 2 cm below the top of the filling opening. Top up if necessary.
6. Fit the filler plug (1) and hand tighten it.

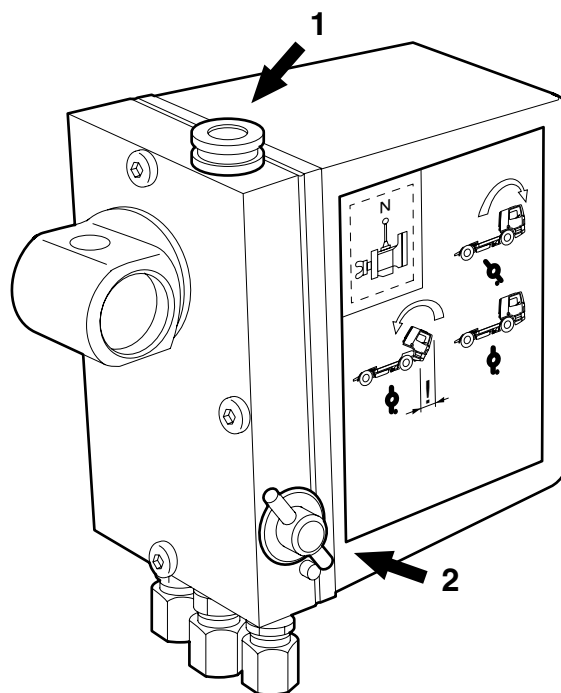

M201062

3.5 CHECK CAB FASTENING

1. Check that all attachment bolts are in place.
2. Visually inspect the attachment of the cab to the tilting mechanism.
3. Visually inspect the seals and condition of the tilting mechanism.

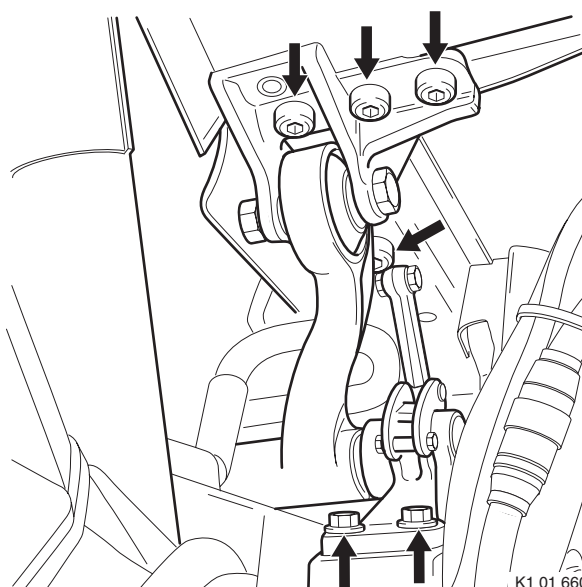

3.21 INSPECTING THE COMPRESSOR LINE



Remain at a safe distance from rotating and/or moving components.

Note:

If excessive values are measured, the inside of the air-dryer housing and the silencer on the vent should first be cleaned. Then repeat the inspection.

1. Bring the engine up to operating temperature.
2. Build up pressure in the brake system (pressure regulator must cut out).
3. When the engine is not running, remove the safety valve from the compressor line and replace it with a test nipple.
4. Connect a pressure gauge (measuring range 0-16 bar) to the test nipple.
5. Start the engine and run it at maximum engine speed.
6. If the **pressure regulator has switched off** (cut-off pressure reached, air dryer blown off) the pressure gauge must show a pressure lower than 2 bar; if the measured pressure is higher than the specified reading, the compressor line must be replaced.

Note:

If the pressure measured is too high, this indicates that there are excessive carbon deposits in the compressor line. The cause could be poor condition of the compressor (oil consumption).

7. Run the engine at idling speed.
8. Bleed the brake system until the cut-in pressure of the pressure regulator has been reached and switch off the engine. The indicator on the pressure gauge should not drop rapidly. If necessary, check the system for leaks. Pay special attention to the compressor line and the compressor.
9. Fit the safety valve.

EXPLANATORY NOTES ON THE MAINTENANCE ACTIVITIES

Inspection and adjustment

CF65/65 (II) series

Checking oil level with selector keypad

1. Apply the parking brake, put the gearbox in neutral and bring the gearbox to operating temperature (approx. 71°C - 93°C).
2. Run the engine at idling speed for 2 minutes.
3. Press both arrow keys on the selector keypad simultaneously. The display now shows the letters **O** and **L**.

Note:

O and **L** stand for **Oil Level**.

4. When the oil level is correct, the letters **O - K** appear on the display.
When the oil level is too high, this is indicated by **HI** followed by the number of litres in excess.

When the oil level is too low, this is indicated by **LO** followed by the number of litres lacking.

For example:

LO-02 means that two litres have to be added.

HI-03 means that three litres have to be drained.

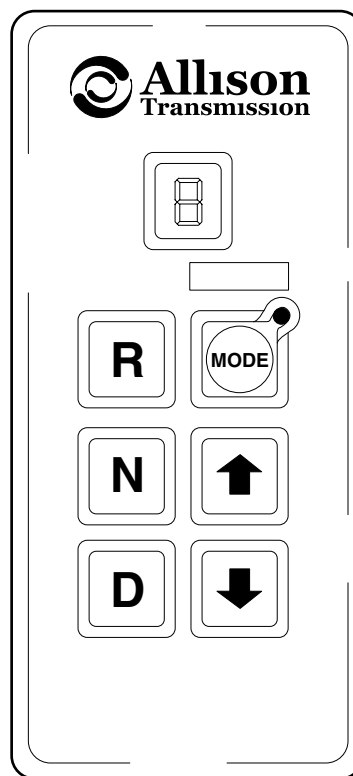

V300392

3.36 CHECKING THE GREASED WHEEL HUBS FOR LEAKS

1. Check the wheel hubs for leaks.

Note:

If there are serious grease marks on the brake disc side of the wheel hub, this could indicate excessive use of assembly grease on new or recently assembled wheel hubs.

On wheel hubs that have not been assembled recently, serious grease marks could indicate a leak in the seal (1). This means that the entire hub unit must be replaced.

Serious oil leakage on the driven rear axle hubs could indicate that the O-ring (2) is not sealing correctly.

If there is an oil leak the hub unit should be dismantled to remedy the problem.

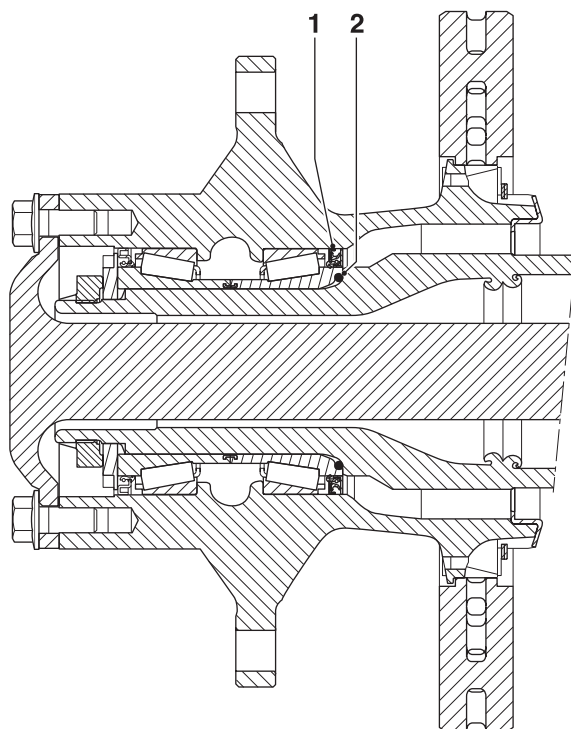

G0 00 271

4. REMOVAL AND INSTALLATION

4.1 REMOVAL AND INSTALLATION, INTERIOR FILTER ELEMENT

Removing interior filter

1. Open the grille.
2. Push the locknut on the filter casing to one side and remove the filter element.

Fitting interior filter

1. Fit the filter element.
2. Push the filter element into the locknut on the filter casing.
3. Close the grille.

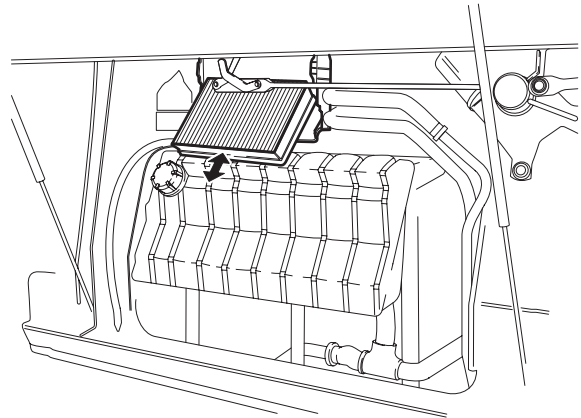
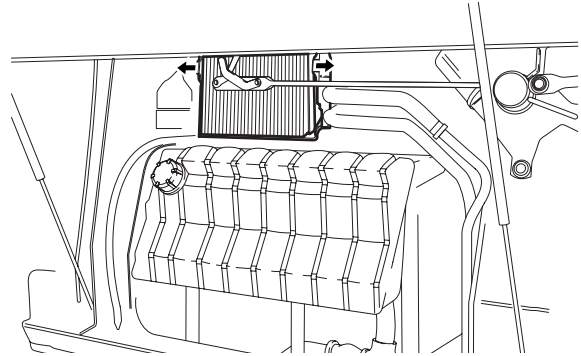

K1 01 033

EXPLANATORY NOTES ON THE MAINTENANCE ACTIVITIES

Removal and installation

CF65/65 (II) series

4.2 REMOVAL AND INSTALLATION, AIR FILTER ELEMENT

Removing the air filter element

1. Loosen all the clamping brackets (1) of the air filter cover (2).
2. Remove the air filter cover (2).
3. Remove the air filter element (3).
4. Clean the inside of the air filter housing and the air filter cover.

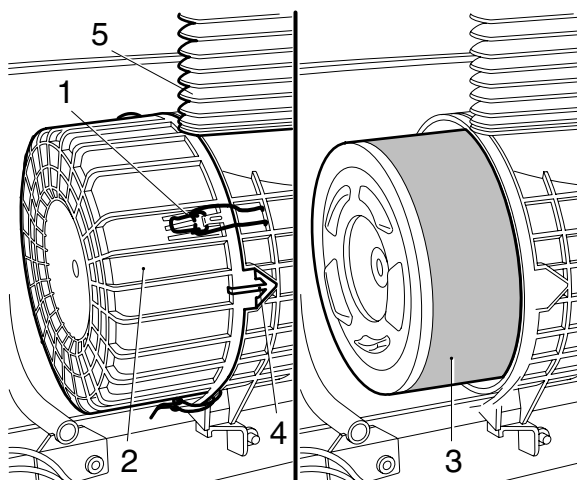

i400443

5. When replacing the air filter element, reset the air filter indicator, if fitted, by pressing the button on the indicator.

Installing the air filter element

Note:

Only fit an original DAF fire retardant air filter element.

The side of the fire retardant air filter element contains the text "FIRE RETARDANT".

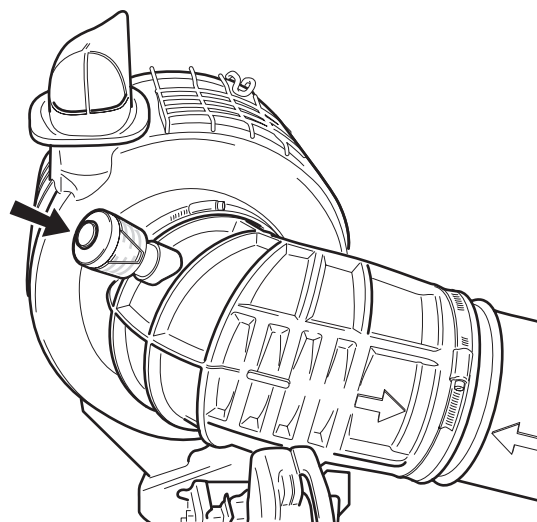

i400869

EXPLANATORY NOTES ON THE MAINTENANCE ACTIVITIES

CF65/65 (II) series

Removal and installation

1. Fit the air filter element (3) in the air filter housing.
2. Fit the air filter cover. Note the arrow (4) on the air filter cover (2).
3. Fit all the clamping brackets (1).
4. Check that the flexible sealing bellows (5) on the air intake is not damaged. Replace if necessary.

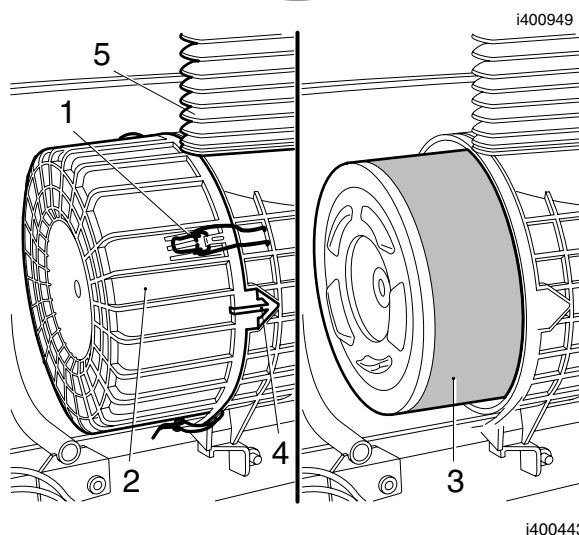
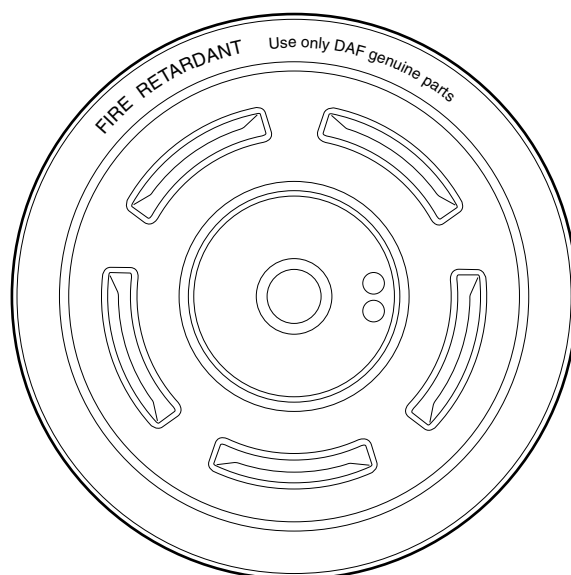

5

EXPLANATORY NOTES ON THE MAINTENANCE ACTIVITIES

CF65/65 (II) series

Removal and installation

5. Using a water-resistant felt pen, write on the sticker the latest date by which the dryer element must be replaced (not later than 1 year after the date of fitting).

| |
|---------------------------------|
| Artikelnummer |
| Reference |
| Teilenummer |
| Référence |
| 1391510 |
| Eerstvolgende vervanging |
| Next change |
| Nächster Wechsel |
| Prochain remplacement |
| |
| DAF |

R600523

5

EXPLANATORY NOTES ON THE MAINTENANCE ACTIVITIES

Removal and installation

CF65/65 (II) series

4.9 REMOVAL AND INSTALLATION, AUTOMATIC GEARBOX OIL FILTERS



To prevent skin injury, avoid unnecessary contact with the drained oil.

Removing automatic gearbox oil filters

1. Remove the attachment bolts from the filter covers (2) and remove the filter covers. Collect any oil that is flowing out.
2. Remove the oil filters from the oil sump.
3. Remove the various O-rings from the filter covers.
4. If a gasket is used, remove the any pieces of the gasket left on the filter covers and the contact surfaces.

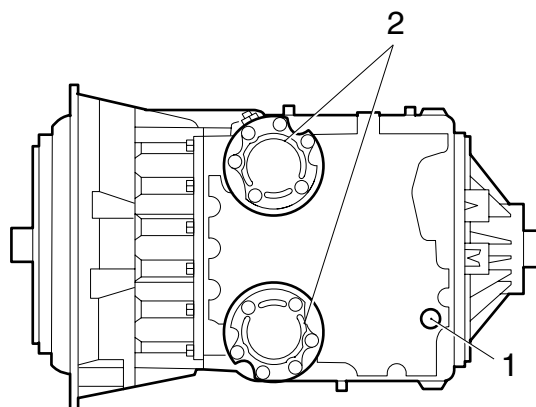

V300371

Fitting automatic gearbox oil filters

1. Lightly lubricate the new O-rings with clean gearbox oil and fit the various O-rings to the filter covers.

Note:

Compare the new O-rings to the old O-rings to ensure that the correct O-rings are used.

2. If a gasket is used, fit a new gasket to the filter cover.
3. Lightly lubricate the rubber inner ring of the oil filters with clean gearbox oil and fit the oil filters to the filter covers.
4. Fit the filter covers together with the oil filters to the gearbox and tighten the attachment bolts to the specified torque, see main group "Technical data".
5. Check the oil level, see chapter "Inspection and adjustment".

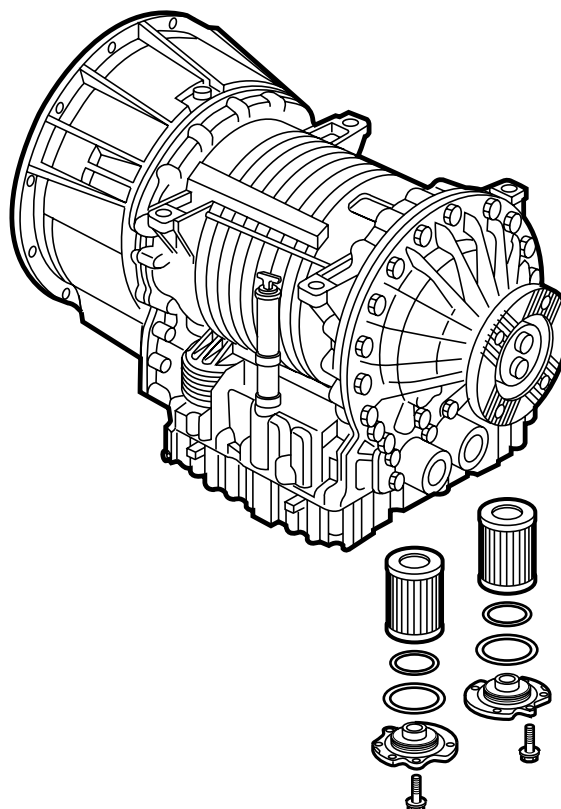

W 3 03 103

5. DRAINING AND FILLING

5.1 TOPPING UP BATTERY FLUID



Avoid sparks and open flames in the vicinity of batteries.

Battery acid is an aggressive fluid. In the event of contact with the skin: rinse the skin with plenty of water for a sustained period. If redness or pain persists, consult a doctor. Remove any clothing affected and rinse with water.

In the event of contact with the eyes: rinse with plenty of water for at least 15 minutes and consult a doctor.

If swallowed: do NOT induce vomiting. Rinse the mouth, drink two glasses of water and consult a doctor.

In the event of inhalation: get fresh air, rest and consult a doctor.

Topping up battery fluid

1. Clean the top of the battery. If the top of the battery has acid on it, it should be rinsed with water.
2. Remove the plugs and top up the batteries with distilled water to approximately 10 mm above the plates or up to the "max" indicator level.

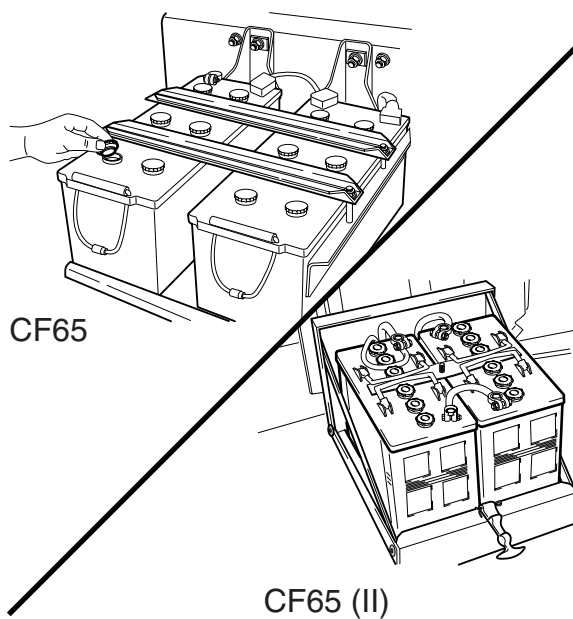

G000380-2

EXPLANATORY NOTES ON THE MAINTENANCE ACTIVITIES

Draining and filling

CF65/65 (II) series

5.2 DRAINING AND FILLING, ENGINE OIL



To prevent skin injury, avoid unnecessary contact with the drained oil.

Draining engine oil

1. Ensure that the vehicle is standing on a flat and level surface.
2. Drain the engine oil at operating temperature via the drain plug in the oil sump.
3. Replace the drain plug sealing ring and tighten the drain plug to the specified torque; see "Technical data".

Filling, engine oil

1. Fill the engine through the oil filler pipe (1) with the specified quantity of engine oil; see "Technical data".
2. Check the engine oil level; see "Inspection and adjustment".

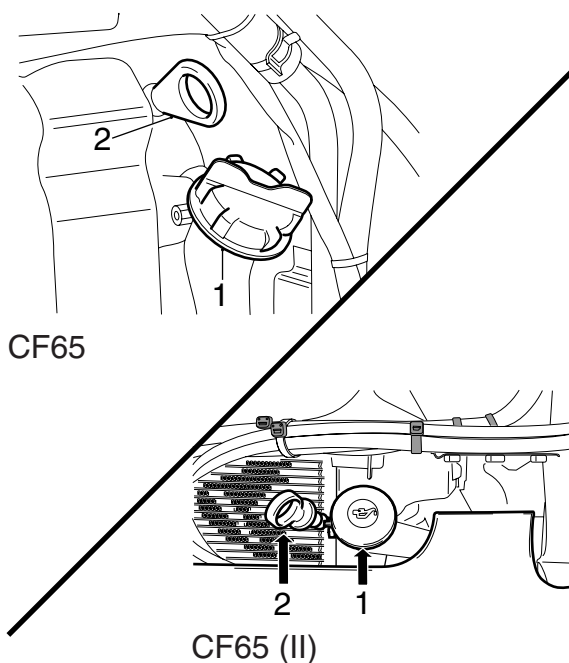

G000377-2